



Connells

Ansty Road
Coventry



Property Description

A well-presented three-bedroom double bayed mid-terrace property, situated in the popular residential area of Wyken, offering well-proportioned accommodation ideal for families or first-time buyers.

The ground floor comprises a welcoming lounge featuring a bay window to the front, allowing plenty of natural light, alongside a fitted galley style kitchen and a pleasant conservatory overlooking the rear garden. To the first floor, there are three bedrooms and a fitted shower room.

Externally, the property benefits from a driveway to the front providing off-road parking. To the rear, there is a private garden, along with the added advantage of a garage.

Early viewing is highly recommended to fully appreciate the accommodation on offer.

Approach

Double glazed door to;

Porch

Single glazed internal door to;

Entrance Hall

Stairs to first floor, cupboard, radiator and laminate flooring.

Through Lounge/Dining Room

Double glazed bay window to the front elevation, laminate flooring and sliding doors to conservatory.

Conservatory

Double glazed windows and double glazed door opening onto the rear garden.

Fitted Kitchen

Range of wall and base mounted units incorporating an inset one and a half bowl single drainer stainless steel sink unit with work surfaces and tiled splashbacks over. Integrated electric oven and gas hob with cookerhood over, plumbing for automatic washing machine, space for domestic appliance, double glazed window to the rear elevation.

First Floor Landing

Doors to;

Bedroom One

Double glazed bay window to the front elevation, built-in wardrobes and radiator.

Bedroom Two

Double glazed window to the rear elevation and radiator.

Bedroom Three

Double glazed window to the front elevation and radiator.

Fitted Shower Room

Tiled, comprising shower cubicle, wash hand basin, toilet, heated towel rail and double glazed window to the rear elevation.

Outside

Front Of Property

Driveway providing off road parking.

Rear Garden

Patio area beyond being laid to lawn with borders, an outside w/c and gated rear access.

Garage

Up & over door.



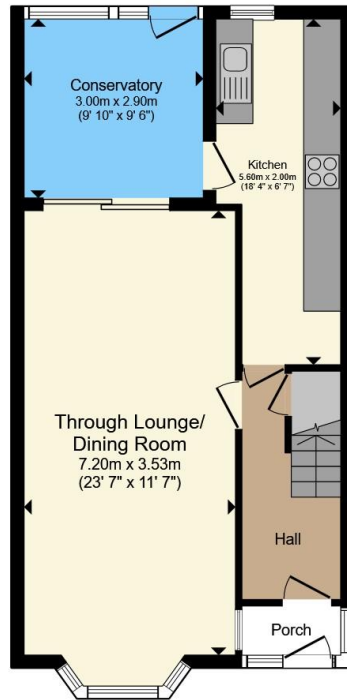

Ground Floor

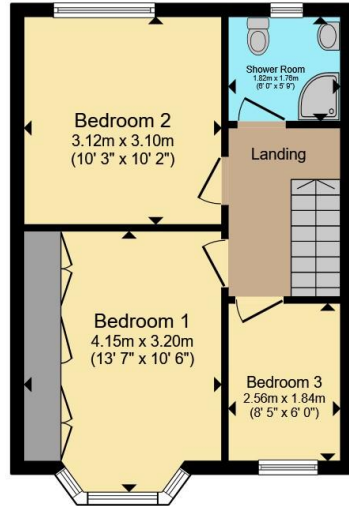

First Floor

Total floor area 89.7 m² (965 sq.ft.) approx

This floor plan is for illustrative purposes only. It is not drawn to scale. Any measurements, floor areas (including any total floor area), openings and orientation are approximate. No details are guaranteed, they cannot be relied upon for any purpose and they do not form part of any agreement. No liability is taken for any error, omission or misstatement. A party must rely upon its own inspection(s). Powered by www.propertybox.io

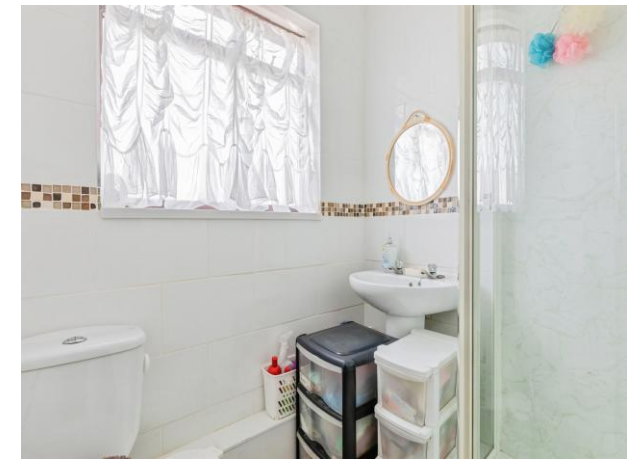

To view this property please contact Connells on

T 02476 553 093
E coventry@connells.co.uk

38 New Union Street
 COVENTRY CV1 2HN

EPC Rating: G Council Tax
 Band: B

view this property online connells.co.uk/Property/COV324076

Tenure: Freehold



1. MONEY LAUNDERING REGULATIONS Intending purchasers will be asked to produce identification documentation at a later stage and we would ask for your co-operation in order that there will be no delay in agreeing the sale. 2. These particulars do not constitute part or all of an offer or contract. 3. The measurements indicated are supplied for guidance only and as such must be considered incorrect. Potential buyers are advised to recheck measurements before committing to any expense. 4. We have not tested any apparatus, equipment, fixtures, fittings or services and it is in the buyers interest to check the working condition of any appliances.

Connells Residential is registered in England and Wales under company number 1489613, Registered Office is Cumbria House, 16-20 Hockliffe Street, Leighton Buzzard, Bedfordshire, LU7 1GN. VAT Registration Number is 500 2481 05.

See all our properties at www.connells.co.uk | www.rightmove.co.uk | www.zoopla.co.uk

Property Ref: COV324076 - 0002