



## Greenwood Street

£240,000

- IDEAL FIRST TIME BUY
- CLOSE TO TRANSPORT LINKS: BUS ROUTES, BARRY DOCKS TRAIN STATION, LINKS TO M4 CORRIDOR
- 2 DOUBLE BEDROOMS & LOFT ROOM
- DOUBLE GARAGE TO REAR
- BEAUTIFULLY PRESENTED THROUGHOUT
- EPC Rating: Awaited



 2  1  2



## About the property

Beautifully renovated throughout, this impressive two-bedroom mid-terrace home features a loft room, stunning open-plan kitchen/living space, enclosed rear garden and a double garage with power and lighting, all conveniently located close to local shops, schools and transport links.

## Accommodation

### Lounge/Dining Room

13' 6" x 9' 1" ( 4.11m x 2.77m )

LVT wood effect flooring, window to front, open fireplace, double doors leading into open plan living/kitchen area.

### Lounge

13' 6" x 12' 8" ( 4.11m x 3.86m )

LVT wood effect flooring, log burner (approx. 5 months old), stairs leading to first floor landing.

### Kitchen

8' 9" x 8' 4" ( 2.67m x 2.54m )

Wren fitted kitchen with solid oak worktops and integrated appliances: fridge/freezer, oven and grill, microwave and wine cooler.



### Utility Room

Lean to utility room with space for washing machine and access to rear garden.

### Landing

### Bathroom

Recently renovated bathroom with walk in shower, w/c, sink. Built in cupboard housing boiler (approx. 5 months old), mirrored storage units to remain.

### Bedroom 1

11' 3" x 9' 2" ( 3.43m x 2.79m )

LVT wood effect flooring, fitted wardrobes, windows to front.

### Bedroom 2

11' 3" x 10' 6" ( 3.43m x 3.20m )

LVT wood effect flooring, window to rear, stairs leading to loft room.

### Loft Room

Skylight windows to front and rear, built in bed, storage cupboards in the eaves.

### To Rear

### Rear Garden

Enclosed rear garden with seating area, outside WC with sink, outside tap and shower, access to double garage. \*Please be aware not all potted plants will remain\*.

### Double Garage

Up and over door leading to rear lane, electric and lighting.

01446 733224

barry@peteralan.co.uk

## Floorplan

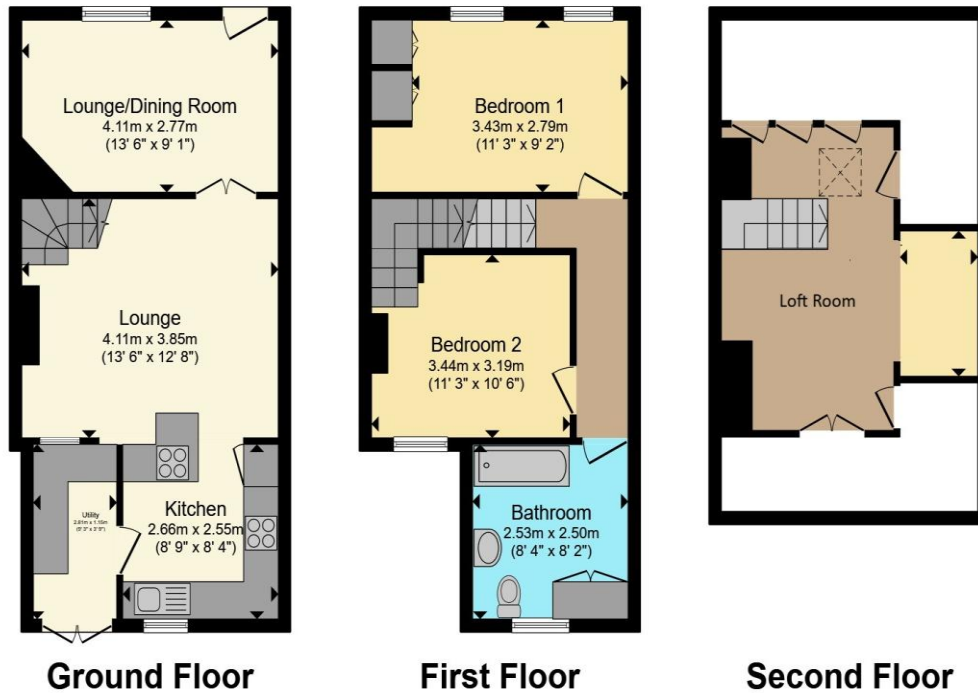

Total floor area 98.9 m<sup>2</sup> (1,064 sq.ft.) approx

This floor plan is for illustrative purposes only. It is not drawn to scale. Any measurements, floor areas (including any total floor area), openings and orientation are approximate. No details are guaranteed, they cannot be relied upon for any purpose and they do not form part of any agreement. No liability is taken for any error, omission or misstatement. A party must rely upon its own inspection(s). Powered by [www.propertybox.io](http://www.propertybox.io)

## Important Information

Note while we endeavour to make our sales details accurate and reliable, if there is any point which is of particular interest to you, please contact the office and we will be pleased to confirm the position for you. We have not personally tested any apparatus, equipment, fixtures, fittings or services and cannot verify they are in working order or fit for their purposes. Nothing in these particulars is intended to indicate that carpets or curtains, furnishings or fittings, electrical goods (whether wired or not). Gas fires or light fittings or any other fixtures not expressly included form part of the property offered for sale. This computer generated Floorplan, if applicable, is intended as a general guide to the layout and design of the property. It is not to scale and should not be relied upon for dimensions. Tenure: We cannot confirm the tenure of the property as we have not had access to the legal documents. The buyer is advised to obtain verification from their solicitor or surveyor.

Peter Alan Limited is registered in England and Wales under company number 2073153, Registered Office is Cumbria House, 16-20 Hockliffe Street, Leighton Buzzard, Bedfordshire, LU7 1GN. VAT Registration Number is 500 2481 05. For activities relating to regulated mortgages and non-investment insurance contracts, Peter Alan Limited is an appointed representative of Connells Limited which is authorised and regulated by the Financial Conduct Authority. Connells Limited's Financial Services Register number is 302221. Most buy-to-let