



Connells

Warton Green
Luton



Property Description

Situated in the highly sought-after Stopsley area, this well-presented two-bedroom mid-terrace home offers an excellent opportunity for first-time buyers, downsizers, or investors alike.

The accommodation comprises a welcoming entrance porch leading into a fitted kitchen, with a bright and spacious lounge located to the rear of the property, benefiting from direct access to the private rear garden. Upstairs, there are two bedrooms, including a generous principal bedroom, alongside a family bathroom.

Externally, the property enjoys the advantages of a private rear garden, ideal for relaxing or entertaining, together with parking.

Warton Green is conveniently located within easy reach of local shops, schools, amenities and transport links, including Luton Airport Parkway, the M1 motorway and London Luton Airport, making it an ideal choice for commuters. Viewing is highly recommended to fully appreciate all that this property has to offer.









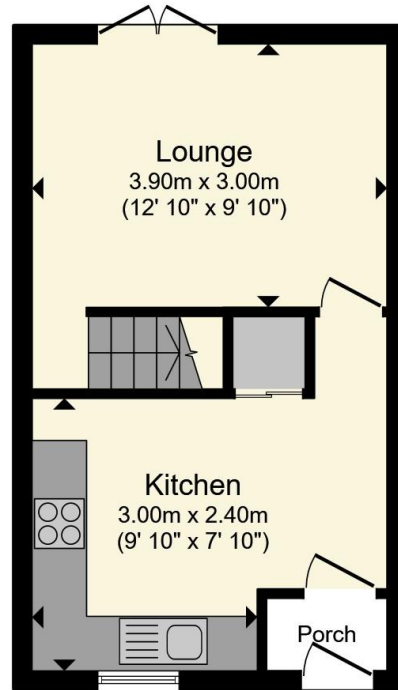

Ground Floor

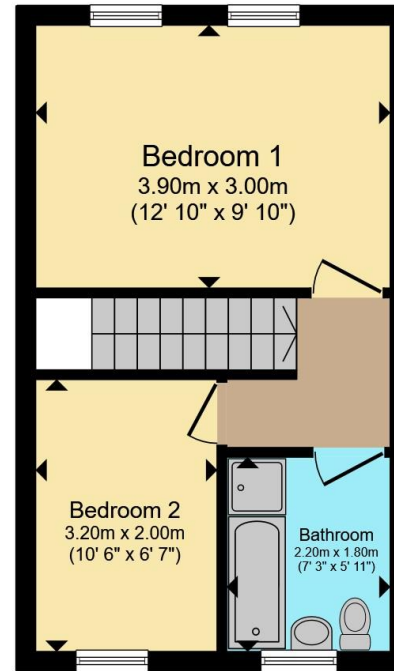

First Floor

Total floor area 52.6 m² (566 sq.ft.) approx

This floor plan is for illustrative purposes only. It is not drawn to scale. Any measurements, floor areas (including any total floor area), openings and orientation are approximate. No details are guaranteed, they cannot be relied upon for any purpose and they do not form part of any agreement. No liability is taken for any error, omission or misstatement. A party must rely upon its own inspection(s). Powered by www.propertybox.io



To view this property please contact Connells on

T 01582 737 069
E stopsley@connells.co.uk

Jansel House Parade 656 Hitchin Road Stopsley
 LUTON LU2 7XH

EPC Rating: Council Tax
 Awaited Band: C

Tenure: Freehold

view this property online connells.co.uk/Property/STP308262



1. MONEY LAUNDERING REGULATIONS Intending purchasers will be asked to produce identification documentation at a later stage and we would ask for your co-operation in order that there will be no delay in agreeing the sale. 2. These particulars do not constitute part or all of an offer or contract. 3. The measurements indicated are supplied for guidance only and as such must be considered incorrect. Potential buyers are advised to recheck measurements before committing to any expense. 4. We have not tested any apparatus, equipment, fixtures, fittings or services and it is in the buyers interest to check the working condition of any appliances.

Connells Residential is registered in England and Wales under company number 1489613, Registered Office is Cumbria House, 16-20 Hockliffe Street, Leighton Buzzard, Bedfordshire, LU7 1GN. VAT Registration Number is 500 2481 05.

See all our properties at www.connells.co.uk | www.rightmove.co.uk | www.zoopla.co.uk

Property Ref: STP308262 - 0003