



Nottingham Road
Hucknall NOTTINGHAM

burchell
edwards



Property Description

This charming semi-detached cottage offers plenty of space and room for all the family, both inside and out.

To the ground floor there is snug which has beamed ceiling and decorative fireplace offering a cosy and welcoming feeling which leads to a spacious dining kitchen which has been refitted with hand made units to give a real cottage vibe, there is also a spacious lounge diner with feature open fireplace (which is regularly used) plus a rear lobby which leads out to the rear garden and refitted downstairs shower room.

On the first floor there are three generously sized bedrooms, one of which has characterful beams along with modern four-piece bathroom suite. There is also an additional bedroom on the second floor.

Being set on a generous corner plot the property has gardens to the front side and rear which also offers scope for extension or further additional parking whilst the enclosed rear garden has a generous paved patio area, detached storage garage, greenhouse garden shed and a detached office suite perfect for any home worker.

This property must be viewed to fully appreciate the size and quality of home on offer

Snug

Entered into via UPVC front door with stairs off to the first floor, decorative cast iron fireplace, feature beams, central heating radiator, UPVC windows to the front elevation with fitted shutters and access to the dining kitchen.

Lounge/ Diner

This dual aspect room has UPVC windows to the front and side elevations with built in shutters, feature open fireplace, built-in understairs storage cupboard with fitted shelving, two central heating radiators and door to rear lobby.

Dining Kitchen

Having a comprehensive range of handmade wall, base and drawer units with complimentary quartz work surfaces over, inset one and a half bowl sink and drainer, integrated wine rack, space and plumbing for washing machine and dishwasher, range cooker with extractor hood over, tiled flooring, two UPVC windows to the rear elevation, central heating boiler located in larder unit, recess spot lights and door to rear lobby.

Rear Lobby

Having tiled flooring and UPVC door leading out to the rear garden.

Downstairs Shower Room

Having a three-piece suite comprising of a shower cubicle with mains fed shower, low level W.C and vanity wash hand basin, tiled splashbacks, central heating radiator and extractor fan.

First Floor Landing

Having central heating radiator and stairs off to the second floor.

Bedroom One

Having UPVC windows to the front and side elevations, decorative cast iron fireplace, built-in over stairs storage cupboard and central heating radiator.

Bedroom Two

Having feature beams, laminate flooring, UPVC window to the front elevation and wall lights.

Bedroom Three

Having UPVC window to the rear elevation and central heating radiator

Bathroom

Having a four-piece suite comprising of free-standing bath, separate shower cubicle with mains fed double head shower, low level W.C, and pedestal wash hand basin, tiled flooring and tiled splashbacks, UPVC obscured window to the rear elevation and central heating radiator.

Second Floor

Bedroom Four

Having velux window to the rear and central heating radiator

Outside

Set on a generous garden plot with gardens to the front, side and rear. The property offers lots of potential for further parking or extension (subject to planning permissions).

To the front of the property is a generous gravelled driveway providing ample off road parking for several vehicles plus additional lawn area. There are also double gates leading to the rear and providing access to the storage garage.

The enclosed rear garden is mainly laid to lawn with generous paved patio area, planted beds, outside tap, garden shed, green house and fenced boundaries.

Garden Room/ Office

Having power, lighting and UPVC double opening French doors over looking the garden.

Storage Garage

A detached garage having power and light with double opening doors









Ground Floor



First Floor

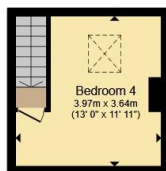

Second Floor

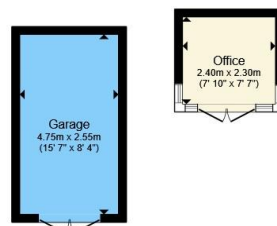

Outbuilding

Total floor area 144.6 m² (1,556 sq.ft.) approx

This floor plan is for illustrative purposes only. It is not drawn to scale. Any measurements, floor areas (including any total floor area), openings and orientation are approximate. No details are guaranteed, they cannot be relied upon for any purpose and they do not form part of any agreement. No liability is taken for any error, omission or misstatement. A party must rely upon its own inspection(s). Powered by www.propertybox.io



To view this property please contact Burchell Edwards on

T 0115 968 0528
E hucknall@burchelledwards.co.uk

64 High Street Hucknall
NOTTINGHAM NG15 7AX

EPC Rating: E Council Tax
Band: B

Tenure: Freehold

check out more properties at burchelledwards.co.uk



1. MONEY LAUNDERING REGULATIONS Intending purchasers will be asked to produce identification documentation at a later stage and we would ask for your co-operation in order that there will be no delay in agreeing the sale. 2. These particulars do not constitute part or all of an offer or contract. 3. The measurements indicated are supplied for guidance only and as such must be considered incorrect. Potential buyers are advised to recheck measurements before committing to any expense. 4. We have not tested any apparatus, equipment, fixtures, fittings or services and it is in the buyers interest to check the working condition of any appliances.

Burchell Edwards is a trading name of Connells Residential which is registered in England and Wales under company number 1489613, Registered Office is Cumbria House, 16-20 Hockliffe Street, Leighton Buzzard, Bedfordshire, LU7 1GN. VAT Registration Number is 500 2481 05.

See all our properties at www.burchelledwards.co.uk | www.rightmove.co.uk | www.zoopla.co.uk

Property Ref: HUK104266 - 0002