



Bartholomew Close, Great Chesterford Saffron Walden £435,000 **Freehold**



Key Features



- 3 Bedrooms
- Detached
- Garage
- Refurbished throughout
- Air conditioning

Thoughtfully updated to create a stylish and welcoming property, ideal for modern family living, the heart of the home is the impressive open-plan lounge/dining area, offering generous and versatile living space, perfect for both everyday family life and entertaining guests. Complementing this is a newly fitted contemporary kitchen, finished to a high standard with a range of modern units and integrated appliances. A convenient downstairs WC/Utility room which is currently fitted with a washing machine and separate tumble dryer completes the ground floor accommodation. Upstairs, the property offers well-proportioned bedrooms and a family bathroom, providing comfortable



accommodation for a growing family or those looking to downsize without compromise.

Outside, the property benefits from an attractive enclosed rear garden, offering an excellent space for relaxing and al fresco dining during the warmer months. Further advantages include a garage and private driveway providing off-road parking.

Having undergone extensive refurbishment throughout, this superb home is presented in excellent decorative order and is ready for its next owners to move straight in and enjoy.

Located in the ever-popular village of Great Chesterford, which is arguably one of the most picturesque and popular villages in the area. It has its own shop, pubs/ restaurants, medical centre, hotel, highly regarded primary school, railway station with trains to Cambridge and Liverpool Street and a recreation ground with an outstanding village hall. The fine old market town of Saffron Walden is only 4 miles to the south, with the university city of Cambridge to the north and the M11 access point is within one mile.

Front Door



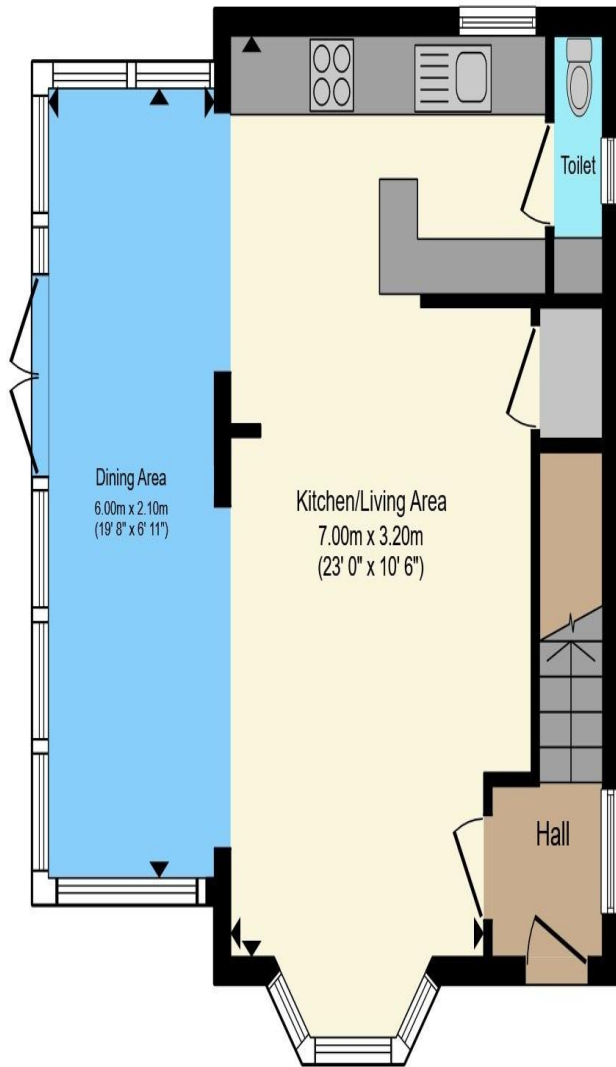

Ground Floor

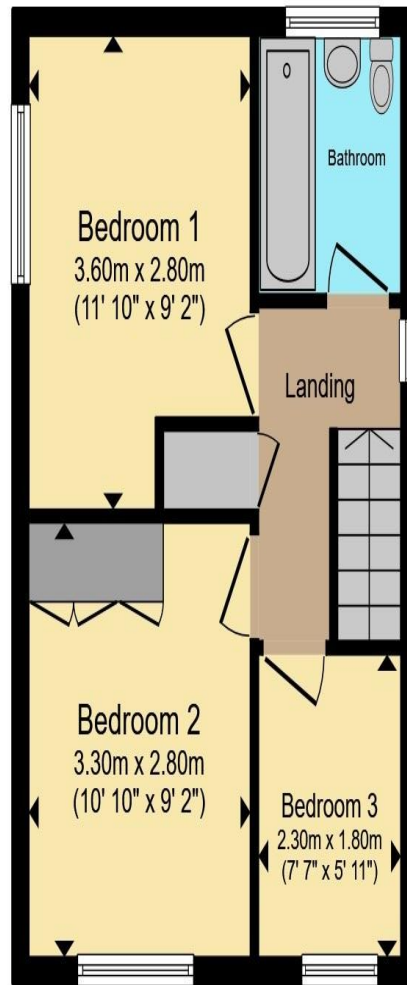

First Floor

Total floor area 80.5 sq.m. (867 sq.ft.) approx

This floor plan is for illustrative purposes only. It is not drawn to scale. Any measurements, floor areas (including any total floor area), openings and orientation are approximate. No details are guaranteed, they cannot be relied upon for any purpose and they do not form part of any agreement. No liability is taken for any error, omission or misstatement. A party must rely upon its own inspection(s). Powered by www.propertybox.io



To:
Entrance Hall:
Stairs rising to first floor.
Door to:
Kitchen/Living Area
23' x 10'6"(max) (7.00m x 3.20m (max))

Dining Area:
19'8" x 6'11" (6m x 2.1m)

Toilet/Utility Room

On the First Floor

Landing
Airing cupboard, loft access hatch. Window to side aspect.

Bedroom 1:
11'10" (max) x 9'2" (3.6m (max) x 2.8m)

Bedroom 2:
10'10" (max) x 9'2" (3.3m (max) x 2.80m)

Bedroom 3:
7'7" x 5'11" (2.3m x 1.8m)

Bathroom

To view this property call Kevin Henry on:
01799 513632

Selling your property?

Contact us to arrange a FREE home valuation.

 01799 513632

 1 Market Street, SAFFRON WALDEN, Essex, CB10 1JB

 sales@kevinhenry.co.uk

 www.Kevinhenry.co.uk



 SCAN ME



Kevin Henry is a trading name of Sharman Quinney Holdings Limited which is registered in England and Wales under company number 4174227, Registered Office is Cumbria House, 16-20 Hockliffe Street, Leighton Buzzard, Bedfordshire, LU7 1GN. VAT Registration Number is 500 2481 05.

1: These particulars do not constitute part or all of an offer or contract. 2: The measurements indicated are supplied for guidance only and as such must be considered incorrect. 3: Potential buyers are advised to recheck the measurements before committing to any expense. 4: Kevin Henry has not tested any apparatus, equipment, fixtures, fittings or services and it is the buyers interests to check the working condition of any appliances. 5: Kevin Henry has not sought to verify the legal title of the property and buyers must obtain verification from their legal representative. 6: Intending purchasers will be asked to produce identification documentation at a later stage and we would ask your co-operation in order that there will be no delay in agreeing the sale. Ref: SAF104018 - 0002

