

for sale

£245,000



## Snowdrop Wynde Shaftesbury SP7 8GX

A well-presented three-bedroom semi-detached home in Shaftesbury, featuring a lounge, spacious kitchen/diner with French doors to the enclosed rear garden, downstairs WC, three bedrooms, en-suite to the main bedroom, and driveway parking for two vehicles. Side access to the rear garden.



# Snowdrop Wynde Shaftesbury SP7 8GX

## Entrance Hall

Door to the front, radiator, stairs to the first floor and doors in the lounge and downstairs WC.

## Cloakroom

Double glazed window to the front, WC, wash hand basin and a radiator.

## Lounge

Double glazed window to the front, under stairs cupboard and a radiator.

## Kitchen/Diner

Double glazed window and french doors to the rear, fitted kitchen with wall and base units, space for a fridge/freezer, plumbing for a washing machine and dishwasher, stainless steel sink and drainer, double electric oven and gas hob, extractor fan and the gas central heating boiler.



## Landing

Airing cupboard and access to the loft via a ladder.

## Bedroom One

Double glazed window to the front, door to the ensuite, cupboard over the stairs and a radiator.

## Ensuite

Double glazed window to the front, shower cubicle, wash hand basin and a WC.

## Bedroom Two

Double glazed window to the rear and a radiator.

## Bedroom Three

Double glazed window to the rear and a radiator.

## Bathroom

Double glazed window to the side, bath, wash hand basin, WC and a radiator.

## Parking

Driveway parking to the front for two cars.

## Rear Garden

Enclosed garden to the rear, with side access gate, patio seating area off the kitchen/diner with the remainder laid to lawn with a further patio area to the rear.



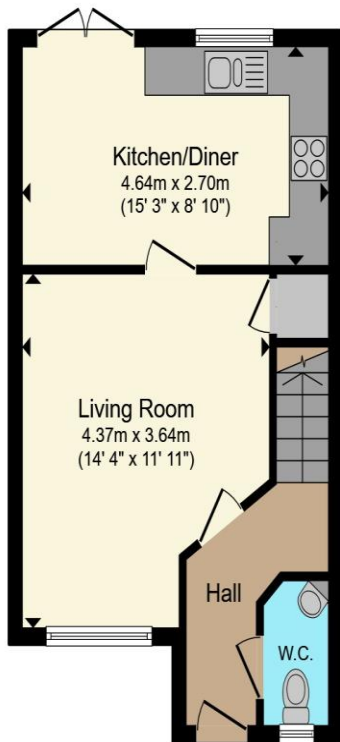

**Ground Floor**

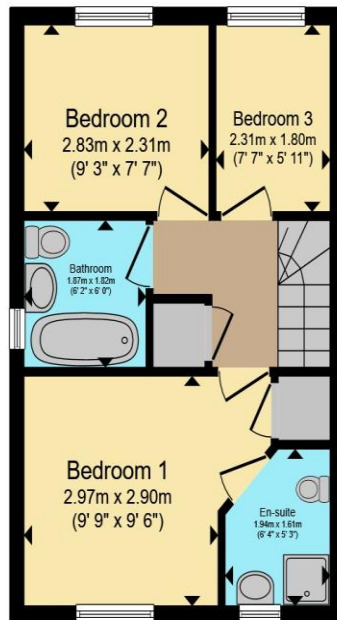

**First Floor**

Total floor area 69.7 m<sup>2</sup> (750 sq.ft.) approx

This floor plan is for illustrative purposes only. It is not drawn to scale. Any measurements, floor areas (including any total floor area), openings and orientation are approximate. No details are guaranteed, they cannot be relied upon for any purpose and they do not form part of any agreement. No liability is taken for any error, omission or misstatement. A party must rely upon its own inspection(s). Powered by www.propertybox.io



To view this property please contact Connells on

**T 01747 854 001**  
**E shaftesbury@connells.co.uk**

34 High Street  
SHAFTESBURY SP7 8JG

Property Ref: SFT306420 - 0002

Tenure:Freehold EPC Rating: B

Council Tax Band: C

**view this property online**  
**connells.co.uk/Property/SFT306420**



1. MONEY LAUNDERING REGULATIONS Intending purchasers will be asked to produce identification documentation at a later stage and we would ask for your co-operation in order that there will be no delay in agreeing the sale. 2. These particulars do not constitute part or all of an offer or contract. 3. The measurements indicated are supplied for guidance only and as such must be considered incorrect. Potential buyers are advised to recheck measurements before committing to any expense. 4. We have not tested any apparatus, equipment, fixtures, fittings or services and it is in the buyers interest to check the working condition of any appliances.

Connells Residential is registered in England and Wales under company number 1489613, Registered Office is Cumbria House, 16-20 Hockliffe Street, Leighton Buzzard, Bedfordshire, LU7 1GN. VAT Registration Number is 500 2481 05.

see all our properties at [www.connells.co.uk](http://www.connells.co.uk) | [www.rightmove.co.uk](http://www.rightmove.co.uk) | [www.zoopla.co.uk](http://www.zoopla.co.uk)