



Connells

Astwood Road
WORCESTER



Property Description

Situated on the popular Astwood Road in Worcester, this well-presented three-bedroom semi-detached home offers spacious and practical accommodation, making it an ideal purchase for first-time buyers, growing families, or investors.

The ground floor comprises a welcoming living room, a fitted kitchen to the rear with access to the garden, and the added convenience of a downstairs WC.

Upstairs, the property offers three well-proportioned bedrooms and a family bathroom.

Externally, the rear garden features a combination of patio and lawn, providing an excellent space for outdoor entertaining or relaxing. Beyond the garden is a private driveway offering off-road parking for up to two vehicles.

Conveniently located within easy reach of local amenities, schools, transport links, and Worcester city centre, this property presents a fantastic opportunity to acquire a comfortable family home in a sought-after location.

Early viewing is highly recommended.

Ground Floor

Entrance Hall

Living Area

Front facing double glazed window with fitted blinds, ceiling light, radiator, electric fire, storage cupboard and carpet flooring.

Open plan through to the kitchen.

Kitchen

Two rear facing double glazed windows, ceiling light, radiator, breakfast bar, integrated dishwasher, space for appliances, sink and drainer, wall and base units and tiled flooring.

Doors leading to a storage cupboard and downstairs W.C.

Side door leading out to the rear garden.

W.C

W.C and a wash hand basin.

First Floor

Landing

Side facing double glazed window, ceiling light, radiator, boiler cupboard and carpet flooring.

Bedroom One

Rear facing double glazed window with fitted blinds, ceiling light, radiator and carpet flooring.

Bedroom Two

Front facing double glazed window with fitted blinds, ceiling light, radiator and carpet flooring.

Bedroom Three

Front facing double glazed window with fitted blinds, ceiling light, radiator and carpet flooring.

Bathroom

Rear facing double glazed window, ceiling light, W.C, wash hand basin, bath with shower, chrome towel radiator and partly tiled walls.

Loft Space

Partly boarded with a pull-down ladder.

Outside

Outside Front

To the front of the property is a gate leading to the front door.

Outside Rear

To the rear of the property is a flat part slabbed/part laid to lawn garden. There is a side access gate and also further to the rear is a large, gated driveway with room for two cars.

Services

All main services are connected to the property.







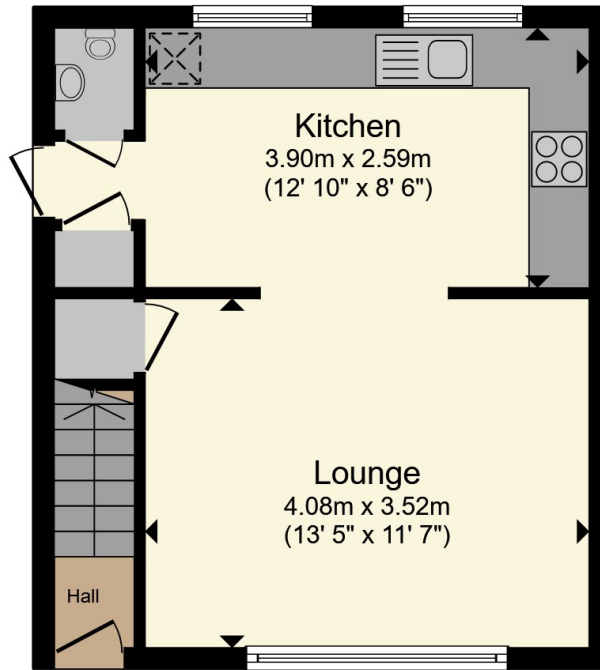

Ground Floor

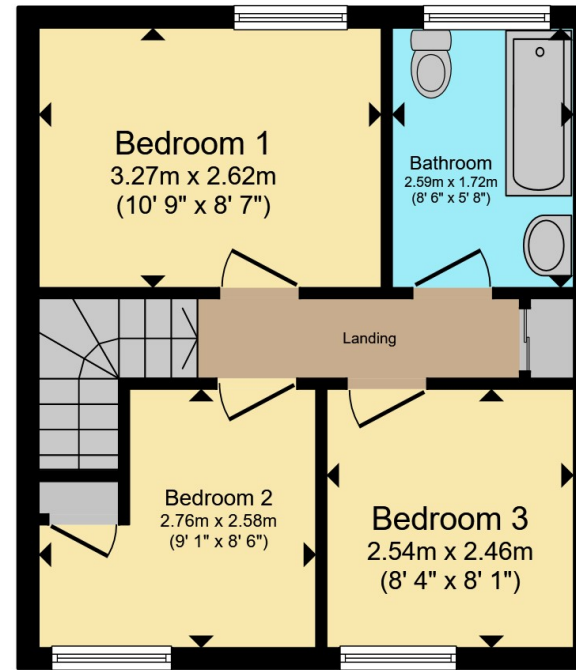

First Floor

Total floor area 65.7 m² (707 sq.ft.) approx

This floor plan is for illustrative purposes only. It is not drawn to scale. Any measurements, floor areas (including any total floor area), openings and orientation are approximate. No details are guaranteed, they cannot be relied upon for any purpose and they do not form part of any agreement. No liability is taken for any error, omission or misstatement. A party must rely upon its own inspection(s). Powered by www.propertybox.io



To view this property please contact Connells on

T 01905 611 411

E worcester@connells.co.uk

3 Foregate Street
WORCESTER WR1 1DB

EPC Rating: Council Tax
Awaited Band: B

Tenure: Freehold

view this property online connells.co.uk/Property/WOR316003



1. MONEY LAUNDERING REGULATIONS Intending purchasers will be asked to produce identification documentation at a later stage and we would ask for your co-operation in order that there will be no delay in agreeing the sale. 2. These particulars do not constitute part or all of an offer or contract. 3. The measurements indicated are supplied for guidance only and as such must be considered incorrect. Potential buyers are advised to recheck measurements before committing to any expense. 4. We have not tested any apparatus, equipment, fixtures, fittings or services and it is in the buyers interest to check the working condition of any appliances.

Connells Residential is registered in England and Wales under company number 1489613, Registered Office is Cumbria House, 16-20 Hockliffe Street, Leighton Buzzard, Bedfordshire, LU7 1GN. VAT Registration Number is 500 2481 05.

See all our properties at www.connells.co.uk | www.rightmove.co.uk | www.zoopla.co.uk

Property Ref: WOR316003 - 0001