



Bennett Park, Blackheath, SE3 9RB

£ Share of Freehold

Located in the very heart of Blackheath village, a lovely bright two bedroomed conversion flat occupying the whole first floor of this substantial four floor, semi-detached, Victorian house.

There are several steps up from pavement to the communal entrance door at hall floor level from which the nicely carpeted and decorated staircase ascends to the first floor and flat door. This opens into a little lobby with door to the two bedrooms and reception room. The larger bedroom has a full wall of floor-to-ceiling wardrobes, and both have windows to the front. The reception room has a pair of west-facing sash windows and door to another small lobby leading to the kitchen and bathroom, both of which have been refitted to a good standard. The whole flat is very well presented with plain white walls and ceilings, modern electric fuseboard and gas heating boiler, and all of the windows have been replaced with timber framed double glazed sashes. The flat is currently let at £1850/month.

Bennett Park is a quiet cul-de-sac off Blackheath Village, less than 100 yards from the station entrance.

The Accommodation Comprises:

Entrance Hall, Reception Room, Kitchen, Two Bedrooms, Bathroom, Double Glazed Sash Windows, Gas Central Heating, No Chain.

EPC: C Council Tax Band: D Greenwich (Blackheath Park Conservation Area)
Lease Term: over 900 years Ground Rent: £0 p.a. Maintenance: £100/month





1ST FLOOR
585 sq.ft. (54.3 sq.m.) approx.

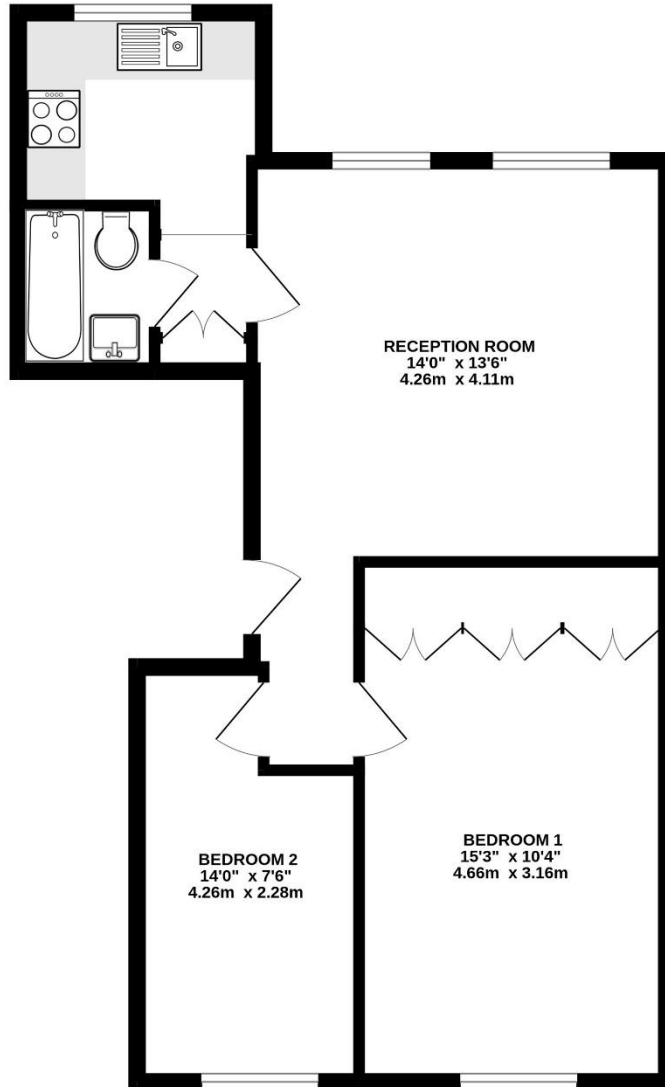

TOTAL FLOOR AREA : 585 sq.ft. (54.3 sq.m.) approx.

Whilst every attempt has been made to ensure the accuracy of the floorplan contained here, measurements of doors, windows, rooms and any other items are approximate and no responsibility is taken for any error, omission or mis-statement. This plan is for illustrative purposes only and should be used as such by any prospective purchaser. The services, systems and appliances shown have not been tested and no guarantee as to their operability or efficiency can be given.
Made with Metropix ©2026

Viewing strictly by appointment through Comber & Company 020 8318 9666 sales@comberandco.co.uk

We have prepared these particulars in good faith to give a broad description of the property. Please note that we have not tested any of the services or appliances but have relied upon our own brief inspection and information supplied to us by the vendor. The buyer is therefore advised to obtain verification from their solicitor or surveyor.