



Spitfire Court, Mitchell Close, Southampton SO19 7TN

welcome to

Spitfire Court Mitchell Close, Southampton

* FIRST FLOOR FLAT * TWO BEDROOMS * BALCONY WITH FANTASTIC WATER VIEWS OVERLOOKING RIVER ITCHEN * RESIDENTS PARKING *
LOUNGE/DINER * FITTED KITCHEN & SHOWER ROOM * FANTASTIC LOCATION *

Entrance Porch

Communal intercom system, stairs or lift to first floor.

Entrance Hall

Access to all rooms, storage cupboards, leading to;

Lounge/Diner

19' 7" x 14' 9" (5.97m x 4.50m)

Double glazed window to the side aspect, carpet throughout, electric radiator, dining space, door to balcony, access to;

Kitchen

7' 5" x 6' 9" (2.26m x 2.06m)

Wall and base cupboard units, electric oven, electric hob, freestanding fridge/freezer, two double glazed windows to the rear aspect.

Bedroom One

10' 5" x 10' 1" (3.17m x 3.07m)

Two double glazed windows to the side aspect, carpet throughout, electric radiator, built in wardrobe.

Bedroom Two

10' 1" x 6' 5" (3.07m x 1.96m)

Double glazed window to the side aspect, electric radiator, carpet throughout.

Shower Room

Walk-in shower, low level w/c, wash hand basin unit, tiled walls, extractor fan.





Located in a highly sought-after area, this impressive two-bedroom first floor flat boasts fantastic water views across the River Itchen, offering a wonderful blend of comfort and scenery.

The property features a bright and spacious lounge/diner, complete with a private balcony—the perfect spot to relax and take in the picturesque river views. The fitted kitchen is well-appointed with ample storage and workspace. There are two well-proportioned bedrooms along with a modern shower room.

Further benefits include residents parking, ensuring ease of access and peace of mind.

Situated in a great location close to local amenities, transport links, and waterfront walks, this property is ideal for those seeking a home with both practicality and a scenic outlook. Viewing is highly recommended to fully appreciate the views and lifestyle on offer.



view this property online fox-and-sons.co.uk/Property/BIT113343



welcome to

Spitfire Court Mitchell Close, Southampton

- First Floor Flat
- Two Bedrooms
- Balcony with Fantastic Water Views
- Lounge/Diner
- Fitted Kitchen & Shower Room

Tenure: Leasehold EPC Rating: Awaited

Council Tax Band: B Service Charge: 1995.00

Ground Rent: 120.00

This is a Leasehold property with details as follows; Term of Lease 125 years from 25 Mar 1993. Should you require further information please contact the branch. Please Note additional fees could be incurred for items such as Leasehold packs.

£175,000

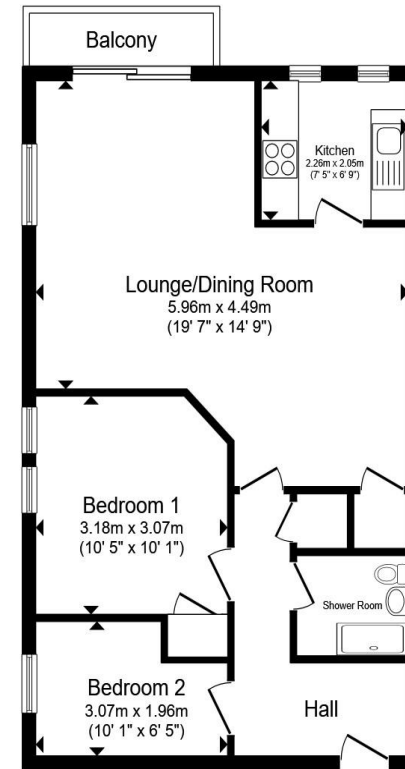

Total floor area 58.6 m² (631 sq.ft.) approx

This floor plan is for illustrative purposes only. It is not drawn to scale. Any measurements, floor areas (including any total floor area), openings and orientation are approximate. No details are guaranteed, they cannot be relied upon for any purpose and they do not form part of any agreement. No liability is taken for any error, omission or misstatement. A party must rely upon its own inspection(s). Powered by www.propertybox.io



view this property online fox-and-sons.co.uk/Property/BIT113343



Property Ref:
BIT113343 - 0002

1. MONEY LAUNDERING REGULATIONS Intending purchasers will be asked to produce identification documentation at a later stage and we would ask for your co-operation in order that there is no delay in agreeing the sale. 2. These particulars do not constitute part or all of an offer or contract. 3. The measurements indicated are supplied for guidance only and as such must be considered incorrect. Potential buyers are advised to recheck measurements before committing to any expense. 4. We have not tested any apparatus, equipment, fixtures or services and it is in the buyers interest to check the working condition of any appliances. 5. Where an EPC, or a Home Report (Scotland only) is held for this property, it is available for inspection at the branch by appointment. If you require a printed version of a Home Report, you will need to pay a reasonable production charge reflecting printing and other costs. 6. We are not able to offer an opinion either written or verbal on the content of these reports and this must be obtained from your legal representative. 7. Whilst we take care in preparing these reports, a buyer should ensure that his/her legal representative confirms as soon as possible all matters relating to title including the extent and boundaries of the property and other important matters before exchange of contracts.

Fox & Sons is a trading name of Sequence (UK) Limited which is registered in England and Wales under company number 4268443, Registered Office is Cumbria House, 16-20 Hockliffe Street, Leighton Buzzard, Bedfordshire, LU7 1GN. VAT Registration Number is 500 2481 05.



023 8044 6724



Bitterne@fox-and-sons.co.uk



390c Bitterne Road, Bitterne, SOUTHAMPTON,
Hampshire, SO18 5RS



fox-and-sons.co.uk