



Brawn Way, Elton Peterborough
£575,000 Freehold

**Sharman
Quinney**

Key Features



- No onward chain
- Beautifully situated next to open fields
- Large driveway
- Conservatory
- Double garage

Tucked away from the road at the end of a quiet cul-de-sac, this attractive property enjoys a peaceful setting on the edge of the village, boasting stunning open views across the surrounding countryside.

The home is approached via a generous driveway providing ample off-road parking for up to four vehicles, alongside an integrated double garage with electric roller doors.

Upon entering, you are welcomed by a practical porch area-ideal for coats and shoes-leading through to a spacious hallway featuring a useful under-stairs storage cupboard. The main living room is beautifully light and airy, benefitting from a large front-facing window and sliding glass doors that open into the conservatory. A striking stone



mantelpiece with a wood-burning stove creates a cosy focal point.

The conservatory offers a wonderful additional living space, perfectly positioned to take in views over the expansive rear garden and adjoining fields. The kitchen is generously sized and overlooks the garden, with a separate utility room to the rear providing a sink, plumbing for a washing machine, and further access to both the garden and conservatory.

Externally, the large rear garden features a patio seating area, with the remainder laid to lawn and bordered by mature plants and trees-ideal for those seeking a private and scenic outdoor space.

Upstairs, the property offers four bedrooms, three of which are comfortable doubles. One benefits from built-in wardrobes, while the master bedroom is further enhanced by a modern three-piece en-suite. A family bathroom serves the remaining bedrooms and includes a corner bath with shower over.

This is a rare opportunity to acquire a well-positioned home combining quiet village living with generous accommodation and beautiful countryside views.





Ground Floor

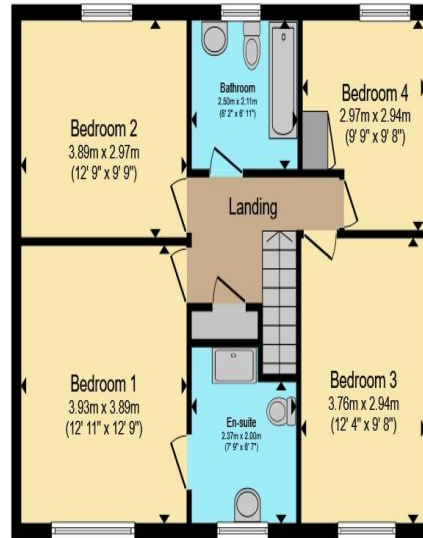

First Floor

Total floor area 198.9 m² (2,141 sq.ft.) approx

This floor plan is for illustrative purposes only. It is not drawn to scale. Any measurements, floor areas (including any total floor area), openings and orientation are approximate. No details are guaranteed, they cannot be relied upon for any purpose and they do not form part of any agreement. No liability is taken for any error, omission or misstatement. A party must rely upon its own inspection(s). Powered by www.propertybox.io

**Sharman
Quinney**

To view this property call Sharman Quinney on:
01832 274567

Selling your property?

Contact us to arrange a **FREE** home valuation.

 01832 274567

 The Old Town Hall Market Place, Oundle, Peterborough, Cambridgeshire, PE8 4BQ

 oundle@sharmanquinney.co.uk

 www.sharmanquinney.co.uk



 SCAN ME



Sharman Quinney Holdings Limited is registered in England and Wales under company number 4174227, Registered Office is Cumbria House, 16-20 Hockliffe Street, Leighton Buzzard, Bedfordshire, LU7 1GN. VAT Registration Number is 500 2481 05.

1: These particulars do not constitute part or all of an offer or contract. 2: The measurements indicated are supplied for guidance only and as such must be considered incorrect. 3: Potential buyers are advised to recheck the measurements before committing to any expense. 4: Sharman Quinney has not tested any apparatus, equipment, fixtures, fittings or services and it is the buyers interests to check the working condition of any appliances. 5: Sharman Quinney has not sought to verify the legal title of the property and buyers must obtain verification from their legal representative. 6: Intending purchasers will be asked to produce identification documentation at a later stage and we would ask your co-operation in order that there will be no delay in agreeing the sale. Ref: OUN202946 - 0001

