



**Hockerill, Watton At Stone Hertford, SG14 3SQ**

## welcome to Hockerill, Watton At Stone Hertford

A well-proportioned and extended three-bedroom link-detached family home, situated in a quiet cul-de-sac within the ever-popular village of Watton-at-Stone. Ideally located within a short walk of local schools, village shops and the Watton-at-Stone railway station, this larger-than-average home offers spacious and versatile accommodation throughout. The ground floor features a generous through lounge with direct access to the rear garden, creating an ideal space for both family living and entertaining. The property has also been extended to provide a modern kitchen/dining room fitted with a range of integrated appliances, ample storage and flexible space that could equally be utilised as a home office, study area or family room. A convenient downstairs cloakroom completes the ground floor accommodation. The first floor comprises three well-proportioned bedrooms and a family bathroom, offering comfortable living space for a growing family.





**Ground Floor**

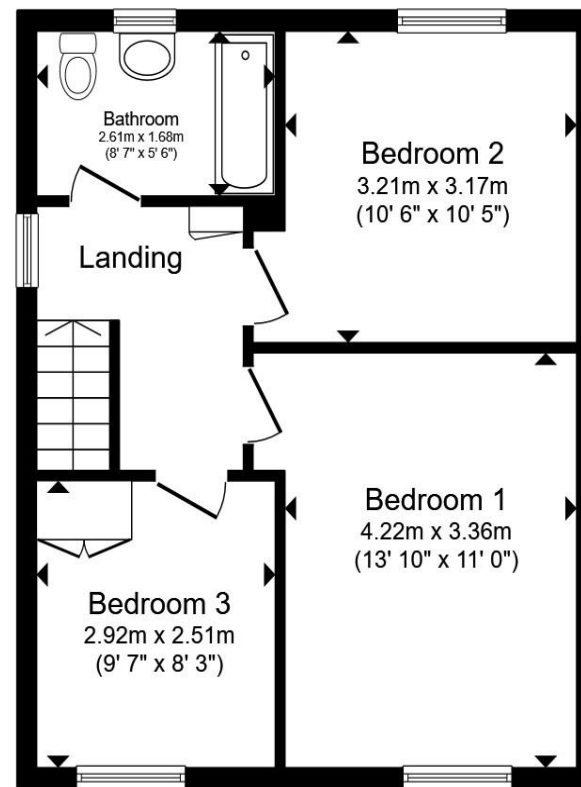

**First Floor**

Total floor area 100.2 m<sup>2</sup> (1,078 sq.ft.) approx

This floor plan is for illustrative purposes only. It is not drawn to scale. Any measurements, floor areas (including any total floor area), openings and orientation are approximate. No details are guaranteed, they cannot be relied upon for any purpose and they do not form part of any agreement. No liability is taken for any error, omission or misstatement. A party must rely upon its own inspection(s). Powered by [www.propertybox.io](http://www.propertybox.io)



**-Accommodation Overview-**

**Entrance Hall**

**Downstairs Cloakroom**

**Living / Dining Room**

24' 5" x 12' ( 7.44m x 3.66m )

**Reception Room**

11' 3" x 7' 1" ( 3.43m x 2.16m )

**Kitchen**

13' 1" x 9' 5" ( 3.99m x 2.87m )

**-First Floor Landing-**

**Bedroom One**

13' 10" x 11' ( 4.22m x 3.35m )

**Bedroom Two**

10' 6" x 10' 5" ( 3.20m x 3.17m )

**Bedroom Three**

9' 7" x 8' 3" ( 2.92m x 2.51m )

**Bathroom**

**-Exterior-**

**Rear Garden**

**Agent Note:**

We are advised that there is asbestos present to the roof soffits and the remains of an asbestos cold-water tank to the loft space that is not in use.

welcome to

## Hockerill, Watton At Stone Hertford

- Extended Three Bedroom Linked Detached Family Home
- Situated In A Highly Sought After Location
- Downstairs Cloakroom & Family Bathroom
- Watton At Stone Offers Excellent Amenities Including A Mainline Station Which Serves London's Moorgate
- Front & Rear Gardens

Tenure: Freehold

EPC Rating: C

Council Tax Band: E

**£460,000**



Please note the marker reflects the postcode not the actual property

**view this property online** [williamhbrown.co.uk/Property/HFD108367](https://www.williamhbrown.co.uk/Property/HFD108367)



Property Ref:  
HFD108367 - 0002

1. MONEY LAUNDERING REGULATIONS Intending purchasers will be asked to produce identification documentation at a later stage and we would ask for your co-operation in order that there is no delay in agreeing the sale. 2. These particulars do not constitute part or all of an offer or contract. 3. The measurements indicated are supplied for guidance only and as such must be considered incorrect. Potential buyers are advised to recheck measurements before committing to any expense. 4. We have not tested any apparatus, equipment, fixtures or services and it is in the buyers interest to check the working condition of any appliances. 5. Where an EPC, or a Home Report (Scotland only) is held for this property, it is available for inspection at the branch by appointment. If you require a printed version of a Home Report, you will need to pay a reasonable production charge reflecting printing and other costs. 6. We are not able to offer an opinion either written or verbal on the content of these reports and this must be obtained from your legal representative. 7. Whilst we take care in preparing these reports, a buyer should ensure that his/her legal representative confirms as soon as possible all matters relating to title including the extent and boundaries of the property and other important matters before exchange of contracts.

William H Brown is a trading name of Sequence (UK) Limited which is registered in England and Wales under company number 4268443, Registered Office is Cumbria House, 16-20 Hockliffe Street, Leighton Buzzard, Bedfordshire, LU7 1GN. VAT Registration Number is 500 2481 05.



william h brown



**01992 586501**



[Hertford@williamhbrown.co.uk](mailto:Hertford@williamhbrown.co.uk)



21 Castle Street, HERTFORD, Hertfordshire,  
SG14 1ER



[williamhbrown.co.uk](https://www.williamhbrown.co.uk)