



**Sittingbourne Avenue, Enfield, EN1 2DD**



**welcome to**

**Sittingbourne Avenue, Enfield**

Sitting on the borders of Enfield and Winchmore Hill, is this three bedroom mid terraced family home. The property offers well-proportioned accommodation and is just a short walk from the local shops at Bush Hill Parade and is 0.7 miles from Bush Hill Park Station.

The property is offered on a chain free basis.



### **Entrance Hall**

Radiator, dado rail, wood laminate floor, picture rail, stairs to first floor.

### **Lounge**

15' 10" x 13' 2" ( 4.83m x 4.01m )  
Double glazed window to front, radiator, original fireplace, dado rail, picture rail, built-in shelving and storage into recess, wood laminate floor.

### **Dining Room**

13' 11" x 12' 1" ( 4.24m x 3.68m )  
Wood laminate floor, picture rail, coving, radiator, double glazed patio doors to rear garden.

### **Kitchen**

8' 3" x 7' 10" ( 2.51m x 2.39m )  
Comprising wall and base units with contrasting marble worktops and splashbacks, inset sink and drainer, plumbing for washing machine, integrated fridge-freezer, five ring gas cooker and electric double oven, small dishwasher, washing machine, wood laminate floor, door to garden.

### **First Floor**

#### **Landing**

Access to loft.

### **Bedroom One**

14' 2" x 11' 1" ( 4.32m x 3.38m )  
Double glazed window to front, radiator, picture rail, fitted wardrobes, fitted carpet.

### **Bedroom Two**

12' 1" to wardrobes x 10' 8" ( 3.68m to wardrobes x 3.25m )  
Double glazed window to front, picture rail, fitted wardrobes, radiator, cupboard housing cold water tank and boiler.

### **Bedroom Three**

8' 9" x 7' 11" ( 2.67m x 2.41m )  
Double glazed bay window to front, picture rail, radiator.

### **Bathroom / WC**

Panelled bath with mixer taps, low flush WC, wash hand basin, heated towel rail, spotlights, part tiled walls, window.

### **Outside**

#### **Front Garden**

Block paved in readiness for parking. Kerb is not dropped.

#### **Rear Garden**

Approximately 50' of west facing garden with patio, laid to lawn, flowerbeds.



**view this property online** [barnfields.co.uk/Property/ENF105216](http://barnfields.co.uk/Property/ENF105216)





welcome to

## Sittingbourne Avenue, Enfield

- No Chain
- Potential For Off-Street Parking (subject to relevant permissions)
- Front Reception Room
- Rear Reception Room
- West Facing Rear Garden

Tenure: Freehold EPC Rating: D

Offers In Excess Of

**£585,000**



Please note the marker reflects the  
postcode not the actual property



## Sittingbourne Avenue, Enfield, EN1

Approximate Area = 1054 sq ft / 97.9 sq m  
Outbuilding = 125 sq ft / 11.6 sq m  
Total = 1179 sq ft / 109.5 sq m  
For identification only - Not to scale

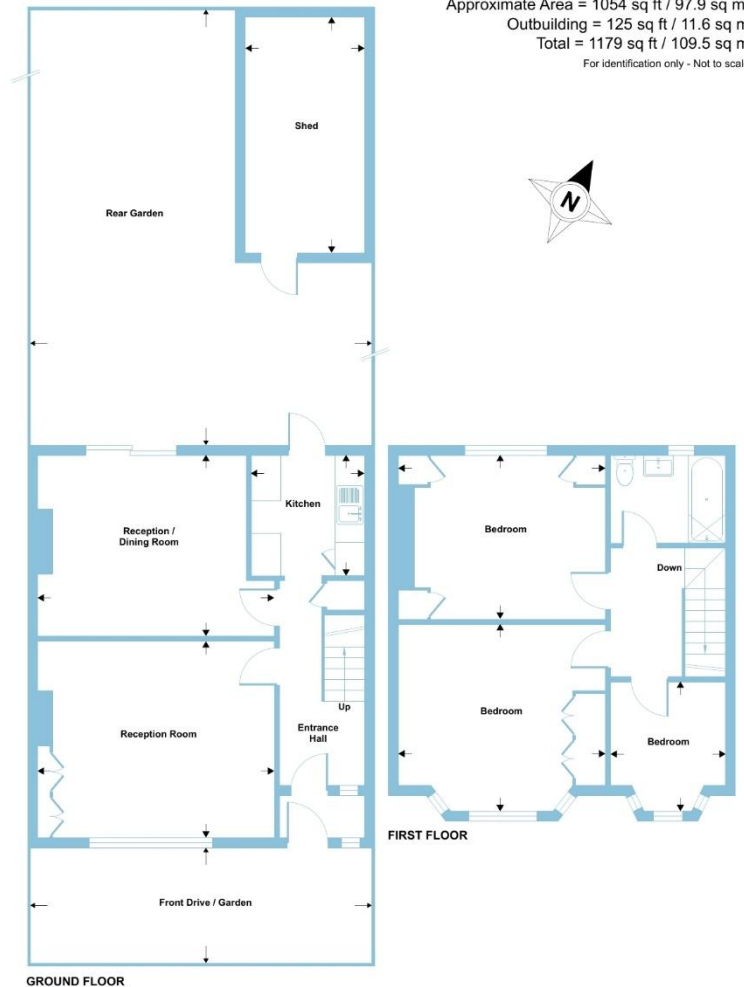

Floor plan produced in accordance with RICS Property Measurement 2nd Edition, Incorporating International Property Measurement Standards (IPMS2 Residential). © nichecom 2025. Produced for Barnard Marcus. REF: 1312828



check out more properties at [barnfields.co.uk](https://www.barnfields.co.uk)



Property Ref:  
ENF105216 - 0007

1. MONEY LAUNDERING REGULATIONS Intending purchasers will be asked to produce identification documentation at a later stage and we would ask for your co-operation in order that there is no delay in agreeing the sale. 2. These particulars do not constitute part or all of an offer or contract. 3. The measurements indicated are supplied for guidance only and as such must be considered incorrect. Potential buyers are advised to recheck measurements before committing to any expense. 4. We have not tested any apparatus, equipment, fixtures or services and it is in the buyers interest to check the working condition of any appliances. 5. Where an EPC, or a Home Report (Scotland only) is held for this property, it is available for inspection at the branch by appointment. If you require a printed version of a Home Report, you will need to pay a reasonable production charge reflecting printing and other costs. 6. We are not able to offer an opinion either written or verbal on the content of these reports and this must be obtained from your legal representative. 7. Whilst we take care in preparing these reports, a buyer should ensure that his/her legal representative confirms as soon as possible all matters relating to title including the extent and boundaries of the property and other important matters before exchange of contracts.

Barnfields is a trading name of Sequence (UK) Limited which is registered in England and Wales under company number 4268443, Registered Office is Cumbria House, 16-20 Hockliffe Street, Leighton Buzzard, Bedfordshire, LU7 1GN. VAT Registration Number is 500 2481 05.



**020 8363 3394**



[info@barnfields.com](mailto:info@barnfields.com)



1a Windmill Hill, Enfield, Middlesex, EN2 6SE



[barnfields.co.uk](https://www.barnfields.co.uk)