



Connells

Easingwold Gardens
Luton



Property Description

An Immaculate Family Home in a Highly Sought-After Location

This immaculate home is ideally suited to family living and is located in the popular Easingwold Gardens, just off Dallow Road. The area is well regarded and highly convenient, offering easy access to Luton Town Centre and Junction 11 of the M1.

A wide range of local amenities are within easy reach, including shops, supermarkets, bus routes and other everyday essentials. The location has long proved popular with families, with well-regarded schools such as Foxdell Primary and Challney Secondary commonly attended by local children.

The accommodation briefly comprises an entrance porch, cloakroom, welcoming entrance hall, fitted kitchen and a well-proportioned lounge. To the first floor are three good-sized bedrooms and a modern family bathroom.

Externally, the property benefits from a low-maintenance rear garden, ideal for busy family life, along with parking to the front of the property.

An Immaculate Family Home in a Highly Sought-After Location

This immaculate home is ideally suited to family living and is located in the popular Easingwold Gardens, just off Dallow Road. The area is well regarded and highly convenient, offering easy access to Luton Town Centre and Junction 11 of the M1.

A wide range of local amenities are within easy reach, including shops, supermarkets, bus routes and other everyday essentials. The location has long proved popular with families, with well-regarded schools such as Foxdell Primary and Challney Secondary commonly attended by local children.

The accommodation briefly comprises an entrance porch, cloakroom, welcoming entrance hall, fitted kitchen and a well-proportioned lounge. To the first floor are three good-sized bedrooms and a modern family bathroom.

Externally, the property benefits from a low-maintenance rear garden, ideal for busy family

life, along with parking to the front of the property.

An Immaculate Family Home in a Highly Sought-After Location

This immaculate home is ideally suited to family living and is located in the popular Easingwold Gardens, just off Dallow Road. The area is well regarded and highly convenient, offering easy access to Luton Town Centre and Junction 11 of the M1.

A wide range of local amenities are within easy reach, including shops, supermarkets, bus routes and other everyday essentials. The location has long proved popular with families, with well-regarded schools such as Foxdell Primary and Challney Secondary commonly attended by local children.

The accommodation briefly comprises an entrance porch, cloakroom, welcoming entrance hall, fitted kitchen and a well-proportioned lounge. To the first floor are three good-sized bedrooms and a modern family bathroom.

Externally, the property benefits from a low-maintenance rear garden, ideal for busy family life, along with parking to the front of the property.

An Immaculate Family Home in a Highly Sought-After Location

This immaculate home is ideally suited to family living and is located in the popular Easingwold Gardens, just off Dallow Road. The area is well regarded and highly convenient, offering easy access to Luton Town Centre and Junction 11 of the M1.

A wide range of local amenities are within easy reach, including shops, supermarkets, bus routes and other everyday essentials. The location has long proved popular with families, with well-regarded schools such as Foxdell Primary and Challney Secondary commonly attended by local children.

The accommodation briefly comprises an entrance porch, cloakroom,

welcoming entrance hall, fitted kitchen and a well-proportioned lounge. To the first floor are three good-sized bedrooms and a modern family bathroom.

Externally, the property benefits from a low-maintenance rear garden, ideal for busy family life, along with parking to the front of the property.



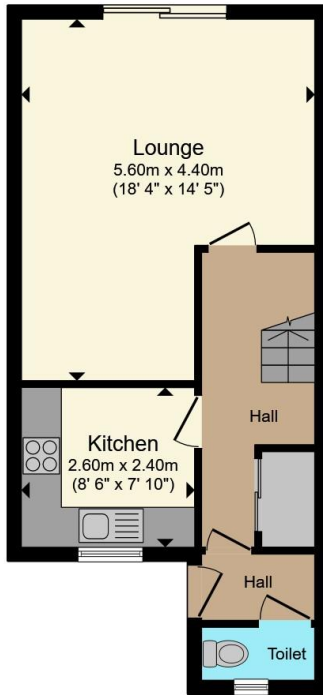

Ground Floor

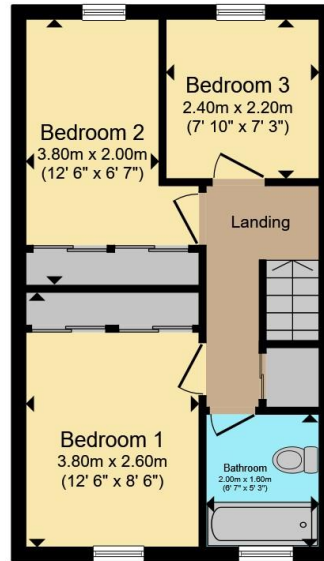

First Floor

Total floor area 73.2 m² (788 sq.ft.) approx

This floor plan is for illustrative purposes only. It is not drawn to scale. Any measurements, floor areas (including any total floor area), openings and orientation are approximate. No details are guaranteed, they cannot be relied upon for any purpose and they do not form part of any agreement. No liability is taken for any error, omission or misstatement. A party must rely upon its own inspection(s). Powered by www.propertybox.io



To view this property please contact Connells on

T 01582 450 999
E luton@connells.co.uk

83-83A George Street
LUTON LU1 2AT

EPC Rating: C Council Tax Band: B

view this property online connells.co.uk/Property/LUT318206

Tenure: Freehold



1. MONEY LAUNDERING REGULATIONS Intending purchasers will be asked to produce identification documentation at a later stage and we would ask for your co-operation in order that there will be no delay in agreeing the sale. 2. These particulars do not constitute part or all of an offer or contract. 3. The measurements indicated are supplied for guidance only and as such must be considered incorrect. Potential buyers are advised to recheck measurements before committing to any expense. 4. We have not tested any apparatus, equipment, fixtures, fittings or services and it is in the buyers interest to check the working condition of any appliances.

Connells Residential is registered in England and Wales under company number 1489613, Registered Office is Cumbria House, 16-20 Hockliffe Street, Leighton Buzzard, Bedfordshire, LU7 1GN. VAT Registration Number is 500 2481 05.

See all our properties at www.connells.co.uk | www.rightmove.co.uk | www.zoopla.co.uk

Property Ref: LUT318206 - 0003