



Fox Grant

## HOME GUARD FARMHOUSE GUSSAGE ST MICHAEL, DORSET

A substantial 4,100 ft<sup>2</sup> farm house, bordering The Gussage Stream, with scope for improvement, with period stable block and some 10,000 ft<sup>2</sup> of farm buildings and pasture. Available as a whole or in 2 lots. About 3.6 acres

## HOMEGUARD FARMHOUSE

This substantial farmhouse, requiring improvements is quietly situated in this most sought after village of Gussage St Michael. Available as a whole or in 2 lots.

LOT 1: Farm House and stable block in all approximately 1.021 acre

LOT 2: Agricultural barns in excess of 10,000 square feet/paddocks in all approximately 2.581 acres

A fantastic opportunity to improve this substantial farmhouse with numerous substantial outbuildings, land, yard and stables.

The farmhouse:

- Entrance hall
- Ground floor shower room/ cloakroom/store
- Drawing room inglenook
- Dining room with stone fire-place
- Farmhouse kitchen/breakfast room with Stanley oven
- Conservatory
- Rear hallway/utility
- Large walk- in pantry
- Large office
- Side entrance
- Ensuite bathroom
- Bedroom 2 with double aspect and exposed beam
- Ensuite shower room
- Bedroom 3 with aspect to rear
- Bedroom 4 with interconnecting room/nursery/study
- Landing front and rear with access to loft rooms

### 2nd floor/loft

- Loft room 1 with Dorma window to front and built in storage
- Loft room 2 with window to side
- Loft room 3 interconnecting with loft room 2 window to side and separate stair case to first floor landing

### First floor

- Main bedroom with double aspect and exposed ceiling beam

## OUTSIDE

The farmhouse has a good sized south facing garden which is walled on all sides, with a high degree of privacy. Mainly lawn with shrub areas and high level double gates to its northern boundary. The garden can be accessed from both the utility room and the conservatory

## OUTBUILDINGS

There is an excellent range of outbuildings of some 10,000 ft<sup>2</sup>.

- Brick built stable block with 4 stables and store, water and power grassed area (potential annex or holiday cottages subject to PP).
- Storage barn, work shop, meds room
- Barn/Grain store
- Barn/Grain store/machinery store
- Barn/Grain store/machinery store
- Open 5 bay store
- Single garage and store
- Attached to farmhouse two store rooms and small room over

## Home Guard Farmhouse, Gussage St. Michael, Wimborne, BH21

Approximate Area = 4097 sq ft / 380.6 sq m (excludes shelter)

Garage = 180 sq ft / 16.7 sq m

Outbuildings = 9662 sq ft / 897.6 sq m

Total = 13939 sq ft / 1294.9 sq m

For identification only - Not to scale

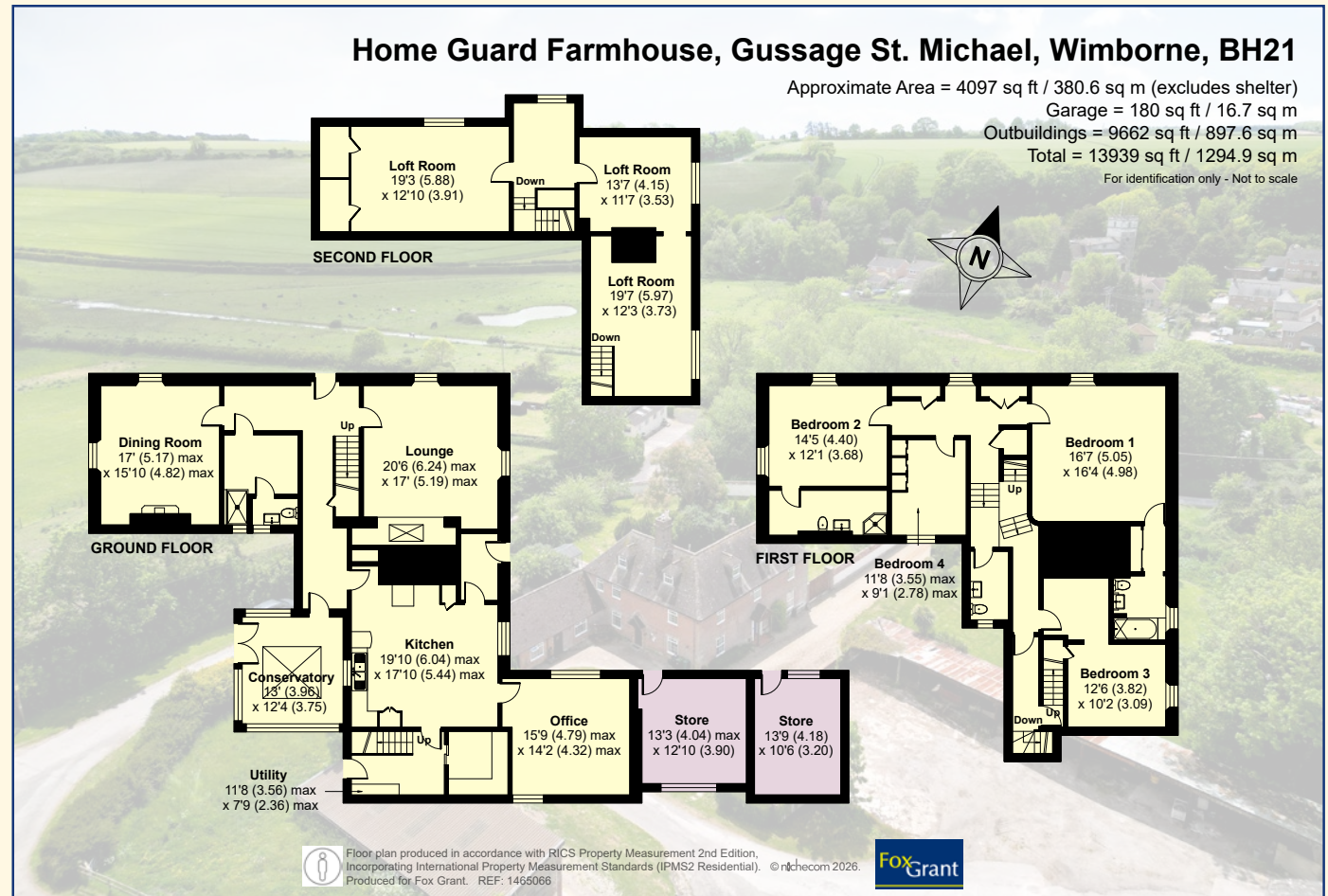

Floor plan produced in accordance with RICS Property Measurement 2nd Edition, incorporating International Property Measurement Standards (IPMS2 Residential). © nchechem 2026. Produced for Fox Grant. REF: 1465066



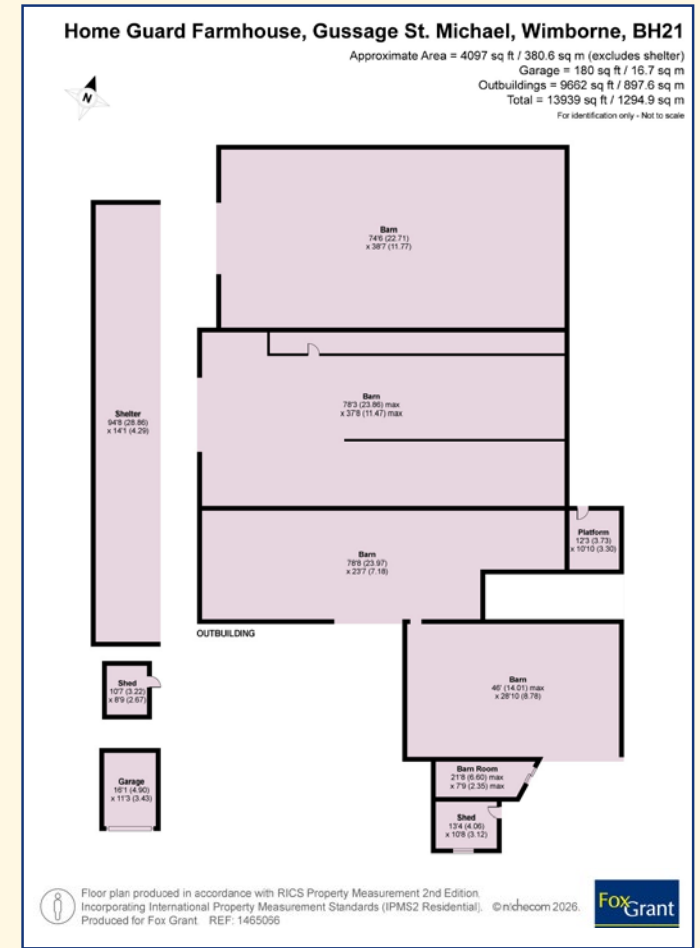
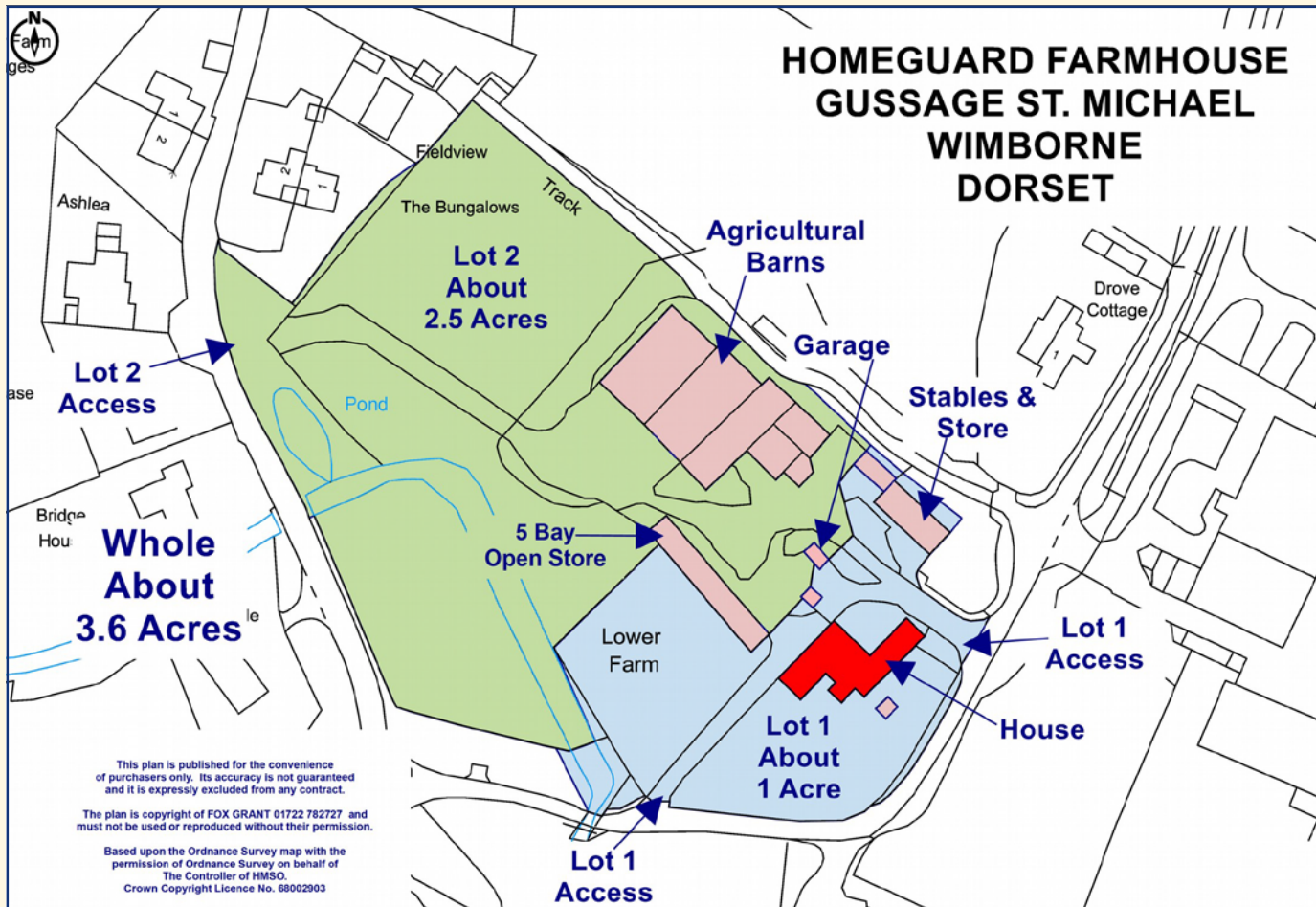

## SITUATION

Sixpenny Handley 6.5 miles Blandford 8 miles, Salisbury 18 miles

**Mainline Trains:** Poole to London Waterloo (2hr 13m) Salisbury to London Waterloo (1hr 28m)

**International Airports:** Bournemouth Airport 17.5 miles Southampton Airport 34.5 miles

**Education** The area abounds with good schools including Sandroyd, Canford, Clayesmore, Bryanston, Forres Sandle Manor at Fordingbridge and the girls and boys grammar schools in Salisbury. For further details see [www.isc.co.uk](http://www.isc.co.uk) for independent schools and [www.1.dorsetforyou.com/](http://www.1.dorsetforyou.com/) learning for state schools information.

**Local Sporting & Recreational** There are numerous sporting and recreational opportunities: the local area has numerous bridleways and footpaths popular with horse riders and walkers alike. Walkers can also enjoy Larmer Tree Gardens and Moors Valley Country Park. There is racing at Salisbury, Wincanton and Newbury. Golf can be played at Tollard Royal. Sailing and water sports can be enjoyed along the south coast. See [www.visit-dorset.org.uk](http://www.visit-dorset.org.uk) for more details.

There are numerous sporting and recreational opportunities: There are various Riding Schools in the area, Bushes Equestrian Centre approximately 8 miles away, Green Cottage Riding Centre & Stud approximately 8 miles away and East Moors Riding School approximately 10 miles away.

## AGENT'S NOTES

Fox Grant and their clients give notice that:

1. They have no authority to make or give any representations or warranties in relation to the property.
2. These particulars have been prepared in good faith to give a fair overall view of the property, do not form any part of an offer or contract and must not be relied upon as statements or representations of fact.
3. Any areas, measurements or distances are approximate. The text, photographs and plans are for guidance only and are not necessarily comprehensive. It should not be assumed that the property has all necessary planning, building regulation or other consents and Fox Grant has not tested any services, equipment or facilities. Purchasers must satisfy themselves by inspection or otherwise.

**EPC** this will follow

**Council Tax Band** Band F

**Services** private water supply from the neighbouring farm which will be metered. Mains electricity, septic tank, heating via oil boiler.

Particulars, prepared by William Fox Grant June 2026

**Fox Grant**



**HOME GUARD FARMHOUSE  
BH21 5HZ**

**VIEWINGS**

All viewings through the agents on **01722 782727** contact Rupert Langstaff of William Fox Grant for further details [rupert@foxgrant.com](mailto:rupert@foxgrant.com)



**William Fox Grant**



**Rupert Langstaff**



**DIRECTIONS**

From Salisbury, head southwest on the A354 towards Blandford. In Cashmore, turn left and head towards Gussage St Michael. Head southeast for 1.4 miles, and in the village, turn left by the Fox Grant board towards the property  
What3words: [///backdrop.stencil.streaking](https://www.what3words.com////backdrop.stencil.streaking)

Postcode: **BH21 5HZ**

[foxgrant.com](http://foxgrant.com)

**TOURISM & LEISURE**

**FARMS, LAND & SMALLHOLDINGS**

**TRUSTPILOT**  
★★★★★

**EQUESTRIAN SPECIALISTS**

**COUNTRY & VILLAGE**