



**Connells**

Pannier Place  
Downs Barn MILTON KEYNES

# Pannier Place Downs Barn MILTON KEYNES MK14 7QL

for sale  
**£260,000**



## Property Description

Situated in the popular residential area of Downs Barn, this well-presented two-bedroom semi-detached home offers comfortable living accommodation and is ideal for first-time buyers, investors, or those looking to downsize.

The property features a bright and welcoming living space, a fitted kitchen, and two well-proportioned bedrooms. Outside, the home benefits from a private rear garden, providing an excellent space for relaxing or entertaining, while the driveway offers convenient off-road parking.

Conveniently located close to local amenities, schools, transport links, and Central Milton Keynes, this property presents an excellent opportunity to acquire a home in a sought-after location.

## The Area

Downs Barn is conveniently located for excellent access into Milton Keynes town centre, and is within easy walking distance. Centre:MK is home to a wide range of well known shops and is one of the largest shopping malls in Europe. Further amenities such as bars and restaurants can be found in the theatre district, the Xscape building, and the hub area. The Xscape building is also home to a large multi-screen cinema.



## Living Room

Bright and spacious living room featuring a front aspect window allowing plenty of natural light to fill the room. Well-presented throughout and offering ample space for a range of living room furniture.

## Kitchen

Fitted with a range of wall and base units providing ample storage and worktop space. Window overlooking the rear garden and access to the garden, creating a bright and practical space for everyday living.

## Bedroom One

Generously sized double bedroom with window to the front aspect. Offering plenty of space for bedroom furniture and additional storage

## Bedroom Two

Good-sized second bedroom with window overlooking the rear garden. Ideal as a guest room, children's bedroom, or home office.

## Bathroom

Fitted with a three-piece suite comprising a bath with shower attachment, wash hand basin, and low-level WC.







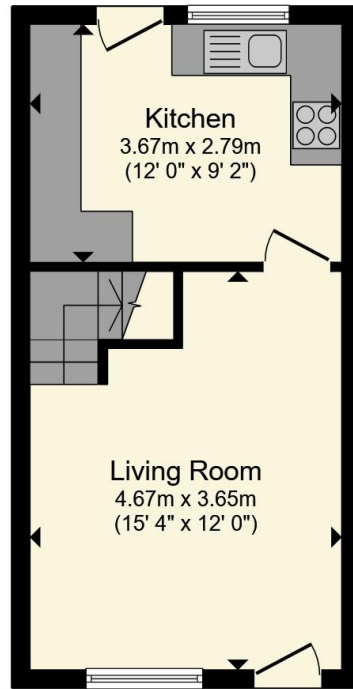

**Ground Floor**

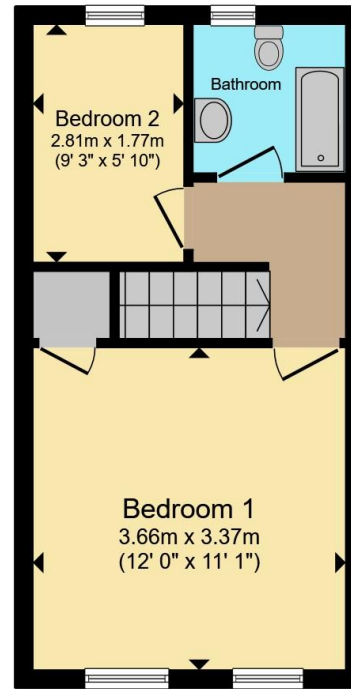

**First Floor**

Total floor area 55.3 m<sup>2</sup> (595 sq.ft.) approx

This floor plan is for illustrative purposes only. It is not drawn to scale. Any measurements, floor areas (including any total floor area), openings and orientation are approximate. No details are guaranteed, they cannot be relied upon for any purpose and they do not form part of any agreement. No liability is taken for any error, omission or misstatement. A party must rely upon its own inspection(s). Powered by [www.propertybox.io](http://www.propertybox.io)



To view this property please contact Connells on

**T 01908 674 141**  
**E [miltonkeynes@connells.co.uk](mailto:miltonkeynes@connells.co.uk)**

Northgate House 500 Silbury Boulevard  
MILTON KEYNES MK9 2AD

EPC Rating: Council Tax  
Awaited Band: B

Tenure: Freehold

**view this property online [connells.co.uk/Property/MKN321391](http://connells.co.uk/Property/MKN321391)**



1. MONEY LAUNDERING REGULATIONS Intending purchasers will be asked to produce identification documentation at a later stage and we would ask for your co-operation in order that there will be no delay in agreeing the sale. 2. These particulars do not constitute part or all of an offer or contract. 3. The measurements indicated are supplied for guidance only and as such must be considered incorrect. Potential buyers are advised to recheck measurements before committing to any expense. 4. We have not tested any apparatus, equipment, fixtures, fittings or services and it is in the buyers interest to check the working condition of any appliances.

Connells Residential is registered in England and Wales under company number 1489613, Registered Office is Cumbria House, 16-20 Hockliffe Street, Leighton Buzzard, Bedfordshire, LU7 1GN. VAT Registration Number is 500 2481 05.

**See all our properties at [www.connells.co.uk](http://www.connells.co.uk) | [www.rightmove.co.uk](http://www.rightmove.co.uk) | [www.zoopla.co.uk](http://www.zoopla.co.uk)**

Property Ref: MKN321391 - 0002