



Winchester Drive, Wallasey, CH44 2AY

welcome to

Winchester Drive, Wallasey

Well-located three bedroom semi-detached house on Winchester Drive, Wallasey. Benefiting from garage accessed via a shared driveway and a generous garden. Offering versatile accommodation close to local amenities, schools, and transport links.



Property Description

Situated in a popular residential location, this property offers an excellent opportunity for a variety of buyers.

The property benefits from a good size rear garden, and garage accessed via a shared drive Set within a well-established neighbourhood, the property enjoys close proximity to local amenities, well-regarded schools, and excellent transport links, making it ideally positioned for everyday living.

Internally, the accommodation is well-balanced and offers versatile living space. The layout provides a comfortable flow between room, with entrance porch, leading to entrance hall, two generous reception rooms, and a morning room, and kitchen positions to the rear. To the first floor there are three bedrooms, and shower room. The area is known for its coastal surroundings, strong community feel, and accessibility to Liverpool via road and rail links.

Early viewing is highly recommended to fully appreciate the potential and location on offer. Council Tax Band: C

Entrance Hall
Entrance Porch
Lounge
Dining Room
Morning Room
Kitchen

Landing
Bedroom One
Bedroom Two
Bedroom Three
Bathroom

Outside
Shared Driveway.

Rear Garden

Outbuildings

Garage (accessed via the shared driveway) and 2 Outbuildings.

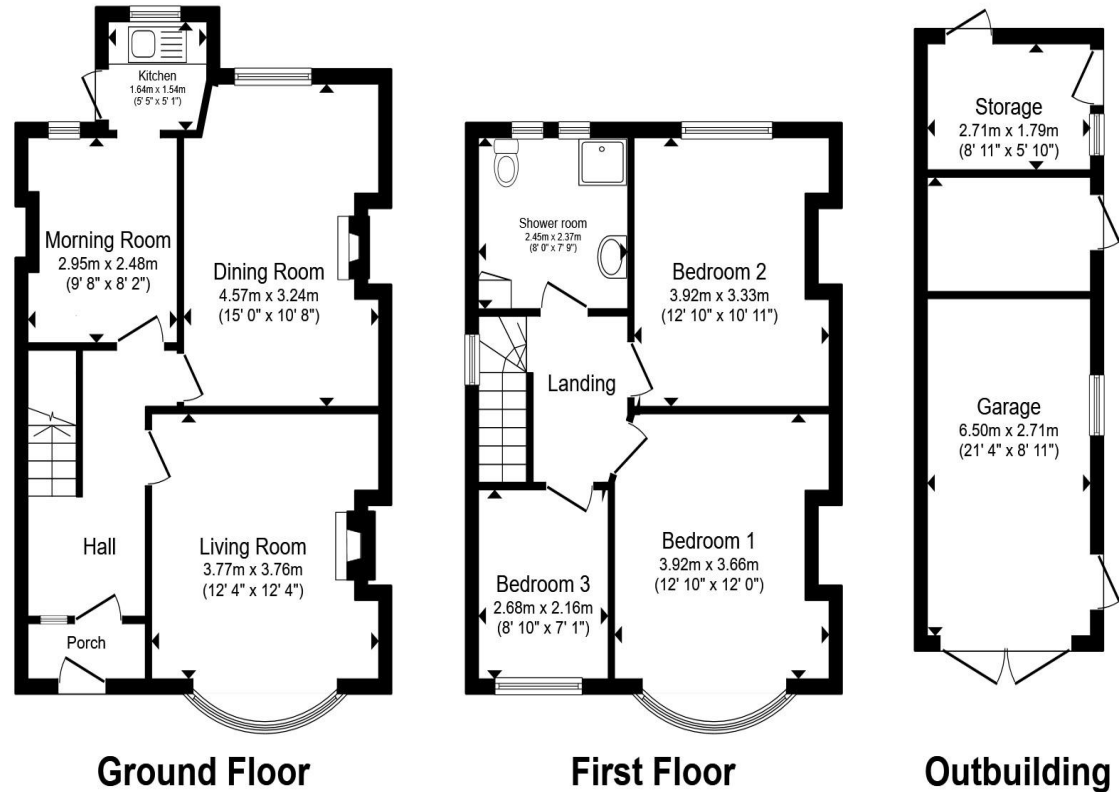

Total floor area 114.6 m² (1,234 sq.ft.) approx

This floor plan is for illustrative purposes only. It is not drawn to scale. Any measurements, floor areas (including any total floor area), openings and orientation are approximate. No details are guaranteed, they cannot be relied upon for any purpose and they do not form part of any agreement. No liability is taken for any error, omission or misstatement. A party must rely upon its own inspection(s). Powered by www.propertybox.io



view this property online jonesandchapman.co.uk/Property/WAL111671



welcome to

Winchester Drive, Wallasey

- Three bedroom semi-detached house
- Situated in a popular residential area
- Two reception rooms
- Garage & outbuildings
- Generous Garden

Tenure: Freehold EPC Rating: D

Council Tax Band: C

£240,000



Please note the marker reflects the postcode not the actual property

view this property online [jonesandchapman.co.uk/Property/WAL111671](https://www.jonesandchapman.co.uk/Property/WAL111671)



Property Ref:
WAL111671 - 0002

1. MONEY LAUNDERING REGULATIONS Intending purchasers will be asked to produce identification documentation at a later stage and we would ask for your co-operation in order that there is no delay in agreeing the sale. 2. These particulars do not constitute part or all of an offer or contract. 3. The measurements indicated are supplied for guidance only and as such must be considered incorrect. Potential buyers are advised to recheck measurements before committing to any expense. 4. We have not tested any apparatus, equipment, fixtures or services and it is in the buyers interest to check the working condition of any appliances. 5. Where an EPC, or a Home Report (Scotland only) is held for this property, it is available for inspection at the branch by appointment. If you require a printed version of a Home Report, you will need to pay a reasonable production charge reflecting printing and other costs. 6. We are not able to offer an opinion either written or verbal on the content of these reports and this must be obtained from your legal representative. 7. Whilst we take care in preparing these reports, a buyer should ensure that his/her legal representative confirms as soon as possible all matters relating to title including the extent and boundaries of the property and other important matters before exchange of contracts.

Jones & Chapman is a trading name of Sequence (UK) Limited which is registered in England and Wales under company number 4268443, Registered Office is Cumbria House, 16-20 Hockliffe Street, Leighton Buzzard, Bedfordshire, LU7 1GN. VAT Registration Number is 500 2481 05.

 jones & chapman



0151 630 4717



Wallasey@jonesandchapman.co.uk



108 Wallasey Road, WALLASEY, Merseyside,
CH44 2AE



jonesandchapman.co.uk