



**Connells**

The Close  
Horley



### Property Description

Situated on the edge of Horley, this beautifully designed three-bedroom detached bungalow is crafted by a highly respected local developer and finished to an exceptional standard throughout.

Inside, a bright and spacious open-plan kitchen/living/dining area forms the heart of the home.

French doors open onto a generous L-shaped private rear garden, complemented by an additional side window that enhances the natural light.

The contemporary kitchen features stylish base and eye-level units, quartz worktops, and a full suite of integrated appliances, including an electric hob, extractor, double oven with microwave, dishwasher, washer/dryer, fridge-freezer (70/30 split), and a convenient larder cupboard.

The property is finished with elegant herringbone flooring in the main living spaces and plush carpeting in all bedrooms.

The master bedroom includes fitted wardrobes, and the home is equipped with a range of modern features such as:

- CCTV and alarm system
- Media wall with 3D electric fire
- Air source heat pump
- Underfloor heating with individual room controls
- LED and low-voltage lighting

Outside, the front of the property offers driveway parking finished with attractive Cotswold stone chippings.

The landscaped rear garden features Sandstone paving, providing an ideal space for relaxing or entertaining,

This home offers an impressive blend of luxury, energy efficiency and practicality - perfect for downsizers or anyone seeking stylish single-storey living.

## Disclaimer

All the information has been provided by the developer and is subject to verification. Please note some images have been digitally dressed by AI and are indicative only.



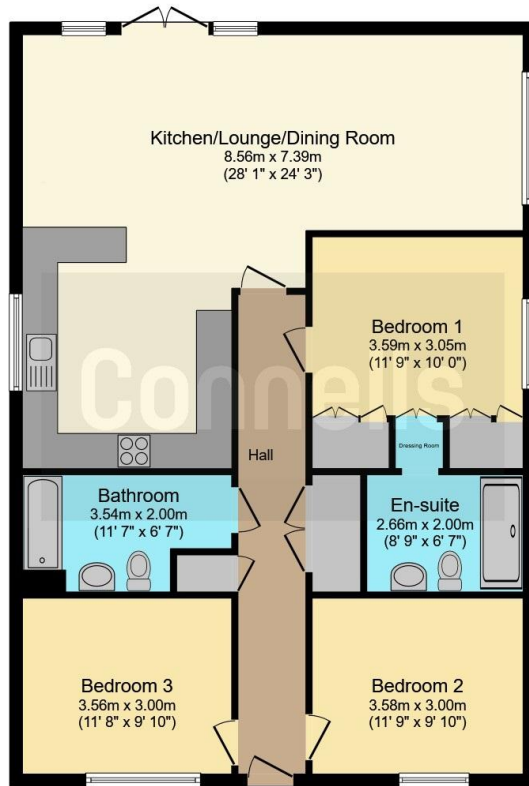

This floor plan is for illustrative purposes only. It is not drawn to scale. Any measurements, floor areas (including any total floor area), openings and orientation are approximate. No details are guaranteed, they cannot be relied upon for any purpose and they do not form part of any agreement. No liability is taken for any error, omission or misstatement. A party must rely upon its own inspection(s). Powered by [www.focalagent.com](http://www.focalagent.com)

To view this property please contact Connells on

**T 01293 785 346**  
**E [horley@connells.co.uk](mailto:horley@connells.co.uk)**

30 High Street  
HORLEY RH6 7BB

EPC Rating:  
Exempt

**view this property online [connells.co.uk/Property/HLY405126](http://connells.co.uk/Property/HLY405126)**

Tenure: Freehold



1. MONEY LAUNDERING REGULATIONS Intending purchasers will be asked to produce identification documentation at a later stage and we would ask for your co-operation in order that there will be no delay in agreeing the sale. 2. These particulars do not constitute part or all of an offer or contract. 3. The measurements indicated are supplied for guidance only and as such must be considered incorrect. Potential buyers are advised to recheck measurements before committing to any expense. 4. We have not tested any apparatus, equipment, fixtures, fittings or services and it is in the buyers interest to check the working condition of any appliances.

Connells Residential is registered in England and Wales under company number 1489613, Registered Office is Cumbria House, 16-20 Hockliffe Street, Leighton Buzzard, Bedfordshire, LU7 1GN. VAT Registration Number is 500 2481 05.

**See all our properties at [www.connells.co.uk](http://www.connells.co.uk) | [www.rightmove.co.uk](http://www.rightmove.co.uk) | [www.zoopla.co.uk](http://www.zoopla.co.uk)**

Property Ref: HLY405126 - 0002