



**GLOUCESTER STREET**  
PIMLICO

**JACKSON-STOPS** 

## GLOUCESTER STREET, PIMLICO, SW1V

ASKING PRICE: £550,000

A beautiful one-bedroom apartment is presented to the market in one of SW1's most favoured portered blocks, with the added benefit of a designated parking and storage unit.

Originally constructed in the 1990s behind a facade mirroring the typical Pimlico grid style, the property benefits from its quiet central grid location, its proximity to local shopping and transport links, as well as a share in the freehold and an external professional management company.

The apartment would ideally suit a first-time buyer, a pied-a-terre purchaser, (looking to benefit from the lock up and leave aspect), down sizer or buy to let investors with a view for a long term investment.

### KEY FEATURES

- Share of Freehold
- One Bedroom
- Porter
- Exclusive Parking Space
- Service Charge: c. £3500 pa
- No Onward Chain

Energy Rating: D. We aim to make our particulars both accurate and reliable. However they are not guaranteed; nor do they form part of an offer or contract. If you require clarification on any points then please contact us, especially if you are travelling some distance to view. Please note that appliances and heating systems have not been tested and therefore no warranties can be given as to their good working order.

Raeburn House,  
Gloucester Street, SW1  
Approx. Gross Internal Area \*  
470 Sq Ft - 43.66 Sq M

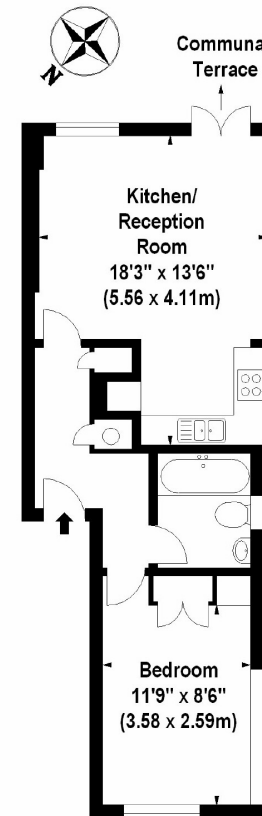

Raised Ground Floor

Illustration For Identification Purposes Only. Not To Scale  
\*Floorplans Drawn According To RICS Guidelines  
Tel : 07976 232758 / 9 www.totalvista.co.uk  
© Totalvista 2008 (aa)

ASKING PRICE: £550,000

PIMLICO

020 7828 4050

pimlicosales@jackson-stops.com

jackson-stops.co.uk

JACKSON-STOPS 