



Draycote Close, King's Lynn, PE30 3SZ



welcome to

Draycote Close, King's Lynn

Located in Templemead close to local amenities and primary school is this well presented three bedroom detached house with garage. Viewing highly recommended.



Entrance Door To:-

Radiator stairs to first floor

Cloakroom

Low level WC, wash hand basin, radiator, double glazed window

Lounge

15' 4" x 14' max (4.67m x 4.27m max)

Double glazed window, radiator, fireplace with inset electric fire, double glazed patio doors to conservatory

Kitchen

9' 6" x 8' 1" (2.90m x 2.46m)

Range of base and wall units, roll edge work top, inset circular sink with mixer tap over, space for cooker, washing machine and fridge freezer, door to: conservatory, opening to:-

Dining Room

9' 6" x 6' 4" (2.90m x 1.93m)

Double glazed window, radiator

Conservatory

15' 4" x 6' 1" (4.67m x 1.85m)

Double glazed door to rear, UPVC conservatory under a polycarbonate roof

First Floor Landing

Double glazed window

Bedroom One

10' 9" x 8' 2" (3.28m x 2.49m)

Double glazed window, radiator, storage cupboard

Bedroom Two

9' 6" x 8' 2" (2.90m x 2.49m)

Double glazed window, radiator, storage cupboard

Bedroom Three

7' 10" x 6' 5" (2.39m x 1.96m)

Double glazed window, radiator

Bathroom

Bath with shower mixer tap and shower screen, low level WC, wash hand basin, part tiled walls, double glazed window

Outside

Driveway with garage with up and over door, power and light. Side gate gives access to the enclosed rear garden



view this property online williamhbrown.co.uk/Property/KLN119855



welcome to

Draycote Close, King's Lynn

- Located Close to Amenities
- Detached House
- Three Bedrooms
- Two Reception Rooms
- Cloakroom

Tenure: Freehold EPC Rating: D
Council Tax Band: C

offers in excess of

£240,000

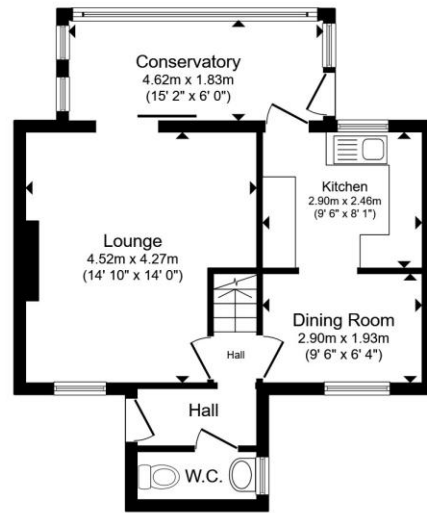

Ground Floor

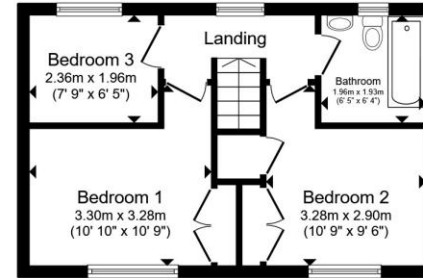

First Floor

Total floor area 79.3 m² (853 sq.ft.) approx

This floor plan is for illustrative purposes only. It is not drawn to scale. Any measurements, floor areas (including any total floor area), openings and orientation are approximate. No details are guaranteed, they cannot be relied upon for any purpose and they do not form part of any agreement. No liability is taken for any error, omission or misstatement. A party must rely upon its own inspection(s). Powered by www.propertybox.io



Please note the marker reflects the postcode not the actual property

view this property online williamhbrown.co.uk/Property/KLN119855



Property Ref:
KLN119855 - 0003

1. MONEY LAUNDERING REGULATIONS Intending purchasers will be asked to produce identification documentation at a later stage and we would ask for your co-operation in order that there is no delay in agreeing the sale. 2. These particulars do not constitute part or all of an offer or contract. 3. The measurements indicated are supplied for guidance only and as such must be considered incorrect. Potential buyers are advised to recheck measurements before committing to any expense. 4. We have not tested any apparatus, equipment, fixtures or services and it is in the buyers interest to check the working condition of any appliances. 5. Where an EPC, or a Home Report (Scotland only) is held for this property, it is available for inspection at the branch by appointment. If you require a printed version of a Home Report, you will need to pay a reasonable production charge reflecting printing and other costs. 6. We are not able to offer an opinion either written or verbal on the content of these reports and this must be obtained from your legal representative. 7. Whilst we take care in preparing these reports, a buyer should ensure that his/her legal representative confirms as soon as possible all matters relating to title including the extent and boundaries of the property and other important matters before exchange of contracts.

William H Brown is a trading name of Sequence (UK) Limited which is registered in England and Wales under company number 4268443, Registered Office is Cumbria House, 16-20 Hockliffe Street, Leighton Buzzard, Bedfordshire, LU7 1GN. VAT Registration Number is 500 2481 05.



01553 771337



KingsLynn@williamhbrown.co.uk



40-42 King Street, KING'S LYNN, Norfolk, PE30 1ES



williamhbrown.co.uk