

Frank Harris & Co.



Rotherhithe, SE16

£3,000 pcm

A three bedroom property on the second floor of Eyot House. This property has a large open plan living room with wood floors leading to a private balcony, three bedrooms with newly fitted carpets, one bathroom and a separate W/C.

Located in heart of Bermondsey, less than 0.2 miles from the Jubilee Line which gives easy access to The City and Canary Wharf. Maltby Street Market is close by, as well as a selection of restaurants and shops in London Bridge and Shad Thames.

- Three Bedrooms • One Bathroom • Part Furnished •
- Newly Refurbished • Over 1000sq/ft • Private Balcony •

Frank Harris & Co.

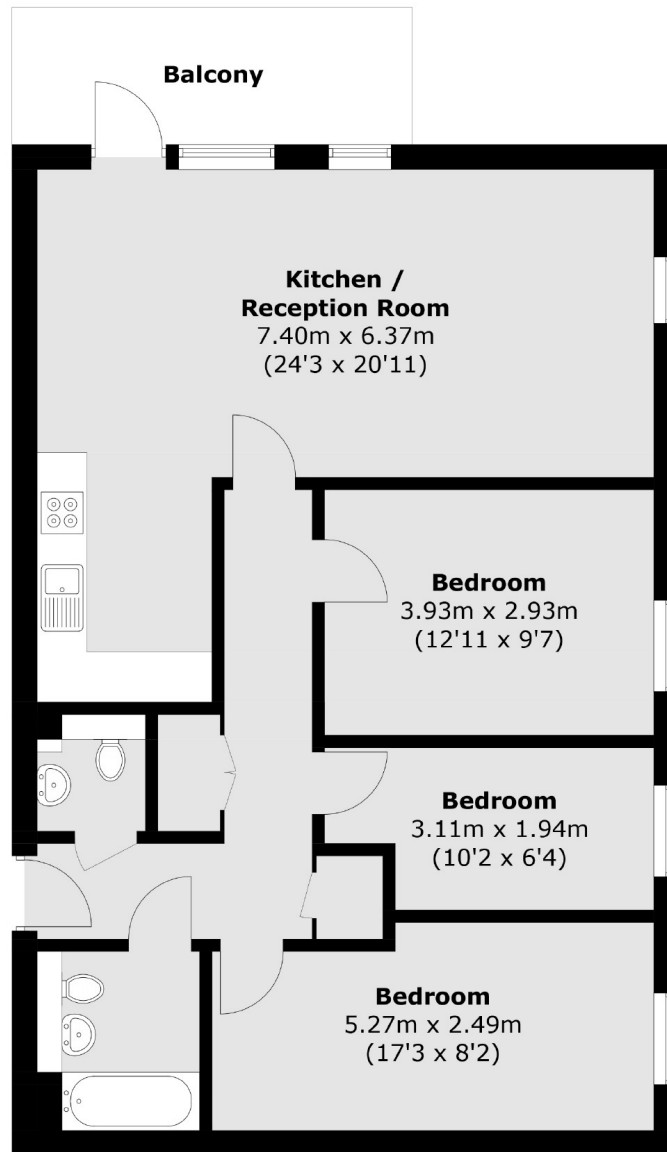

Total area (approx.): 85.7 sq. m (922.5 sq. ft)
Balcony: 7.9 sq. m (85 sq. ft)

Frank Harris & Co. Tower Bridge
205 Tooley Street, London,
SE1 2JX
020 7234 0880
towerbridgelettings@frankharris.co.uk

Energy Rating: . We aim to make our particulars both accurate and reliable. However they are not guaranteed; nor do they form part of an offer or contract. If you require clarification on any points then please contact us, especially if you're traveling some distance to view. Please note that appliances and heating systems have not been tested and therefore no warranties can be given as to their good working order.

