

for sale

offers in excess of **£230,000**



Ash Close Shaftesbury SP7 8RA

This three bedroom mid-terrace home in Shaftesbury offers a spacious lounge/diner, kitchen to the rear, and a private rear garden. An ideal choice for first-time buyers or investors.



Ash Close Shaftesbury SP7 8RA

Entrance Hall

Double glazed door to the front and stairs to the first floor.

Lounge / Diner

Double glazed bay window to the front, open aperture into the kitchen, two radiators and a log burner.

Kitchen

Double glazed window and door to the rear, large skylight window, open aperture to the lounge/diner, wall and base units, work surfaces, electric oven and gas hob, extractor fan, stainless steel sink and drainer space for an under counter fridge and plumbing for a washing machine,



Landing

Access to the loft.

Bedroom One

Double glazed window to the rear and a radiator.

Bedroom Two

Double glazed window to the front and a radiator.

Bedroom Three

Double glazed window to the front and a radiator.

Bathroom

Bath with a shower over, WC, wash hand basin with vanity unit and a heated towel rail.

Front Garden

To the front the garden is enclosed by a fence and gate, with a path to the front door and the remainder laid to lawn.

Parking

On street parking.

Rear Garden

To the rear the garden is laid to patio with two sheds and access to the garden from the rear.



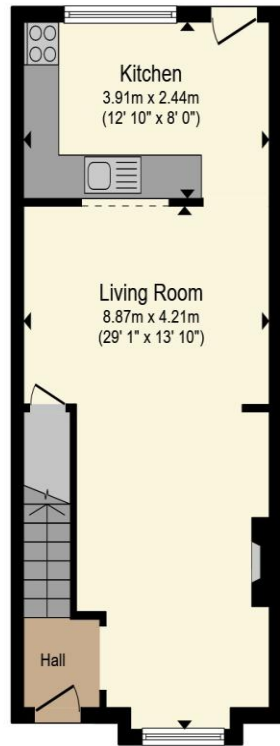

Ground Floor

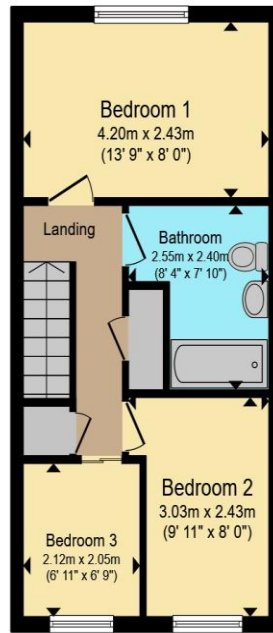

First Floor

Total floor area 74.8 m² (805 sq.ft.) approx

This floor plan is for illustrative purposes only. It is not drawn to scale. Any measurements, floor areas (including any total floor area), openings and orientation are approximate. No details are guaranteed, they cannot be relied upon for any purpose and they do not form part of any agreement. No liability is taken for any error, omission or misstatement. A party must rely upon its own inspection(s). Powered by www.propertybox.io



To view this property please contact Connells on

T 01747 854 001
E shaftesbury@connells.co.uk

34 High Street
 SHAFTESBURY SP7 8JG

Property Ref: SFT306295 - 0009

Tenure:Freehold EPC Rating: C

Council Tax Band: B

view this property online
connells.co.uk/Property/SFT306295



1. MONEY LAUNDERING REGULATIONS Intending purchasers will be asked to produce identification documentation at a later stage and we would ask for your co-operation in order that there will be no delay in agreeing the sale. 2. These particulars do not constitute part or all of an offer or contract. 3. The measurements indicated are supplied for guidance only and as such must be considered incorrect. Potential buyers are advised to recheck measurements before committing to any expense. 4. We have not tested any apparatus, equipment, fixtures, fittings or services and it is in the buyers interest to check the working condition of any appliances.

Connells Residential is registered in England and Wales under company number 1489613, Registered Office is Cumbria House, 16-20 Hockliffe Street, Leighton Buzzard, Bedfordshire, LU7 1GN. VAT Registration Number is 500 2481 05.

see all our properties at www.connells.co.uk | www.rightmove.co.uk | www.zoopla.co.uk