



Connells

East Gomeldon Road
Gomeldon Salisbury



Property Description

This charming detached Chalet Bungalow is set within generous private grounds and offers well-maintained, low-maintenance gardens to both the front and rear. With a wealth of space and versatility the property is a fantastic opportunity to move into this desirable semi-rural location.

Gomeldon is a charming and highly sought-after village located on the outskirts of Salisbury, offering an attractive blend of rural tranquillity and convenient access to the city. Surrounded by picturesque Wiltshire countryside, the village provides a peaceful setting while remaining well connected, with easy road links to Salisbury, Amesbury and the A303.

Porch

Entrance Hall

L shaped hall with doors to lounge, bedroom three and two, bathroom and kitchen, stairs to first floor landing.

Lounge

27' 2" x 14' 2" (8.28m x 4.32m)

Dual aspect to front and side, French doors to the front.

Bedroom Two

12' x 9' 3" (3.66m x 2.82m)

Side aspect.

Bedroom Three

11' x 9' 10" (3.35m x 3.00m)

Side aspect.

Kitchen

15' 1" x 10' 1" (4.60m x 3.07m)

Comprising wall and base units with work surfaces over, drainer sink unit with mixer taps, space for cooker unit, under work surface space for fridge, dishwasher and washing machine, door to rear lean-to porch and dining room, dual aspect to side and rear.

Dining Room

12' x 9' 1" (3.66m x 2.77m)

Rear aspect.

Bathroom

Comprising a panel enclosed bath, pedestal wash hand basin, WC and storage cupboard.

First Floor Landing

Bedroom One

11' 3" x 8' 9" (3.43m x 2.67m)

Side aspect.

Bedroom Four

8' 2" x 7' 7" (2.49m x 2.31m)

Rear aspect.

Shower Room

Comprising double shower unit, pedestal wash hand basin and WC.

Outside

Rear Garden

The property enjoys a charming and thoughtfully arranged rear garden, offering a private and versatile outdoor space ideal for both relaxation and entertaining. Predominantly laid to decorative gravel for ease of maintenance, the garden is centred around an attractive circular paved seating area, creating a perfect spot for al fresco dining and social gatherings. The garden is bordered by a variety of mature shrubs, established planting beds and trees, adding greenery and seasonal interest throughout.

To the rear, a useful range of outbuildings and sheds offer excellent storage and potential for workshop use, complemented by a greenhouse and water butts for keen gardeners.

Overall, the garden strikes a wonderful balance between practicality and charm, presenting a low-maintenance yet highly usable outdoor space with a good degree of privacy.



Front Garden

An enclosed front garden offering both privacy and strong kerb appeal. Accessed via a traditional five-bar gate, the driveway provides ample off-road parking. A circular paved seating area, complemented by mature hedging, established planting, and decorative planters. Gated access to the rear garden.

Driveway

Access from the main road with ample parking.

Garage

With up and over door approached by the driveway.









Ground Floor

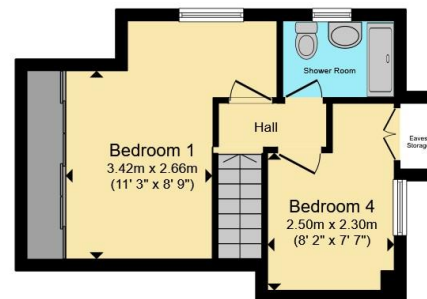

First Floor

Total floor area 129.5 m² (1,394 sq.ft.) approx

This floor plan is for illustrative purposes only. It is not drawn to scale. Any measurements, floor areas (including any total floor area), openings and orientation are approximate. No details are guaranteed, they cannot be relied upon for any purpose and they do not form part of any agreement. No liability is taken for any error, omission or misstatement. A party must rely upon its own inspection(s). Powered by www.propertybox.io



To view this property please contact Connells on

T 01722 328 562
E salisbury@connells.co.uk

46-50 Castle Street
 Salisbury SP1 3TS

EPC Rating: D Council Tax
 Band: D

Tenure: Freehold

view this property online connells.co.uk/Property/SAL308438



1. MONEY LAUNDERING REGULATIONS Intending purchasers will be asked to produce identification documentation at a later stage and we would ask for your co-operation in order that there will be no delay in agreeing the sale. 2. These particulars do not constitute part or all of an offer or contract. 3. The measurements indicated are supplied for guidance only and as such must be considered incorrect. Potential buyers are advised to recheck measurements before committing to any expense. 4. We have not tested any apparatus, equipment, fixtures, fittings or services and it is in the buyers interest to check the working condition of any appliances.

Connells Residential is registered in England and Wales under company number 1489613, Registered Office is Cumbria House, 16-20 Hockliffe Street, Leighton Buzzard, Bedfordshire, LU7 1GN. VAT Registration Number is 500 2481 05.

See all our properties at www.connells.co.uk | www.rightmove.co.uk | www.zoopla.co.uk

Property Ref: SAL308438 - 0006