



Apartment 76 Waterside Court, The Colonnade, Maidenhead SL6 1DL

welcome to

Apartment 76 Waterside Court, The Colonnade, Maidenhead

A beautifully presented modern two-bedroom apartment situated within the highly regarded Waterside Quarter development in Maidenhead. Offering stylish contemporary living throughout, this impressive home is ideally suited to first-time buyers, professionals and investors alike.





Waterside Court, The Colonnade, Maidenhead, SL6

Approximate Area = 761 sq ft / 70.6 sq m

For identification only - Not to scale

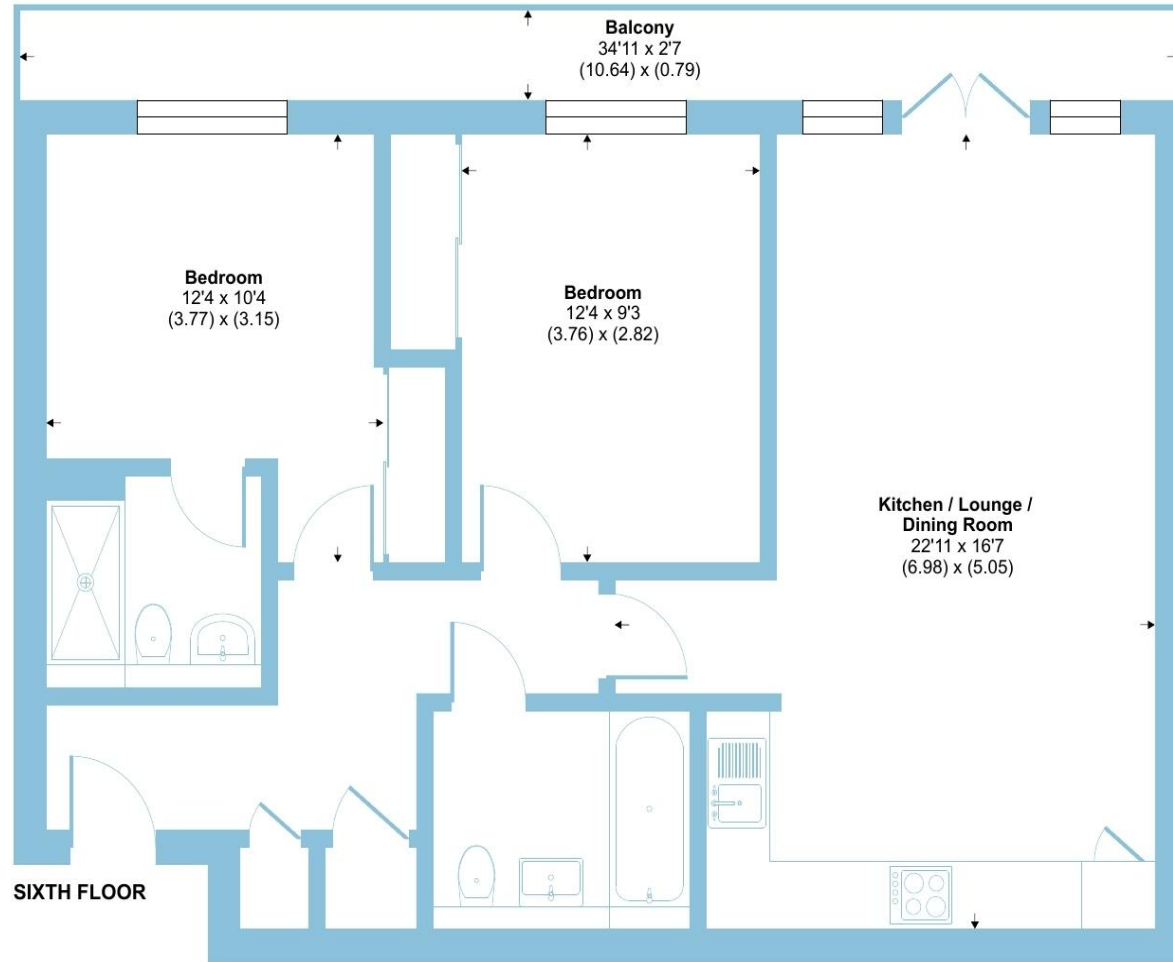

The property features a bright and spacious open-plan living and dining area, complemented by a sleek modern kitchen with integrated appliances and high-quality finishes. There are two well-proportioned bedrooms, including a generous principal bedroom with an en-suite shower room, alongside a modern bathroom finished to a high standard. There is a large balcony spanning the width of the property and an allocated parking space.

Residents of Waterside Quarter benefit from an attractive riverside setting and well-maintained communal areas, while the property is conveniently located for Maidenhead town centre, the Elizabeth Line, local amenities and scenic walks along the River Thames.

Combining modern design, a sought-after development and excellent transport connections, this superb apartment offers an exceptional opportunity to enjoy contemporary living in one of Maidenhead's most desirable locations.

welcome to

Apartment 76 Waterside Court

- BEAUTIFULLY PRESENTED
- STYLISH CONTEMPORARY LIVING
- SLEEK MODERN KITCHEN
- TWO WELL-PROPORTIONED BEDROOMS
- MODERN BATHROOM & EN-SUITE SHOWER ROOM
- FULL WIDTH BALCONY, ALLOCATED PARKING SPACE
- SOUGHT-AFTER DEVELOPMENT
- TOWN CENTRE LOCATION

Tenure: Leasehold EPC Rating: B

Council Tax Band: C Service Charge: 2956.22

Ground Rent: 606.20

This is a Leasehold property with details as follows; Term of Lease 250 years from 01 Jul 2020. Should you require further information please contact the branch. Please Note additional fees could be incurred for items such as Leasehold packs.

guide price

£425,000



Please note the marker reflects the postcode not the actual property

check out more properties at rogerplatt.co.uk



Property Ref:
MHD123767 - 0001

1. MONEY LAUNDERING REGULATIONS Intending purchasers will be asked to produce identification documentation at a later stage and we would ask for your co-operation in order that there is no delay in agreeing the sale. 2. These particulars do not constitute part or all of an offer or contract. 3. The measurements indicated are supplied for guidance only and as such must be considered incorrect. Potential buyers are advised to recheck measurements before committing to any expense. 4. We have not tested any apparatus, equipment, fixtures or services and it is in the buyers interest to check the working condition of any appliances. 5. Where an EPC, or a Home Report (Scotland only) is held for this property, it is available for inspection at the branch by appointment. If you require a printed version of a Home Report, you will need to pay a reasonable production charge reflecting printing and other costs. 6. We are not able to offer an opinion either written or verbal on the content of these reports and this must be obtained from your legal representative. 7. Whilst we take care in preparing these reports, a buyer should ensure that his/her legal representative confirms as soon as possible all matters relating to title including the extent and boundaries of the property and other important matters before exchange of contracts.

Roger Platt is a trading name of Sequence (UK) Limited which is registered in England and Wales under company number 4268443, Registered Office is Cumbria House, 16-20 Hockliffe Street, Leighton Buzzard, Bedfordshire, LU7 1GN. VAT Registration Number is 500 2481 05.

roger platt



01628 773333



Maidenhead@rogerplatt.co.uk



25-29 Queen Street, MAIDENHEAD, Berkshire,
SL6 1NB



rogerplatt.co.uk