



## 51 Visage Apartments Winchester Road

, London, NW3 3ND

**£3,400 Per month**

A stunning two double bedroom apartment situated within this popular ported development. The property comprises a spacious reception room with a modern open plan kitchen, floor to ceiling windows with a sliding door leading to a private balcony, two double bedrooms with fitted wardrobes and a beautiful tiled bathroom.

Further benefits include underground parking and just a 1 minute walk from Swiss Cottage Station.

- 2 Double Bedrooms
- 2 Modern Bathrooms
- Underground Parking
- Concierge
- Available 29th of June 2026
- Close to Swiss Cottage Station
- Furnished

### Viewing

Please contact us on 020 3198 4517 if you wish to arrange a viewing appointment for this property or require further information.



2



2



1



B

## Floor Plan

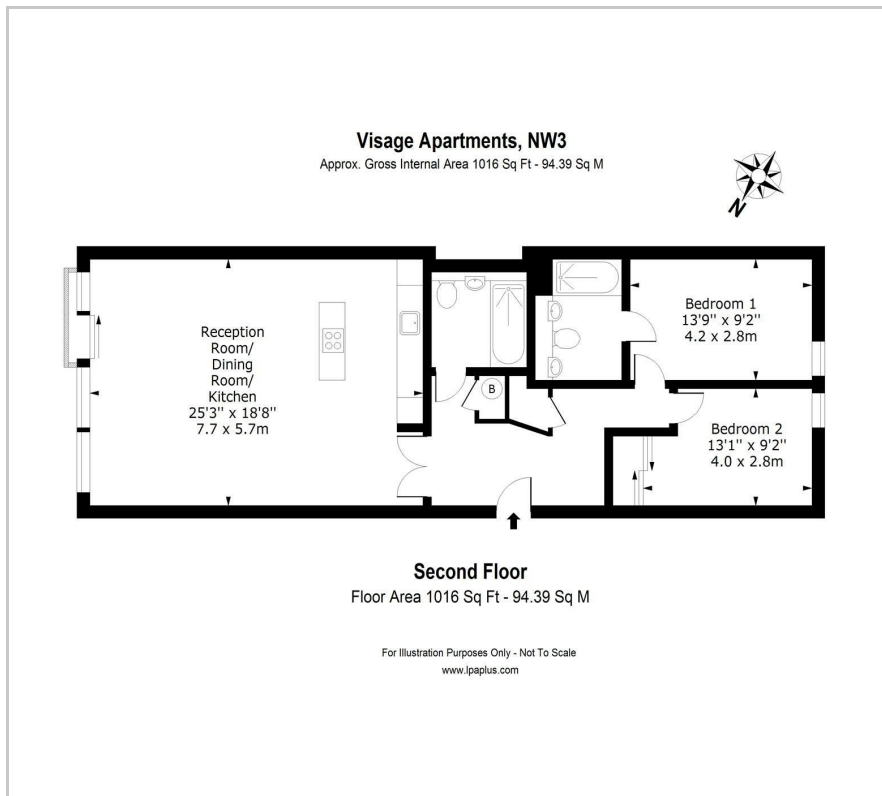

## Area Map

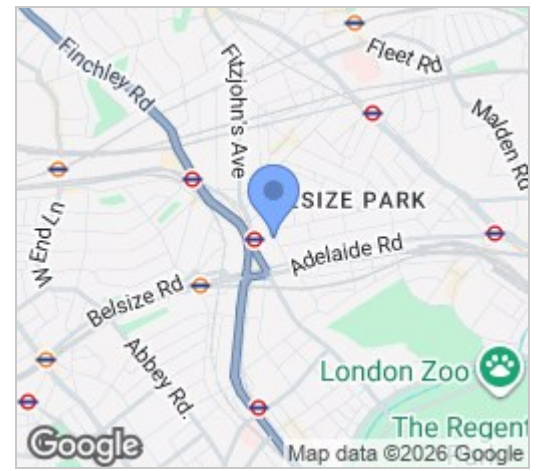

## Energy Efficiency Graph

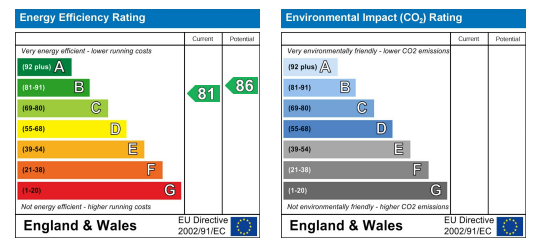

These particulars, whilst believed to be accurate are set out as a general outline only for guidance and do not constitute any part of an offer or contract. Intending purchasers should not rely on them as statements of representation of fact, but must satisfy themselves by inspection or otherwise as to their accuracy. No person in this firm's employment has the authority to make or give any representation or warranty in respect of the property.