



**Lothersdale, Heelands, Milton Keynes, MK13 7NF**



**welcome to**

## **Lothersdale, Heelands, Milton Keynes**

Situated in the popular residential area of Heelands, this well-presented three-bedroom semi-detached property on Lothersdale offers a fantastic opportunity for families, first-time buyers, or investors alike.

### **Entrance Hall**

Double-glazed door to the front and stairs to the first floor. Doors to the cloakroom and the kitchen. Opens into the lounge.

### **Cloakroom**

Wash hand basin and low-level WC. Radiator and double-glazed obscured window to the side.

### **Kitchen**

Fitted with a mix of wall and base units with work top over, sink with drainer, eye-level electric oven and microwave plus a gas hob with extractor fan over. Integrated dishwasher. Space for a fridge/freezer. Space for a dining table and chairs, LVT flooring, vertical radiator and double-glazed window to the front.

### **Lounge**

TV point, vertical radiator, LVT flooring and double-glazed window to the rear. Double-glazed doors leading out to the garden.

### **First Floor Landing**

Stairs from the ground floor, storage cupboard and carpet. Doors to all bedrooms and the family bathroom.

### **Bedroom One**

Built-in wardrobes with hanging space and storage, carpet, radiator and double-glazed window to the front.

### **Bedroom Two**

Built-in wardrobes with hanging space and storage, carpet, radiator and double-glazed window to the rear.

### **Bedroom Three**

Radiator, carpet and double-glazed window to the rear.

### **Bathroom**

Fully tiled with a pedestal wash hand basin with mixer tap, low-level WC and a bath with a shower screen and shower over. Heated towel rail and double-glazed obscured window.

### **Outside Front Garden**

Storage cupboard and a path leading to the front door.

### **Rear Garden**

Enclosed by a brick wall and fencing the garden is mainly laid with gravel and a small patio area. Driveway leading to the garage.

### **Garage**

Garage with up & over door, central heating boiler and power.



**Ground Floor**

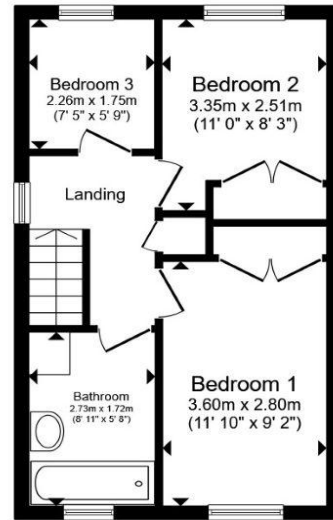

**First Floor**

Total floor area 81.7 m<sup>2</sup> (879 sq.ft.) approx

This floor plan is for illustrative purposes only. It is not drawn to scale. Any measurements, floor areas (including any total floor area), openings and orientation are approximate. No details are guaranteed, they cannot be relied upon for any purpose and they do not form part of any agreement. No liability is taken for any error, omission or misstatement. A party must rely upon its own inspection(s). Powered by [www.propertybox.io](http://www.propertybox.io)



**welcome to**  
**Lothersdale,**  
**Heelands, Milton Keynes**

- THREE-BEDROOM SEMI-DETACHED
- LOCATED IN THE HEELANDS AREA
- LIVING ROOM WITH AMPLE LIGHT
- MODERN KITCHEN
- GARAGE/DRIVEWAY

Tenure: Freehold EPC Rating: D  
Council Tax Band: B

guide price

**£340,000**



**view this property online** [brownandmerry.co.uk/Property/NPL108101](https://www.brownandmerry.co.uk/Property/NPL108101)



Property Ref:  
NPL108101 - 0005

1. MONEY LAUNDERING REGULATIONS Intending purchasers will be asked to produce identification documentation at a later stage and we would ask for your co-operation in order that there is no delay in agreeing the sale. 2. These particulars do not constitute part or all of an offer or contract. 3. The measurements indicated are supplied for guidance only and as such must be considered incorrect. Potential buyers are advised to recheck measurements before committing to any expense. 4. We have not tested any apparatus, equipment, fixtures or services and it is in the buyers interest to check the working condition of any appliances. 5. Where an EPC, or a Home Report (Scotland only) is held for this property, it is available for inspection at the branch by appointment. If you require a printed version of a Home Report, you will need to pay a reasonable production charge reflecting printing and other costs. 6. We are not able to offer an opinion either written or verbal on the content of these reports and this must be obtained from your legal representative. 7. Whilst we take care in preparing these reports, a buyer should ensure that his/her legal representative confirms as soon as possible all matters relating to title including the extent and boundaries of the property and other important matters before exchange of contracts.

Brown & Merry is a trading name of Sequence (UK) Limited which is registered in England and Wales under company number 4268443, Registered Office is Cumbria House, 16-20 Hockliffe Street, Leighton Buzzard, Bedfordshire, LU7 1GN. VAT Registration Number is 500 2481 05.

  
brown & merry



**01908 611242**



[newportpagnell@brownandmerry.co.uk](mailto:newportpagnell@brownandmerry.co.uk)



74A High Street, Newport Pagnell, MILTON  
KEYNES, Buckinghamshire, MK16 8AQ



**[brownandmerry.co.uk](https://www.brownandmerry.co.uk)**