



Webb Close, Oundle Peterborough
Guide Price **£525,000 - £575,000** Freehold

**Sharman
Quinney**

Key Features



- ***NO ONWARD CHAIN***
- Sought after area of Oundle,
- Double garage and driveway,
- Three reception rooms,
- Master bedroom benefits from an en-suite

This well-presented four-bedroom detached home is situated in a highly sought-after location of Oundle and offers spacious, versatile accommodation ideal for modern family living. The property is offered to the market with no onward chain, allowing for a smooth and straightforward purchase.

The house is in very good condition throughout and features three reception rooms, providing flexible living and entertaining space to suit a variety of needs. Externally, the property benefits from a large driveway offering ample off-road parking, along with a double garage fitted with electric roller doors, adding both convenience and security. A particular highlight is the professionally boarded and insulated loft, complete with a fitted ladder, offering excellent additional storage space.



With its desirable location, generous parking, and well-cared-for interior, this property represents an excellent opportunity for families or buyers seeking a quality detached home in a prime area.



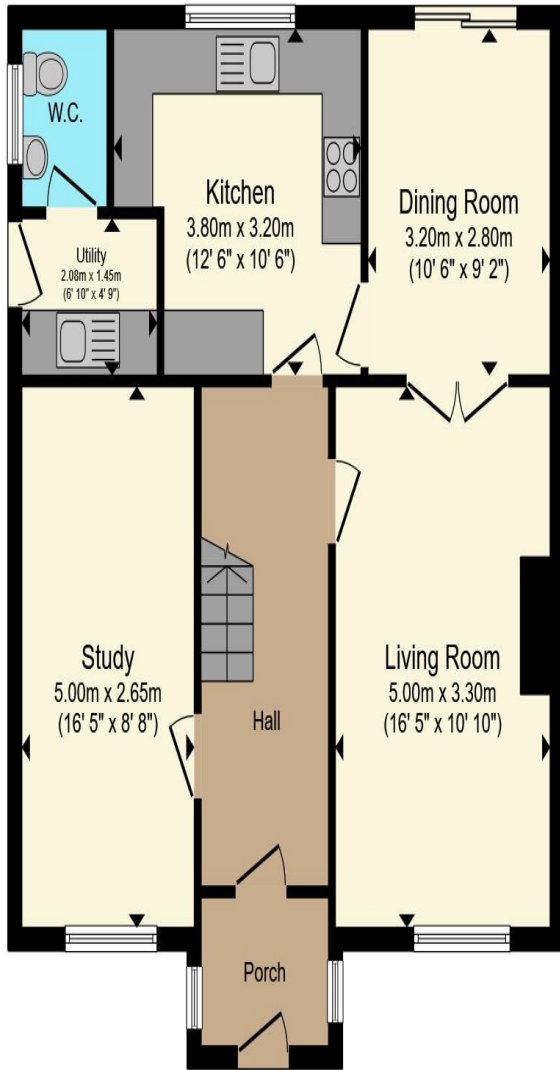

Ground Floor

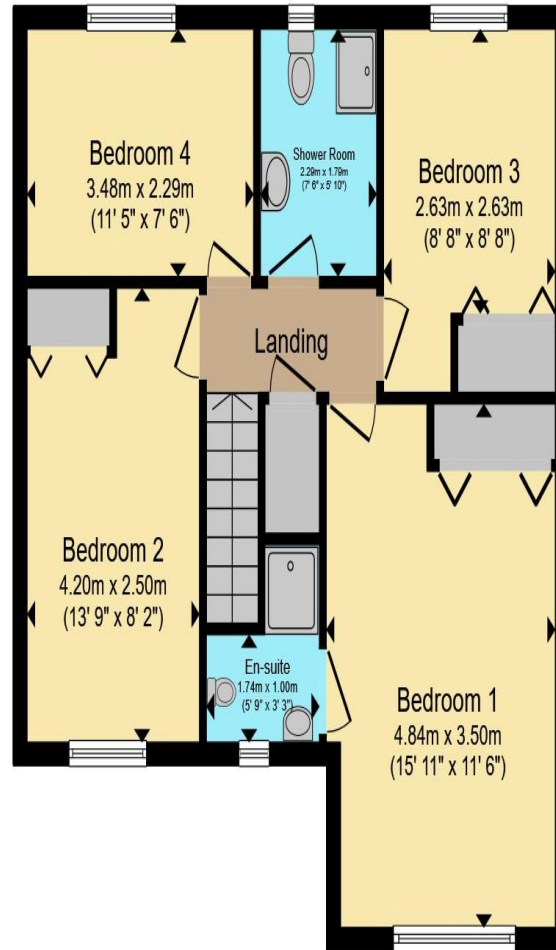

First Floor

Total floor area 128.5 m² (1,383 sq.ft.) approx

This floor plan is for illustrative purposes only. It is not drawn to scale. Any measurements, floor areas (including any total floor area), openings and orientation are approximate. No details are guaranteed, they cannot be relied upon for any purpose and they do not form part of any agreement. No liability is taken for any error, omission or misstatement. A party must rely upon its own inspection(s). Powered by www.propertybox.io

**Sharman
Quinney**

To view this property call Sharman Quinney on:
01832 274567

Selling your property?

Contact us to arrange a **FREE** home valuation.

 01832 274567

 The Old Town Hall Market Place, Oundle, Peterborough, Cambridgeshire, PE8 4BQ

 oundle@sharmanquinney.co.uk

 www.sharmanquinney.co.uk



 SCAN ME



Sharman Quinney Holdings Limited is registered in England and Wales under company number 4174227, Registered Office is Cumbria House, 16-20 Hockliffe Street, Leighton Buzzard, Bedfordshire, LU7 1GN. VAT Registration Number is 500 2481 05.

1: These particulars do not constitute part or all of an offer or contract. 2: The measurements indicated are supplied for guidance only and as such must be considered incorrect. 3: Potential buyers are advised to recheck the measurements before committing to any expense. 4: Sharman Quinney has not tested any apparatus, equipment, fixtures, fittings or services and it is the buyers interests to check the working condition of any appliances. 5: Sharman Quinney has not sought to verify the legal title of the property and buyers must obtain verification from their legal representative. 6: Intending purchasers will be asked to produce identification documentation at a later stage and we would ask your co-operation in order that there will be no delay in agreeing the sale. Ref: OUN202803 - 0007

