



Herbert Street, Old Town, HP2 5HP **Per month £1,950 Per month**

A well presented and IMPOSING period home with SPACIOUS accommodation spanning in excess of 1100 SQFT. The layout includes an entrance area, living room, dining room, fitted kitchen, basement, three first floor DOUBLE bedrooms and a LUXURIOUS family bathroom. Externally the property offers an area of garden. Contact SOLE lettings agents Sears & Co to arrange your viewing. Available July 2026. Unfurnished. Council tax band D.



Sears & Co

www.searsandco.co.uk call: 01442 254 100



Sears & Co

www.searsandco.co.uk call: 01442 254 100

Ground Floor

Approx. 52.9 sq. metres (569.8 sq. feet)



First Floor

Approx. 51.7 sq. metres (556.7 sq. feet)

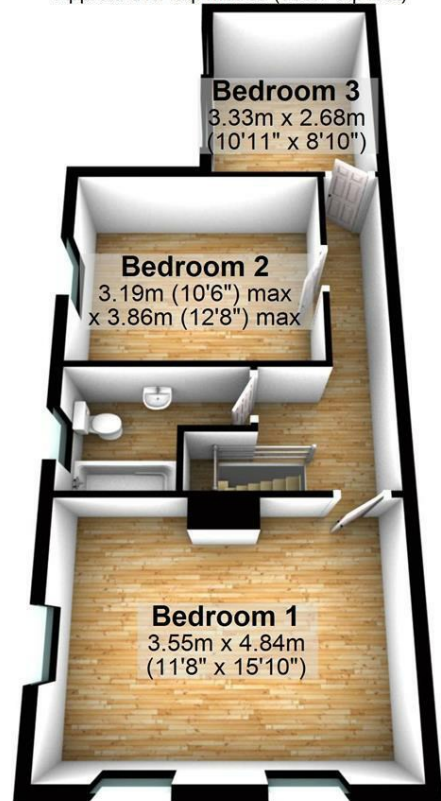

All measurements and information on this plan are approximate and the plan itself is provided for illustrative purposes only.

Plan produced using PlanUp.

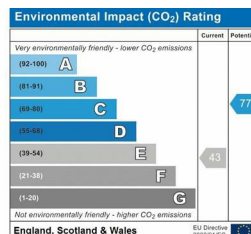
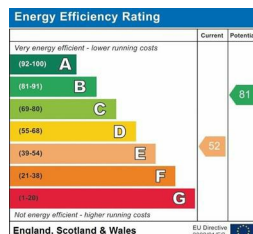

The Agent has not tested any apparatus, equipment, fixtures and fittings or services and so cannot verify that they are in working order or fit for the purpose. A Buyer is advised to obtain verification from their Solicitor or Surveyor. References to the Tenure of a Property are based on information supplied by the Seller. The Agent has not had sight of the title documents. A Buyer is advised to obtain verification from their Solicitor.

Items shown in photographs are NOT included unless specifically mentioned within the sales particulars. They may however be available by separate negotiation.

Buyers must check the availability of any property and make an appointment to view before embarking on any journey to see a property.

For further information see the Property Misdescriptions Act.

www.searsandco.co.uk

Sears & Co

Hemel Hempstead Office: 67 High Street, Old Town, Hemel Hempstead, Hertfordshire, HP1 3AF

call: 01442 254 100