



Connells

Harvesters
St. Albans



Property Description

A spacious and well-presented ground floor studio apartment, ideally located in the popular Jersey Farm area of St Albans, offering a perfect opportunity for first-time buyers, downsizers, or investors.

The property benefits from its own private entrance, adding a sense of independence and convenience. Inside, the studio is thoughtfully laid out to maximise space, with a bright and comfortable living/sleeping area enjoying pleasant views over the communal gardens. There is also ample storage, ensuring the space remains functional and uncluttered.

Residents have access to a large, well-maintained communal garden, perfect for relaxing or enjoying the outdoors, while the inclusion of allocated parking provides added practicality. Further benefits include low maintenance charges, making this an attractive and cost-effective home or investment.

Situated within easy walking distance of local shops and amenities, the property is well-positioned for day-to-day convenience, with excellent access to surrounding areas.



Reception Room/Bedroom

17' 8" max x 11' 2" max (5.38m max x 3.40m max)

Kitchen

9' 5" max x 5' 5" max (2.87m max x 1.65m max)

Bathroom

6' 9" max x 5' 8" max (2.06m max x 1.73m max)



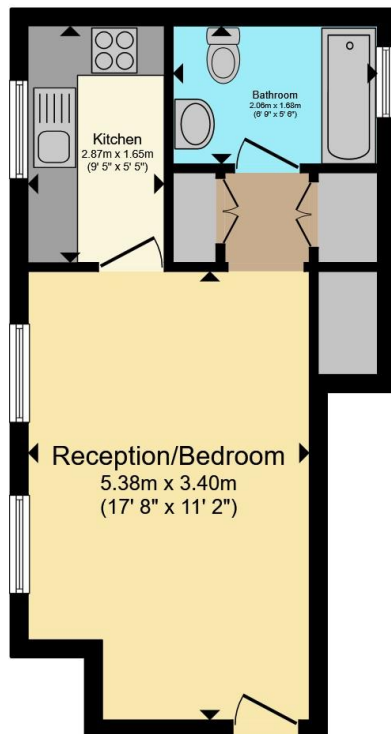

Total floor area 31.2 m² (336 sq.ft.) approx

This floor plan is for illustrative purposes only. It is not drawn to scale. Any measurements, floor areas (including any total floor area), openings and orientation are approximate. No details are guaranteed, they cannot be relied upon for any purpose and they do not form part of any agreement. No liability is taken for any error, omission or misstatement. A party must rely upon its own inspection(s). Powered by www.propertybox.io



To view this property please contact Connells on

T 01727 851 100
E marshalswick@connells.co.uk

5 Wycombe Place The Quadrant Marshalswick
 ST ALBANS AL4 9RH

EPC Rating: C Council Tax Band: B

Service Charge: Ask Agent

Ground Rent: 100.00

Tenure: Leasehold

view this property online connells.co.uk/Property/MWK306316

This is a Leasehold property with details as follows; Term of Lease 125 years from 01 Apr 1989. Should you require further information please contact the branch. Please Note additional fees could be incurred for items such as Leasehold packs.



1. MONEY LAUNDERING REGULATIONS Intending purchasers will be asked to produce identification documentation at a later stage and we would ask for your co-operation in order that there will be no delay in agreeing the sale. 2. These particulars do not constitute part or all of an offer or contract. 3. The measurements indicated are supplied for guidance only and as such must be considered incorrect. Potential buyers are advised to recheck measurements before committing to any expense. 4. We have not tested any apparatus, equipment, fixtures, fittings or services and it is in the buyers interest to check the working condition of any appliances.

Connells Residential is registered in England and Wales under company number 1489613, Registered Office is Cumbria House, 16-20 Hockliffe Street, Leighton Buzzard, Bedfordshire, LU7 1GN. VAT Registration Number is 500 2481 05.

See all our properties at www.connells.co.uk | www.rightmove.co.uk | www.zoopla.co.uk

Property Ref: MWK306316 - 0004