



**Chase Side, Enfield, EN2 0QX**

**welcome to**

## **Chase Side, Enfield**

Beautifully presented spacious and extended four bedroom family house situated in this popular residential tree lined turning adjacent to and with views over St Michael's Green, within close proximity of local shops, schools (St Michael's, Chase Side Primary, Wren Academy and One Degree), Hillyfields Country Park, Gordon Hill Rail Station (Moorgate Line) and within easy access of Enfield Town with its multiple shopping facilities and the M25 Motorway.

The property has been beautifully modernised and extended by the current vendor and is well presented throughout and has many pleasing features.



### Entrance Hall

Solid wood floor, double radiator with cover over, sunken spotlights to ceiling, understairs storage/meter cupboard.

### Lounge

12' 10" into bay x 12' 2" ( 3.91m into bay x 3.71m )  
Solid wood floor, cast iron wood burner, inset to fire recess, double radiator, sunken spotlights to ceiling, glazed doors to kitchen/breakfast/diner.

### Kitchen / Breakfast / Diner

23' 5" max x 16' 9" max ( 7.14m max x 5.11m max )  
Beautifully fitted in a range of gloss white base and wall cupboards, matching island with wooden worksurface, integrated double oven, grill and dishwasher, one and half bowl stainless steel sink and drainer inset to wooden worksurface, space for American style fridge-freezer, electric hob with extractor fan over, breakfast bar, bi-folds to west facing rear garden, part vaulted ceiling with three Velux fan light windows, solid wood floor, three double radiators, sunken spotlights to ceiling.

### Cloakroom / WC

Low flush WC, bracket basin with cupboards under, extractor fan, sunken spotlights to ceiling, ceramic tiled floor.

### First Floor

#### Landing

Fitted carpet, spotlights to ceiling, stairs to second floor.

#### Bedroom

12' 10" x 10' 10" ( 3.91m x 3.30m )  
Fitted carpet, double radiator, sunken spotlights to ceiling.

#### Bedroom

11' 10" x 9' 7" ( 3.61m x 2.92m )  
Fitted carpet, double radiator, sunken spotlights to ceiling, two sets of built-in wardrobe cupboards.



**view this property online** [barnfields.co.uk/Property/ENF100161](http://barnfields.co.uk/Property/ENF100161)



### Bedroom

7' 5" x 6' 10" ( 2.26m x 2.08m )  
Fitted carpet, double radiator, sunken spotlights to ceiling.

### Bathroom

8' 6" x 8' 2" ( 2.59m x 2.49m )  
Beautifully fitted comprising panelled bath with central mixer tap, shower attachment, low flush WC with concealed cistern, glass shower cubicle, vanity basin with central waterfall mixer tap, cupboard under, fully tiled walls and floor, heated towel rail, sunken spotlights to ceiling, high level storage cupboard over bath, cupboard housing combination boiler.

### Second Floor

#### Dual Aspect Master Bedroom

18' 3" max x 11' 10" max ( 5.56m max x 3.61m max )  
Solid wood floor, eaves storage cupboards, built-in wardrobe cupboards, Velux to front aspect, sunken spotlights to ceiling, double glazed French windows to Juliet balcony (west facing), door to en-suite.

#### En-Suite Shower Room

Low flush WC, vanity basin with mixer tap over, cupboard under, large double walk-in shower with glass screen, heated towel rail, radiator, shaver point, extractor fan, sunken spotlights to ceiling, fully tiled walls and floor.

#### Outside

##### Front Garden

Retaining wall, laid to lawn with flower and shrub beds.

##### Rear Garden

West facing, laid to lawn with flower and shrub beds, large summer house/office with power and light, rear vehicular access.







welcome to

## Chase Side, Enfield

- 23' Kitchen / Breakfast / Diner
- West Facing Rear Garden
- Four Good Sized Bedrooms
- 18' Master Bedroom
- En-Suite To Master Bedroom

Tenure: Freehold EPC Rating: Awaited  
Council Tax Band: D

# £650,000



Please note the marker reflects the postcode not the actual property

check out more properties at [barnfields.co.uk](https://www.barnfields.co.uk)



Property Ref:  
ENF100161 - 0002

1. MONEY LAUNDERING REGULATIONS Intending purchasers will be asked to produce identification documentation at a later stage and we would ask for your co-operation in order that there is no delay in agreeing the sale. 2. These particulars do not constitute part or all of an offer or contract. 3. The measurements indicated are supplied for guidance only and as such must be considered incorrect. Potential buyers are advised to recheck measurements before committing to any expense. 4. We have not tested any apparatus, equipment, fixtures or services and it is in the buyers interest to check the working condition of any appliances. 5. Where an EPC, or a Home Report (Scotland only) is held for this property, it is available for inspection at the branch by appointment. If you require a printed version of a Home Report, you will need to pay a reasonable production charge reflecting printing and other costs. 6. We are not able to offer an opinion either written or verbal on the content of these reports and this must be obtained from your legal representative. 7. Whilst we take care in preparing these reports, a buyer should ensure that his/her legal representative confirms as soon as possible all matters relating to title including the extent and boundaries of the property and other important matters before exchange of contracts.

Barnfields is a trading name of Sequence (UK) Limited which is registered in England and Wales under company number 4268443, Registered Office is Cumbria House, 16-20 Hockliffe Street, Leighton Buzzard, Bedfordshire, LU7 1GN. VAT Registration Number is 500 2481 05.



GROUND FLOOR



Floor plan produced in accordance with RICS Property Measurement 2nd Edition, Incorporating International Property Measurement Standards (IPMS2 Residential). © richcom 2026. Produced for Barnard Marcus. REF: 1468002

## Chase Side, Enfield, EN2

Approximate Area = 1355 sq ft / 125.8 sq m  
Limited Use Area(s) = 42 sq ft / 3.9 sq m  
Outbuildings = 124 sq ft / 11.5 sq m  
Total = 1521 sq ft / 141.2 sq m  
For identification only - Not to scale



SECOND FLOOR

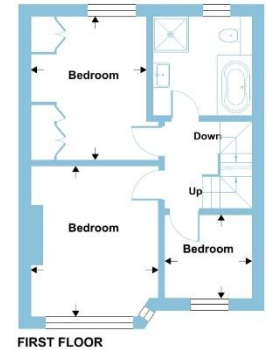

FIRST FLOOR



020 8363 3394



info@barnfields.com



1a Windmill Hill, Enfield, Middlesex, EN2 6SE



[barnfields.co.uk](https://www.barnfields.co.uk)