



**Turpins Close, Hertford, SG14 2EH**

## Welcome to Turpins Close, Hertford

This beautifully presented two double bedroom terraced family home is ideally positioned in a sought-after, quiet and peaceful location, just a short walk from Pangshanger Park, Hertford North station and Hertford town centre. Perfect for first-time buyers. The ground floor features a bright and spacious open-plan living and dining area, with direct access to a private and secluded rear garden-ideal for relaxing or entertaining. The garden also benefits from rear access and a large outdoor storage cupboard, adding practicality to the outdoor space. The modern kitchen is well-equipped with a range of built-in appliances, offering both style and functionality upstairs, the property comprises two generous double bedrooms, both benefiting from fitted wardrobes in the principal bedroom and ample storage in the second bedroom, including two large cupboards. A recently fitted contemporary family bathroom completes the first floor. Additional benefits include double glazing and gas central heating throughout.



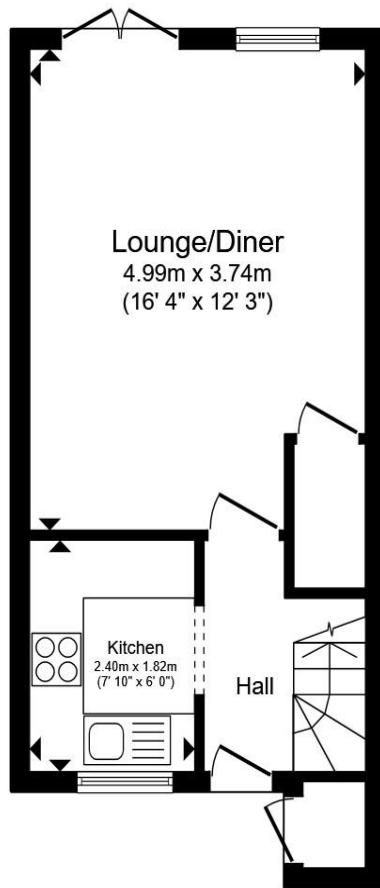

**Ground Floor**

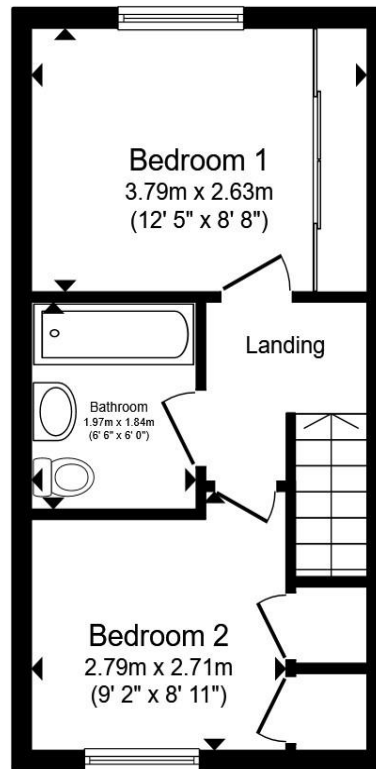

**First Floor**

Total floor area 56.7 m<sup>2</sup> (611 sq.ft.) approx

This floor plan is for illustrative purposes only. It is not drawn to scale. Any measurements, floor areas (including any total floor area), openings and orientation are approximate. No details are guaranteed, they cannot be relied upon for any purpose and they do not form part of any agreement. No liability is taken for any error, omission or misstatement. A party must rely upon its own inspection(s). Powered by [www.propertybox.io](http://www.propertybox.io)



**-Accommodation Overview-**

**Entrance Hall**

**Lounge / Diner**

16' 4" max x 12' 3" max ( 4.98m max x 3.73m max )

**Kitchen**

7' 10" x 6' ( 2.39m x 1.83m )

**-First Floor Landing-**

**Bedroom One**

12' 5" into cupboard x 8' 8" ( 3.78m into cupboard x 2.64m )

**Bedroom Two**

9' 2" x 8' 11" excluding cupboards ( 2.79m x 2.72m excluding cupboards )

**Bathroom**

**-Exterior-**

**Rear Garden**

**Parking**

**Outside Cupboard**

## Welcome to

### Turpins Close, Hertford

- Two Bedroom Terraced Family Home
- One Allocated Parking Space
- Low Maintenance Rear Garden
- Lounge / Diner With Direct Access To Garden
- Sought After SG14 Location

Tenure: Freehold

EPC Rating: C

Council Tax Band: C

Offers in excess of

# £375,000



Please note the marker reflects the postcode not the actual property

**view this property online** [williamhbrown.co.uk/Property/HFD108255](http://williamhbrown.co.uk/Property/HFD108255)



Property Ref:  
HFD108255 – 0002

1. MONEY LAUNDERING REGULATIONS Intending purchasers will be asked to produce identification documentation at a later stage and we would ask for your co-operation in order that there is no delay in agreeing the sale. 2. These particulars do not constitute part or all of an offer or contract. 3. The measurements indicated are supplied for guidance only and as such must be considered incorrect. Potential buyers are advised to recheck measurements before committing to any expense. 4. We have not tested any apparatus, equipment, fixtures or services and it is in the buyers interest to check the working condition of any appliances. 5. Where an EPC, or a Home Report (Scotland only) is held for this property, it is available for inspection at the branch by appointment. If you require a printed version of a Home Report, you will need to pay a reasonable production charge reflecting printing and other costs. 6. We are not able to offer an opinion either written or verbal on the content of these reports and this must be obtained from your legal representative. 7. Whilst we take care in preparing these reports, a buyer should ensure that his/her legal representative confirms as soon as possible all matters relating to title including the extent and boundaries of the property and other important matters before exchange of contracts.

William H Brown is a trading name of Sequence (UK) Limited which is registered in England and Wales under company number 4268443, Registered Office is Cumbria House, 16-20 Hockliffe Street, Leighton Buzzard, Bedfordshire, LU7 1GN. VAT Registration Number is 500 2481 05.



william h brown



**01992 586501**



[Hertford@williamhbrown.co.uk](mailto:Hertford@williamhbrown.co.uk)



21 Castle Street, HERTFORD, Hertfordshire,  
SG14 1ER



[williamhbrown.co.uk](http://williamhbrown.co.uk)