



**Hale Close, Ipswich, IP2 9QP**

**welcome to**

## **Hale Close, Ipswich**

This well-presented, 2nd floor apartment benefits from two double bedrooms, a large lounge, ample communal parking and attractive communal gardens and a garage en bloc. NO ONWARD CHAIN!

### **Entrance Hall**

Carpet flooring and a storage cupboard.

### **Lounge**

Open plan room with double glazed window to the front, carpet flooring, one storage radiator, TV point and ample space for a dining area.

### **Kitchen**

Eye and base level units in wood with stone effect worktop surfaces in grey, a circular, stainless steel sink plus drainer and chrome mixer tap, space for a washing machine and fridge/freezer, an integrated oven with electric hob, tiled splashback, tiled effect flooring and double glazed window to the front.

### **Master Bedroom**

Double glazed window to the rear, carpet flooring and one storage radiator.

### **Bedroom Two**

Double glazed window to the rear, carpet flooring and one storage radiator.

### **Bathroom**

Low level WC, pedestal wash hand basin, a bath with overhead shower, an airing cupboard and fully tiled walls and flooring.

### **Garage En Bloc**

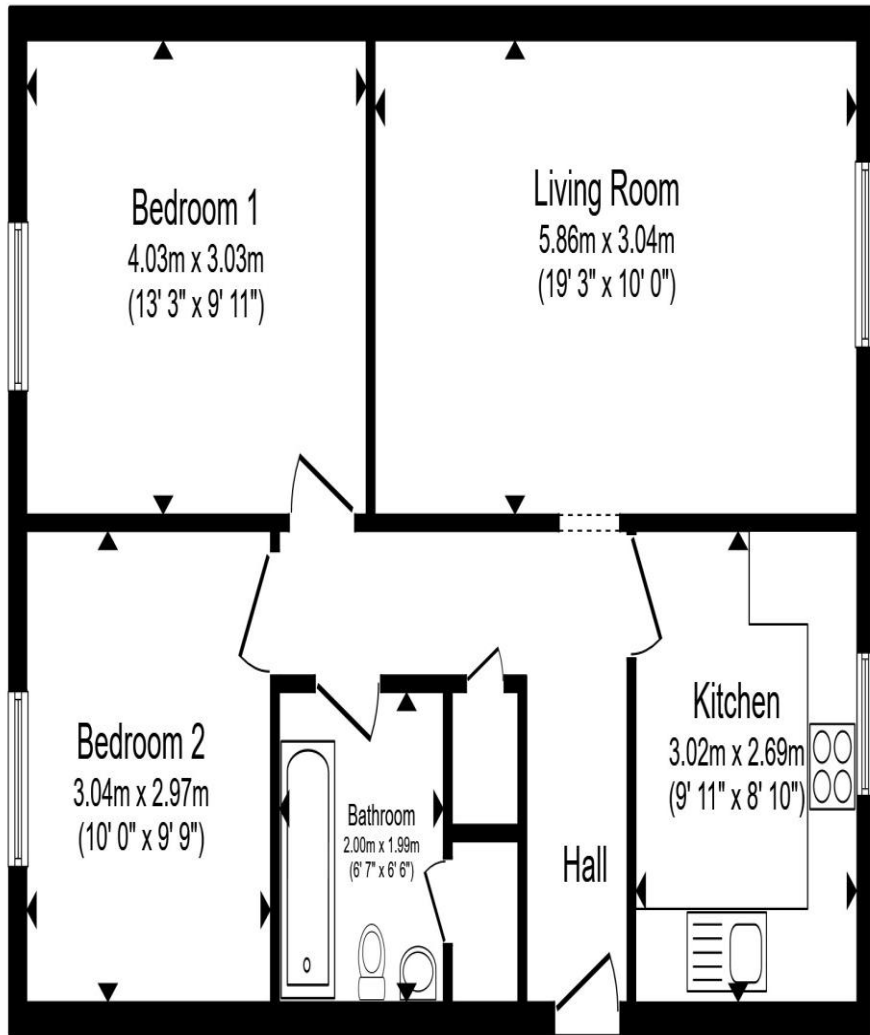

Total floor area 62.2 m<sup>2</sup> (669 sq.ft.) approx

This floor plan is for illustrative purposes only. It is not drawn to scale. Any measurements, floor areas (including any total floor area), openings and orientation are approximate. No details are guaranteed, they cannot be relied upon for any purpose and they do not form part of any agreement. No liability is taken for any error, omission or misstatement. A party must rely upon its own inspection(s). Powered by [www.propertybox.io](http://www.propertybox.io)



**welcome to**  
**Hale Close,**  
**Ipswich**

- No onward chain
- 2nd floor apartment
- Two double bedrooms
- Large lounge
- Ample communal parking & garage en bloc

Tenure: Leasehold EPC Rating: E

Council Tax Band: A Service Charge: 960.00

Ground Rent: 175.00

This is a Leasehold property with details as follows; Term of Lease 125 years from 29 Sep 2012. Should you require further information please contact the branch. Please Note additional fees could be incurred for items such as Leasehold packs.

**£125,000**



**view this property online** [williamhbrown.co.uk/Property/IPS121356](http://williamhbrown.co.uk/Property/IPS121356)



Property Ref:  
IPS121356 - 0003

1. MONEY LAUNDERING REGULATIONS Intending purchasers will be asked to produce identification documentation at a later stage and we would ask for your co-operation in order that there is no delay in agreeing the sale. 2. These particulars do not constitute part or all of an offer or contract. 3. The measurements indicated are supplied for guidance only and as such must be considered incorrect. Potential buyers are advised to recheck measurements before committing to any expense. 4. We have not tested any apparatus, equipment, fixtures or services and it is in the buyers interest to check the working condition of any appliances. 5. Where an EPC, or a Home Report (Scotland only) is held for this property, it is available for inspection at the branch by appointment. If you require a printed version of a Home Report, you will need to pay a reasonable production charge reflecting printing and other costs. 6. We are not able to offer an opinion either written or verbal on the content of these reports and this must be obtained from your legal representative. 7. Whilst we take care in preparing these reports, a buyer should ensure that his/her legal representative confirms as soon as possible all matters relating to title including the extent and boundaries of the property and other important matters before exchange of contracts.

William H Brown is a trading name of Sequence (UK) Limited which is registered in England and Wales under company number 4268443, Registered Office is Cumbria House, 16-20 Hockliffe Street, Leighton Buzzard, Bedfordshire, LU7 1GN. VAT Registration Number is 500 2481 05.



**william h brown**



**01473 226101**



[ipswich@williamhbrown.co.uk](mailto:ipswich@williamhbrown.co.uk)



16-18 Wolsey House, Princes Street, IPSWICH,  
Suffolk, IP1 1QT



**[williamhbrown.co.uk](http://williamhbrown.co.uk)**