

**ALLDAY
& MILLER**



Azalea Walk, Pinner, HA5 2EH
£600,000

4 2 1 C



Azalea Walk, Pinner, HA5 2EH

£600,000

- Town House
- Four Bedrooms
- Off Street Parking
- Private Rear Garden
- Walking Distance To Met/Piccadilly Line
- Family Home
- Two Bathrooms
- Garage
- Chain Free
- Catchment Area For Excellent Schools

Description

This well-arranged home offers accommodation set across three floors, providing flexible living space.

The ground floor comprises a bedroom, a useful utility room, a downstairs WC and a bathroom.

To the first floor, the property features a spacious reception and dining room along with a fitted kitchen.

The second floor enjoys three bedrooms and a family bathroom.

Externally, the property benefits from parking and a garage, as well as a private rear garden offering outdoor space to relax or entertain.

Situation

Situated on a quiet residential cul-de-sac, Azalea Walk enjoys a peaceful yet highly convenient setting in one of the area's most sought-after family neighbourhoods. The property is within approximately 0.6 miles of Eastcote Underground Station, providing excellent connections into Central London via the Metropolitan and Piccadilly lines. Families are particularly well served by highly regarded local schools including Coteford Infant School and Pinner High School. The vibrant Eastcote High Street is just a short walk away, offering a variety of cafés, restaurants, convenience stores and everyday amenities, while the charming and historic Pinner High Street provides boutique shops, popular eateries, supermarkets and a true village atmosphere. The area is further enhanced by nearby green spaces including Pinner Memorial Park and Eastcote House Gardens, perfect for family outings and leisure time.

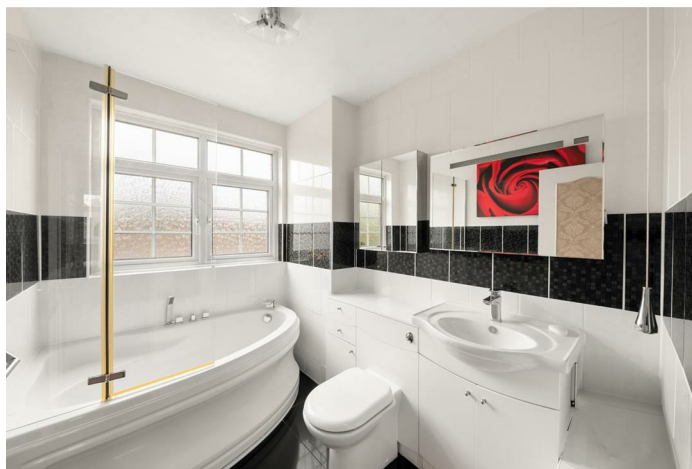

Floor Plans

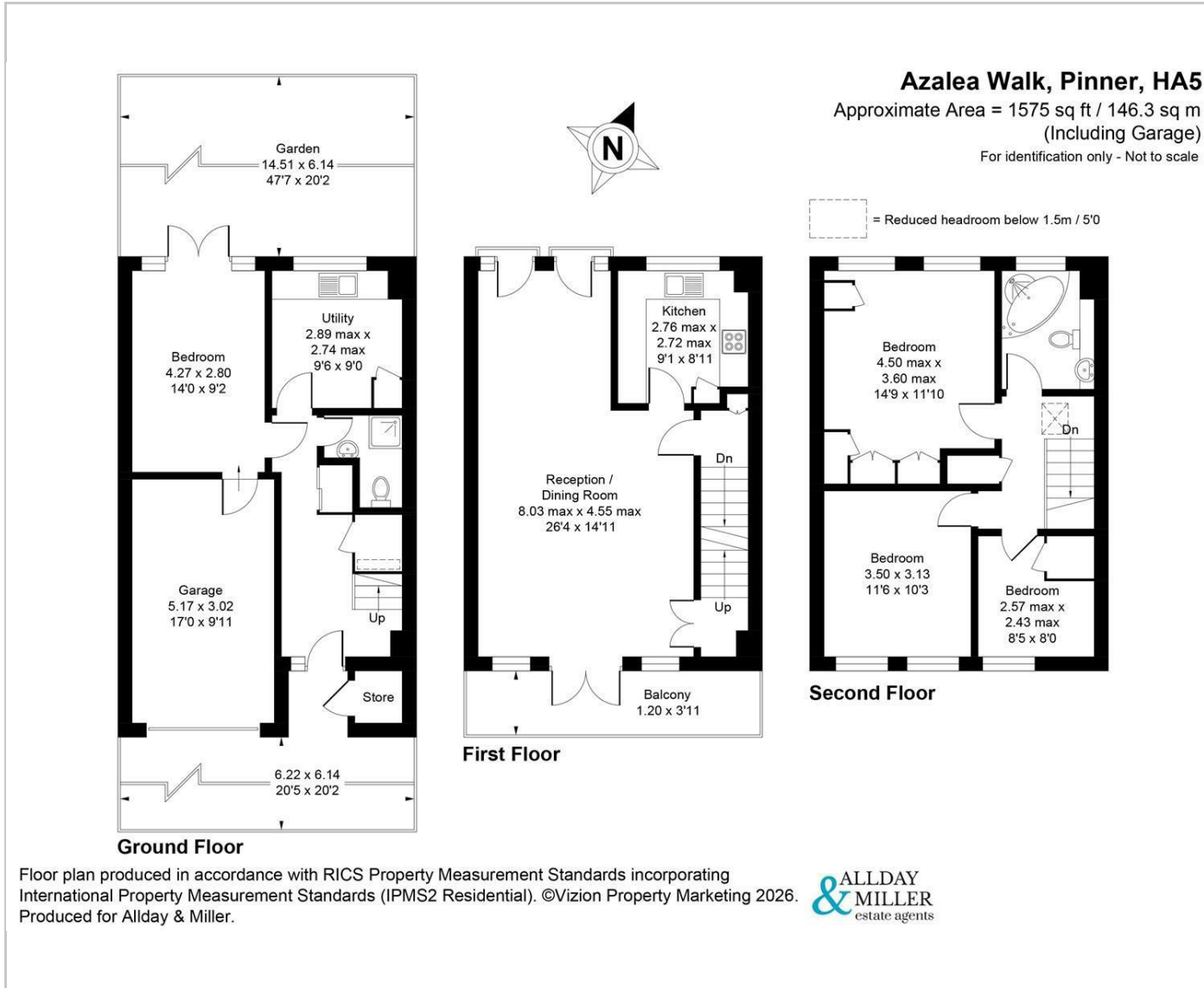

Area Map

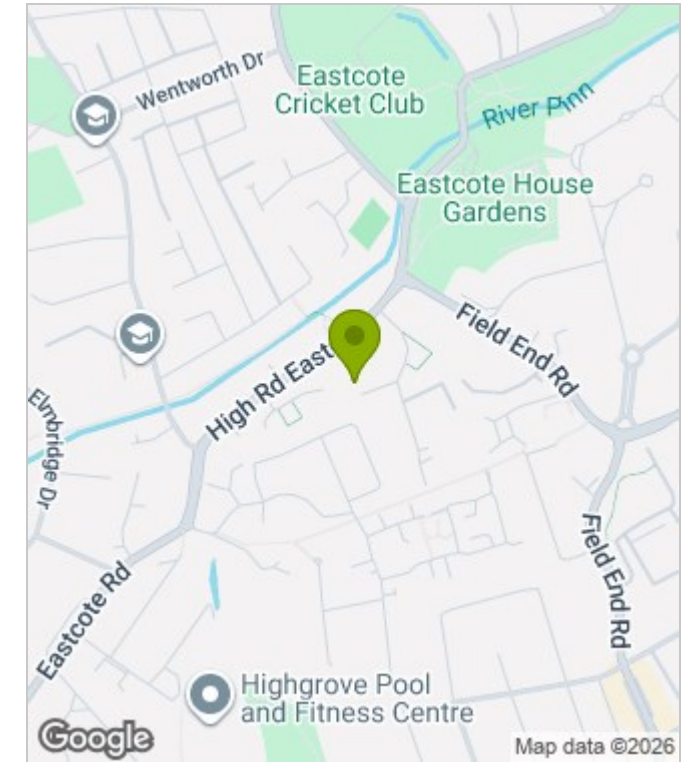

Energy Performance Graph

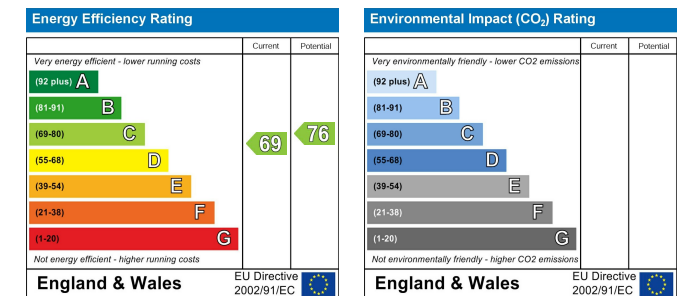

These particulars, whilst believed to be accurate are set out as a general outline only for guidance and do not constitute any part of an offer or contract. Intending purchasers should not rely on them as statements of representation of fact, but must satisfy themselves by inspection or otherwise as to their accuracy. No person in this firm's employment has the authority to make or give any representation or warranty in respect of the property.