



Connells

Milford Close
Marshalswick St. Albans



Property Description

A beautifully presented, fully renovated one-bedroom cluster home, ideally situated in the ever-popular Jersey Farm area of St Albans. This stylish property offers modern, low-maintenance living and is perfect for first-time buyers, downsizers, or investors alike.

The accommodation is thoughtfully arranged with a bright and contemporary open-plan living/kitchen/dining area, finished to a high standard and designed for both comfort and practicality. The kitchen is modern and well-equipped, seamlessly connecting to the living space-ideal for entertaining or relaxing.

Upstairs, the property boasts an attractive galleried double bedroom, creating a wonderful sense of space and light, along with ample built-in storage. A recently refurbished bathroom completes the internal accommodation, finished with modern fittings and a clean, sleek design.

Externally, the home benefits from a private front and side garden, offering a low-maintenance outdoor space perfect for enjoying warmer months. There is also allocated parking as well as additional visitor parking, adding further convenience.

Located within walking distance of local shops and amenities and 3 minutes walk to a bus stop the property also has a park just behind, fields close by and is 0.9 miles from Jersey Farm Woodland Park providing easy access to beautiful green spaces for leisure and recreation.

A superb home in a sought-after location-early viewing is highly recommended.



Living/Kitchen/Diner

18' 11" max x 13' 10" max (5.77m max x 4.22m max)

Bedroom

11' 6" max x 8' 2" max (3.51m max x 2.49m max)

Bathroom



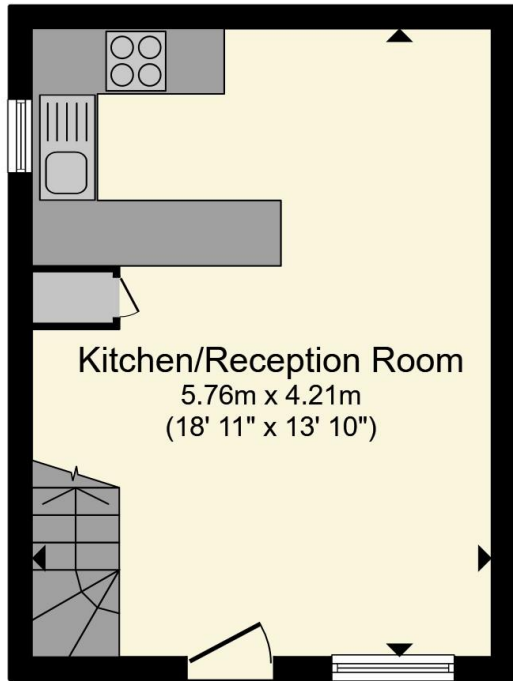

Ground Floor

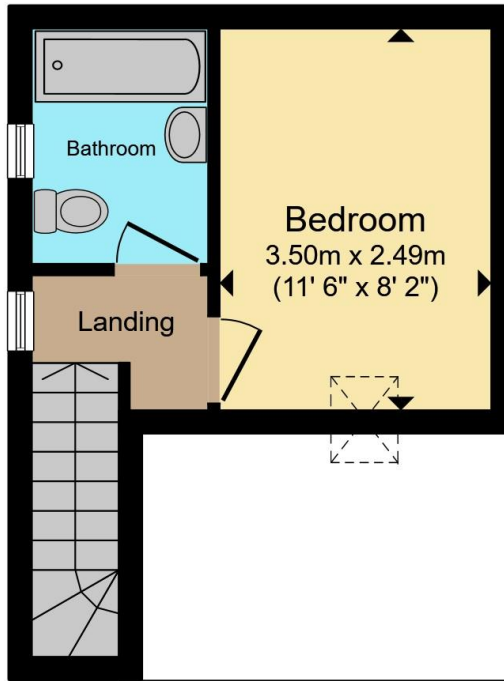

Mezzanine

Total floor area 44.2 m² (476 sq.ft.) approx

This floor plan is for illustrative purposes only. It is not drawn to scale. Any measurements, floor areas (including any total floor area), openings and orientation are approximate. No details are guaranteed, they cannot be relied upon for any purpose and they do not form part of any agreement. No liability is taken for any error, omission or misstatement. A party must rely upon its own inspection(s). Powered by www.propertybox.io



To view this property please contact Connells on

T 01727 851 100
E marshalswick@connells.co.uk

5 Wycombe Place The Quadrant Marshalswick
 ST ALBANS AL4 9RH

EPC Rating: D Council Tax
 Band: C

view this property online connells.co.uk/Property/MWK306314

Tenure: Freehold



1. MONEY LAUNDERING REGULATIONS Intending purchasers will be asked to produce identification documentation at a later stage and we would ask for your co-operation in order that there will be no delay in agreeing the sale. 2. These particulars do not constitute part or all of an offer or contract. 3. The measurements indicated are supplied for guidance only and as such must be considered incorrect. Potential buyers are advised to recheck measurements before committing to any expense. 4. We have not tested any apparatus, equipment, fixtures, fittings or services and it is in the buyers interest to check the working condition of any appliances.

Connells Residential is registered in England and Wales under company number 1489613, Registered Office is Cumbria House, 16-20 Hockliffe Street, Leighton Buzzard, Bedfordshire, LU7 1GN. VAT Registration Number is 500 2481 05.

See all our properties at www.connells.co.uk | www.rightmove.co.uk | www.zoopla.co.uk

Property Ref: MWK306314 - 0002