



Etruria Gardens, Derby DE1 3RL

welcome to

Etruria Gardens, Derby

Offered to the market with no onward chain is this immaculately presented ground floor, two bedroom flat at a 50% share. Modernised throughout including decor, flooring, heating system, bathroom fittings and doors, this is a perfect home for a first time buyer or professional.



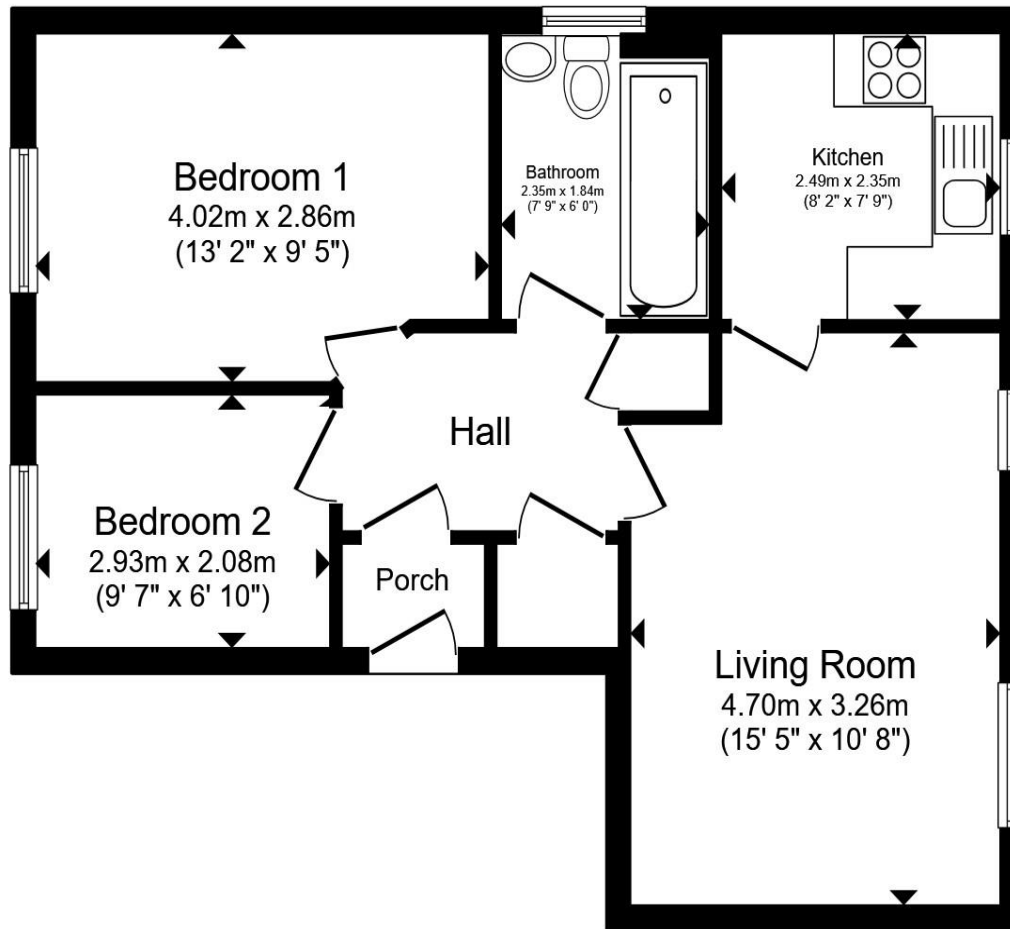

Hallway

Living Room

15' 5" MAX x 10' 8" MAX (4.70m MAX x 3.25m MAX)

Kitchen

8' 2" MAX x 7' 9" MAX (2.49m MAX x 2.36m MAX)

Bedroom One

13' 2" MAX x 9' 5" MAX (4.01m MAX x 2.87m MAX)

Bedroom Two

9' 7" MAX x 6' 10" MAX (2.92m MAX x 2.08m MAX)

Bathroom

Total floor area 49.7 m² (535 sq.ft.) approx

This floor plan is for illustrative purposes only. It is not drawn to scale. Any measurements, floor areas (including any total floor area), openings and orientation are approximate. No details are guaranteed, they cannot be relied upon for any purpose and they do not form part of any agreement. No liability is taken for any error, omission or misstatement. A party must rely upon its own inspection(s). Powered by www.propertybox.io

welcome to Etruria Gardens, Derby

- Ground Floor Two Bed Flat
- Offered at a 50% Share of Ownership
- Modern Bathroom Suite
- Kitchen with Ample Storage
- Allocated Parking

Tenure: Leasehold EPC Rating: C

Council Tax Band: A Service Charge: Ask Agent

Ground Rent: Ask Agent

This is a Leasehold property. We are awaiting further details about the Term of the lease. For further information please contact the branch. Please note additional fees could be incurred for items such as Leasehold packs.

£70,000



Please note the marker reflects the postcode not the actual property

view this property online [bagshawsresidential.co.uk/Property/DBY121728](https://www.bagshawsresidential.co.uk/Property/DBY121728)



Property Ref:
DBY121728 - 0006

1. MONEY LAUNDERING REGULATIONS Intending purchasers will be asked to produce identification documentation at a later stage and we would ask for your co-operation in order that there is no delay in agreeing the sale. 2. These particulars do not constitute part or all of an offer or contract. 3. The measurements indicated are supplied for guidance only and as such must be considered incorrect. Potential buyers are advised to recheck measurements before committing to any expense. 4. We have not tested any apparatus, equipment, fixtures or services and it is in the buyers interest to check the working condition of any appliances. 5. Where an EPC, or a Home Report (Scotland only) is held for this property, it is available for inspection at the branch by appointment. If you require a printed version of a Home Report, you will need to pay a reasonable production charge reflecting printing and other costs. 6. We are not able to offer an opinion either written or verbal on the content of these reports and this must be obtained from your legal representative. 7. Whilst we take care in preparing these reports, a buyer should ensure that his/her legal representative confirms as soon as possible all matters relating to title including the extent and boundaries of the property and other important matters before exchange of contracts.

Bagshaws Residential is a trading name of Sequence (UK) Limited which is registered in England and Wales under company number 4268443, Registered Office is Cumbria House, 16-20 Hockliffe Street, Leighton Buzzard, Bedfordshire, LU7 1GN. VAT Registration Number is 500 2481 05.

Offered to the market with no onward chain is this immaculately presented ground floor, two bedroom flat. Situated in Little Chester, just North of the City Centre, and walking distance to Darley Park, Chester Green Community Centre and local amenities. This property also benefits from allocated parking.

Once inside the apartment, the property for sale enters via a porch and comprises of a central hallway with intercom phone large, storage cupboard with plumbing for a washing machine, and connects a large double bedroom, a generous second bedroom, the bathroom with modern white suite and grey metro-tiles to the walls, living room with double windows for floods of natural light, which in turn leads to a well-appointed kitchen with modern boiler, built-in oven and induction hob, space for fridge freezer and slimline dishwasher. The overall finish of the flat is modern, making it a ready-to-move-into standard

Externally the residents benefit from one allocated space, with further visitor bays available for occasional use. The property is being sold as a Shared Ownership opportunity at a 50% share, however there is an opportunity to buy 100% of the home subject to approval by Places for People. The lease is 99 years from March 2000.



bagshaws residential



01332 361308



Derby@bagshawsresidential.co.uk



32-34 Cornmarket, DERBY, Derbyshire, DE1 2DG



[bagshawsresidential.co.uk](https://www.bagshawsresidential.co.uk)