



Connells

Tenbury Gardens
Penn Wolverhampton



Property Description

Connells Wolverhampton are delighted to bring to the market this immaculately presented and extended three bedroom detached family property in a popular residential location. Benefiting from an abundance of space, this property must be viewed in order to fully appreciate.

The property comprises of large entrance hall, 23ft family lounge, useful study room/dining room, modern refitted kitchen Wren kitchen and downstairs wc. On the first floor there are a selection of three spacious bedrooms and stylish family bathroom. Externally there is a large tarmac driveway providing off road parking and a generous rear garden with feature patio and artificial lawn.

The Location & Area

Set to the south west of Wolverhampton City centre in the much sought after Penn area with fantastic local schooling with easy access to the A449 route where many nearby shopping facilities and local eateries can be found. This property is also within the catchment area to the popular schooling and within a short distance to the rolling countryside.

Entrance Hall

Double glazed door to front, door to lounge, door to study area/dining area.

Study Room/ Dining Room

14' 9" x 13' (4.50m x 3.96m)
Double glazed window to front, vaulted ceiling, door to kitchen, open to entrance hall.

Kitchen

14' 10" x 9' 6" (4.52m x 2.90m)
Double glazed window to rear, a range of stylish Wren wall and base units, feature tiling, Range cooker with extractor, integrated microwave, space for various appliances, inset sink, door to rear garden, door to lounge.

Lounge

23' 2" x 10' 5" (7.06m x 3.17m)
Double glazed doors to rear garden, door to entrance hall, stairs to first floor landing.



First Floor Landing

Doors to various rooms.

Bedroom One

9' 7" x 15' 5" (2.92m x 4.70m)

Double glazed window to rear, central heating radiator, door to first floor landing.

Bedroom Two

13' 3" x 10' 4" (4.04m x 3.15m)

Double glazed window to front, central heating radiator, door to first floor landing.

Bedroom Three

9' 8" x 7' 9" (2.95m x 2.36m)

Double glazed window to front, fitted wardrobe, central heating radiator, door to first floor landing.

Family Bathroom

Double glazed window to rear and side, panelled bath, shower cubicle with waterfall shower, low flush toilet, feature tiling, door to first floor landing.

Outside Front

Large tarmac driveway providing off road parking, side gated access leading to rear garden.

Outside Rear

Large raised paved patio area, surrounding panelled fencing, large artificial lawned area.







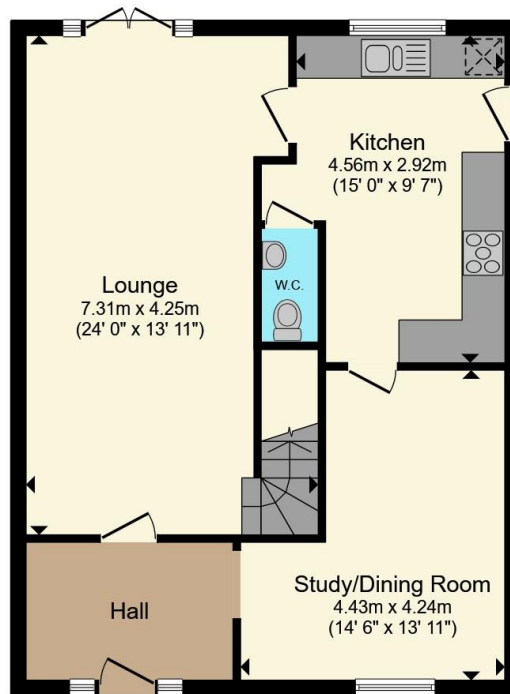

Ground Floor

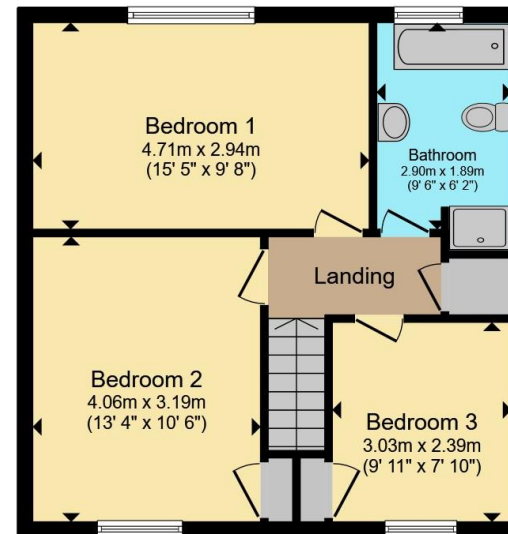

First Floor

Total floor area 107.5 m² (1,157 sq.ft.) approx

This floor plan is for illustrative purposes only. It is not drawn to scale. Any measurements, floor areas (including any total floor area), openings and orientation are approximate. No details are guaranteed, they cannot be relied upon for any purpose and they do not form part of any agreement. No liability is taken for any error, omission or misstatement. A party must rely upon its own inspection(s). Powered by www.propertybox.io



To view this property please contact Connells on

T 01902 710 170
E wolverhampton@connells.co.uk

81-83 Darlington Street
WOLVERHAMPTON WV1 4EX

EPC Rating: C Council Tax Band: C

Tenure: Freehold

view this property online connells.co.uk/Property/WVH333996



1. MONEY LAUNDERING REGULATIONS Intending purchasers will be asked to produce identification documentation at a later stage and we would ask for your co-operation in order that there will be no delay in agreeing the sale. 2. These particulars do not constitute part or all of an offer or contract. 3. The measurements indicated are supplied for guidance only and as such must be considered incorrect. Potential buyers are advised to recheck measurements before committing to any expense. 4. We have not tested any apparatus, equipment, fixtures, fittings or services and it is in the buyers interest to check the working condition of any appliances.

Connells Residential is registered in England and Wales under company number 1489613, Registered Office is Cumbria House, 16-20 Hockliffe Street, Leighton Buzzard, Bedfordshire, LU7 1GN. VAT Registration Number is 500 2481 05.

See all our properties at www.connells.co.uk | www.rightmove.co.uk | www.zoopla.co.uk

Property Ref: WVH333996 - 0003