



Peel Street, Derby, DE22 3GJ

welcome to

Peel Street, Derby

Charming 2-bedroom terraced home in Mackworth, Derby, offered with no onward chain. Featuring a lounge, dining room, fitted kitchen, family bathroom, and a generous garden. Modern, cosy, and ready to move into.



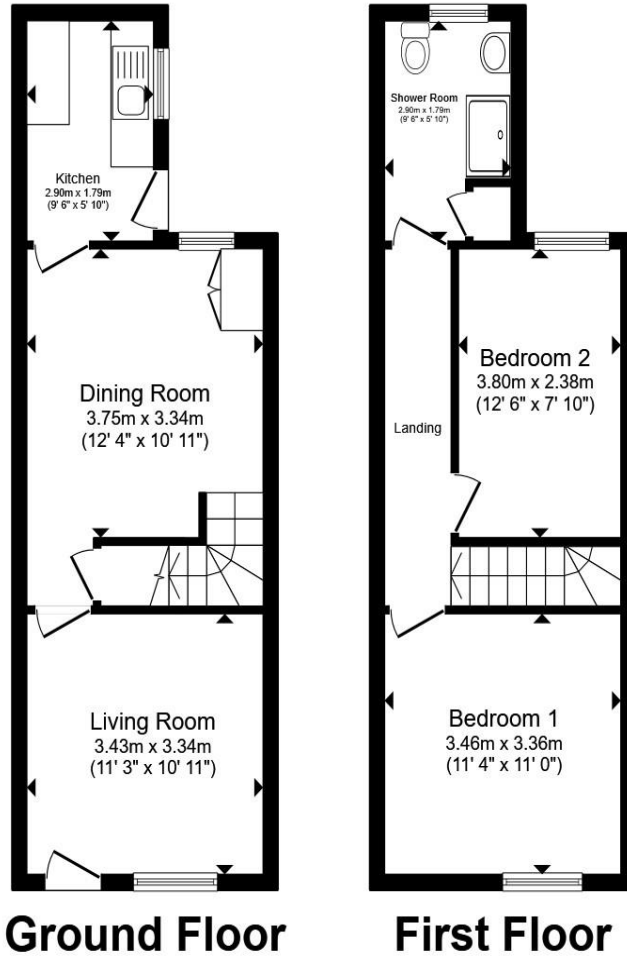

Living Room

11' 2" APX x 10' 9" APX (3.40m APX x 3.28m APX)

Dining Room

12' 3" APX x 10' 9" APX (3.73m APX x 3.28m APX)

Kitchen

9' 5" APX x 5' 8" APX (2.87m APX x 1.73m APX)

Bedroom 1

11' 3" APX x 11' 2" APX (3.43m APX x 3.40m APX)

Bedroom 2

12' 4" APX x 7' 7" APX (3.76m APX x 2.31m APX)

Bathroom

9' 5" APX x 5' 8" APX (2.87m APX x 1.73m APX)

Total floor area 65.6 m² (706 sq.ft.) approx

This floor plan is for illustrative purposes only. It is not drawn to scale. Any measurements, floor areas (including any total floor area), openings and orientation are approximate. No details are guaranteed, they cannot be relied upon for any purpose and they do not form part of any agreement. No liability is taken for any error, omission or misstatement. A party must rely upon its own inspection(s). Powered by www.propertybox.io

welcome to Peel Street, Derby

- No onward chain
- Modern cosy lounge and separate dining room
- Fully fitted gally kitchen with garden access
- Spacious garden with shed
- Freehold property in sought-after Mackworth, Derby

Tenure: Freehold EPC Rating: C
Council Tax Band: A

offers in the region of
£145,000



Please note the marker reflects the
postcode not the actual property

view this property online [bagshawsresidential.co.uk/Property/DBY121168](https://www.bagshawsresidential.co.uk/Property/DBY121168)



Property Ref:
DBY121168 - 0004

1. MONEY LAUNDERING REGULATIONS Intending purchasers will be asked to produce identification documentation at a later stage and we would ask for your co-operation in order that there is no delay in agreeing the sale. 2. These particulars do not constitute part or all of an offer or contract. 3. The measurements indicated are supplied for guidance only and as such must be considered incorrect. Potential buyers are advised to recheck measurements before committing to any expense. 4. We have not tested any apparatus, equipment, fixtures or services and it is in the buyers interest to check the working condition of any appliances. 5. Where an EPC, or a Home Report (Scotland only) is held for this property, it is available for inspection at the branch by appointment. If you require a printed version of a Home Report, you will need to pay a reasonable production charge reflecting printing and other costs. 6. We are not able to offer an opinion either written or verbal on the content of these reports and this must be obtained from your legal representative. 7. Whilst we take care in preparing these reports, a buyer should ensure that his/her legal representative confirms as soon as possible all matters relating to title including the extent and boundaries of the property and other important matters before exchange of contracts.

Bagshaws Residential is a trading name of Sequence (UK) Limited which is registered in England and Wales under company number 4268443, Registered Office is Cumbria House, 16-20 Hockliffe Street, Leighton Buzzard, Bedfordshire, LU7 1GN. VAT Registration Number is 500 2481 05.

This delightful 2-bedroom terraced family home offers a perfect blend of modern comfort and cosy charm. Step inside to a welcoming lounge, ideal for relaxing evenings, which flows into a separate dining room — perfect for family meals or entertaining guests. The well-equipped, fully fitted kitchen includes built-in appliances and a door leading directly to the garden, creating a seamless indoor-outdoor connection. Upstairs, you'll find two good-sized bedrooms and a modern family bathroom with shower, completing a practical and inviting layout.

The property is tastefully decorated and ready to move into, requiring no major work. A highlight is the generous garden, complete with a shed, offering ample outdoor space for children to play, summer gatherings, or simply enjoying the fresh air.

Located in Mackworth, Derby, this home sits within a sought-after residential area. Residents benefit from nearby bustling shops, schools, and easy access to Derby city centre with its wide range of amenities. Excellent transport links, including the A50, M1, and A38, make commuting straightforward, while the neighbourhood itself provides a welcoming community feel. Combining convenience, comfort, and space, this property is an ideal choice for first-time buyers, small families, or anyone seeking a well-presented home in a prime location.



bagshaws residential



01332 361308



Derby@bagshawsresidential.co.uk



32-34 Cornmarket, DERBY, Derbyshire, DE1 2DG



[bagshawsresidential.co.uk](https://www.bagshawsresidential.co.uk)