



Willesden Lane, NW6

TO LET - £2,500 Per Month

NOW AVAILABLE TO LET NOW is this Third Floor, two-bedroom apartment located in the 1930s apartment block called Marlow Court benefitting from a lift and off street parking.

The apartment offers 995 sq ft of meticulously finished and elegant accommodation showing features from when the building was built. The flat boasts a sophisticated 17ft entrance way, a charming reception room with wooden flooring followed by a modern fitted kitchen with metro tiling. There are two generously sized bedrooms and a stylish bathroom. Both bedrooms have built-in wardrobes providing ample storage. T

Willesden Lane is within walking distance of convenient transport links via Willesden Green & Kilburn (Jubilee - Zone 3) Stations, Brondesbury (Overground) Station, and local buses. Excellent amenities can be found in Kilburn and Willesden Green including a selection of restaurants, cafes & gastropubs.

- AVAILABLE FROM 20th MARCH 2024 2 bedrom apartment
- Generous reception room and modern kitchen
- Communal gardens & off-street parking
- COUNCIL: Brent (E) DEPOSIT: £2,884

020 8450 9377

rentals@cameronsstiff.co.uk

cameronsstiff.co.uk



Willesden Lane, London, NW6

Approximate Area = 995 sq ft / 92.4 sq m

For identification only - Not to scale

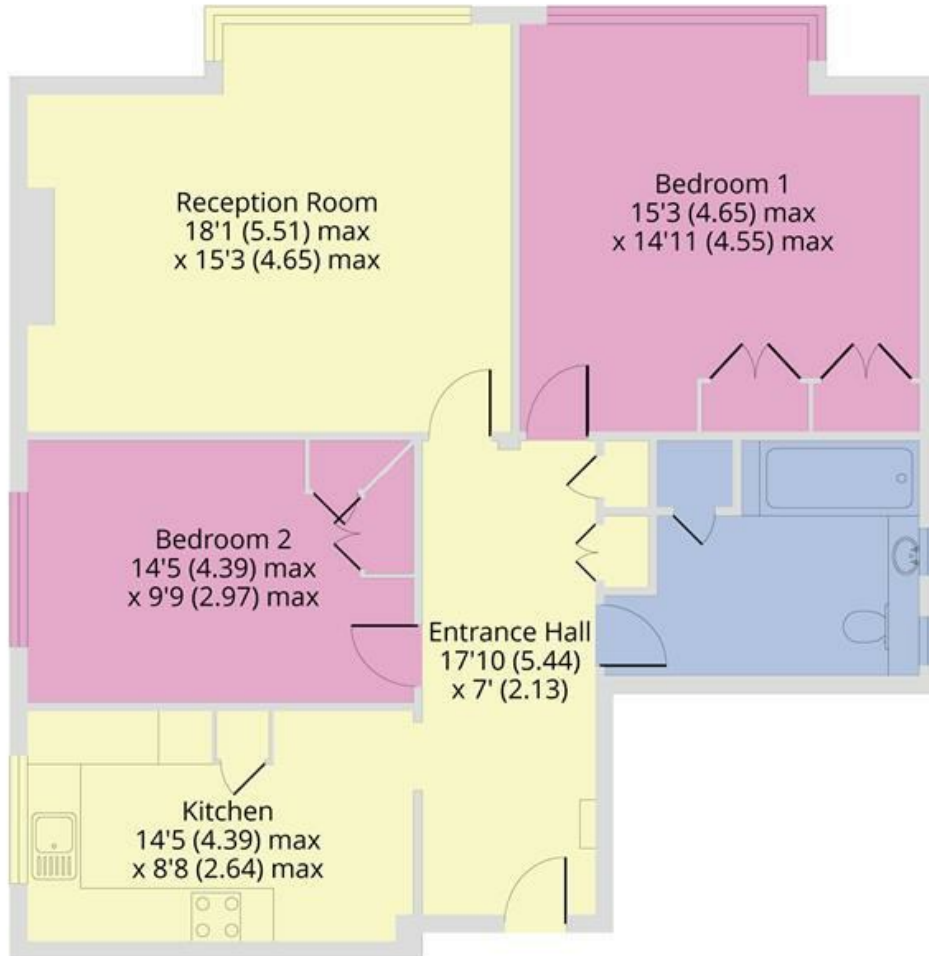

THIRD FLOOR

EPC: D

Ref: 15083572



Floor plan produced in accordance with RICS Property Measurement Standards incorporating International Property Measurement Standards (IPMS2 Residential). © n/cheom 2024. Produced for Camerons Stiff & Co. REF: 683119

