

SNELLERS

ESTATE AGENTS



Cheltenham Avenue, TW1

£1,899 PCM

Located just moments from Twickenham Station and the town centre is this newly refurbished first-floor maisonette set in a quiet cul-de-sac. Featuring a bright living/dining room, modern kitchen, two double bedrooms and a three-piece bathroom. Further benefits include wooden flooring, a south-facing garden with patio and boarded loft storage.

Cheltenham Avenue is a sought after street connecting Twickenham and St Margarets. Twickenham Station is just 0.2 miles away for direct links into central London.

- Newly Refurbished
- Wooden Flooring
- Two Double Bedrooms
- Modern Bathroom
- Private Garden
- Large Loft Storage

SNELLERS

ESTATE AGENTS

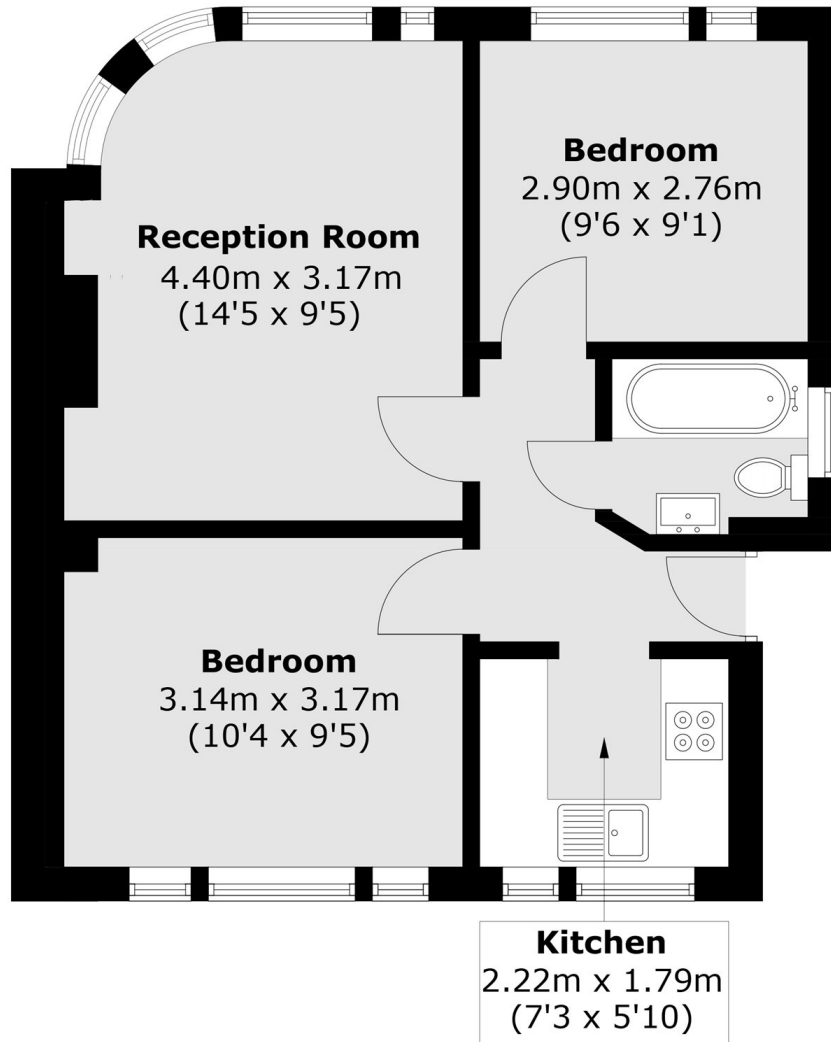

First Floor

Total area (approx.): 46.0 sq. m (495.1 sq. ft)

Snellers Twickenham Lettings
64-66 Heath Road
Twickenham
TW1 4BX
020 8892 5678
twickenhamlettings@snellers.co.uk

Energy Rating: We aim to make our particulars both accurate and reliable. However they are not guaranteed; nor do they form part of an offer or contract. If you require clarification on any points then please contact us, especially if you're traveling some distance to view. Please note that appliances and heating systems have not been tested and therefore no warranties can be given as to their good working order