



Chadwick Gardens, Uxbridge, UB8 1GU  
£300,000







## Chadwick Gardens, Uxbridge, UB8 1GU

**£300,000**

- Two Bedroom
- Second Floor Apartment
- Walking Distance to Uxbridge Town Centre
- Stunning Views
- Located in a Highly Desirable Area
- Two Bathrooms
- Allocated Parking
- Modern, Bright & Spacious
- Excellent Transport Links & Nearby Schools
- EPC Rating - B



## Description

Perfect for first time buyers this well presented apartment comprises of a welcoming entrance and a storage cupboard, a family bathroom, two double bedrooms ( master with ensuite), a light filled reception room which is south facing, modern fitted kitchen and a Juliet balcony.

Benefits of the development include entry phone system, well maintained communal gardens, bin stores and allocated parking spaces for residents.

## Situation

Laurel Court, Chadwick Gardens located in the prime location in Uxbridge. There are well regarded schools in close proximity including Uxbridge High school and Hermitage Primary School.

Recreational facilities also nearby such as Hillingdon Golf Club, Court Park, The Common, St Andrews Park, Uxbridge Cricket Club and the Hillingdon sports and leisure complex. Uxbridge Town Centre with its array of shopping facilities, restaurants and bars and the Piccadilly/Metropolitan Line Station is approximately half a mile away along with the A40 giving access to London and the Home Counties.





## Floor Plans

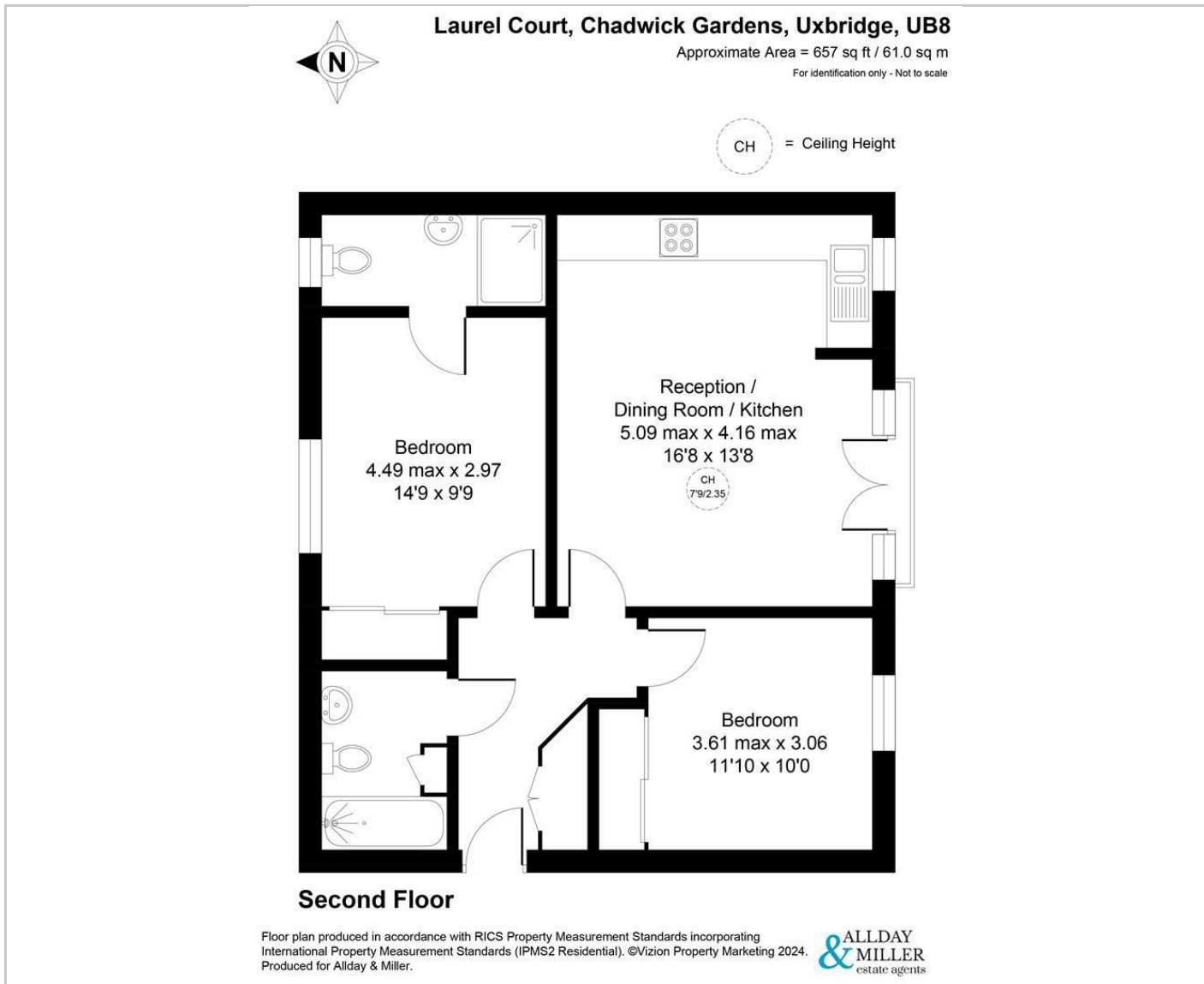

## Area Map

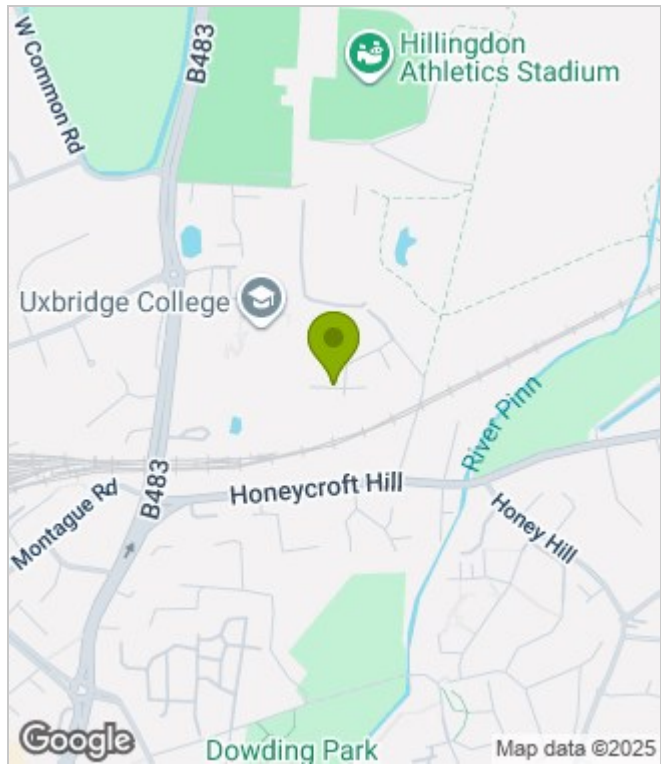

## Energy Performance Graph

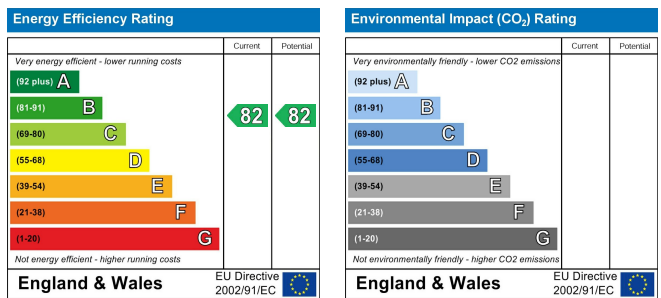

These particulars, whilst believed to be accurate are set out as a general outline only for guidance and do not constitute any part of an offer or contract. Intending purchasers should not rely on them as statements of representation of fact, but must satisfy themselves by inspection or otherwise as to their accuracy. No person in this firm's employment has the authority to make or give any representation or warranty in respect of the property.