

ALLDAY  
& MILLER



ALLDAY  
& MILLER  
FOR SALE  
01895 812 000

Diamond Road, Ruislip, HA4 0PF  
£750,000

4 2 1 c





Diamond Road, Ruislip, HA4 0PF

**£750,000**

- Four Bedrooms
- Two Bathrooms
- Eaves Storage
- Family Bathroom
- Extended Semi-Detached Family Home
- Extended Dining Kitchen
- Great Size Garden
- Off Street Parking
- Downstairs Cloakroom
- Double Garage Accessed via Rear Service Road



## Description

This well presented family home offers a perfect blend of comfort and modern living. Spanning an impressive 1,882 sq ft, the property is in good condition throughout, making it an ideal choice for families seeking a spacious and inviting environment.

Upon entering, you are greeted by a welcoming reception room a dining room a, the modern fitted kitchen equipped with contemporary appliances and ample storage, the convenience of a downstairs WC and a utility room adds to the practicality of this floor.

The first floor boasts three generously sized bedrooms, complemented by a family bathroom.

Ascending to the second floor, you will find a fourth bedroom complete with an ensuite, providing a private retreat. The property boasts a megaflo system, providing good pressure throughout the house.

Externally, the property features a front drive that offers ample parking for residents, a valuable asset in this sought-after area. The rear garden is well-maintained providing the perfect space for outdoor dining and entertainment.

## Situation

Diamond Road is a very popular location, conveniently located close to parks, transport and amenities at South Ruislip. For the motorist, there are excellent connections to Central London via the M25 and the M40. Commuters are well suited with a number of London underground stations in the area. Stations include South Ruislip ( Central Line ) and Eastcote ( Metropolitan & Piccadilly ). For families, there are a number of highly regarded schools that cater for children of all ages within close proximity including Queensmead, Deanesfield and St Swithin Wells. Shenley Park and Ruislip Rugby Fields are all a short walk away.





Floor Plans

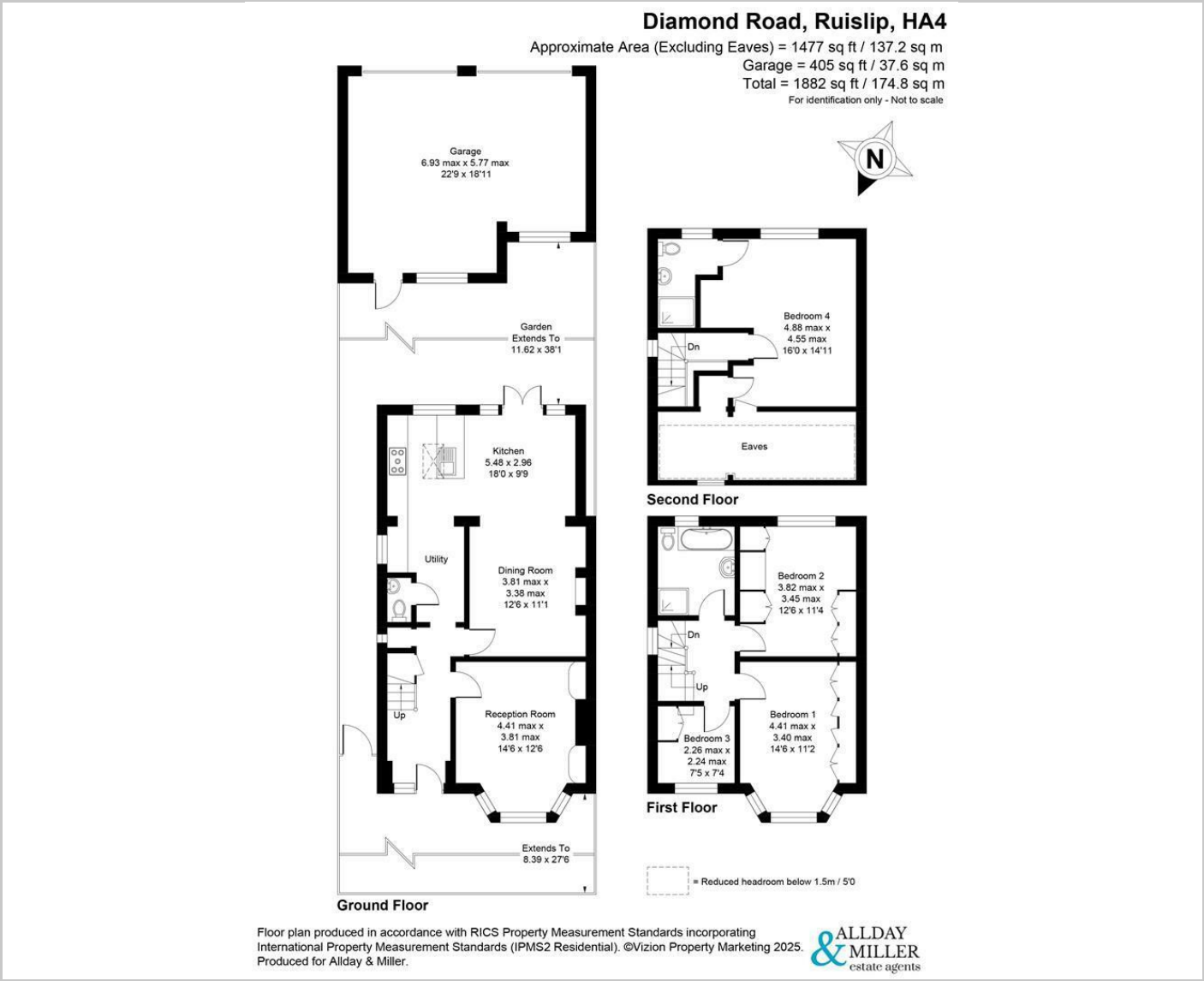

Area Map

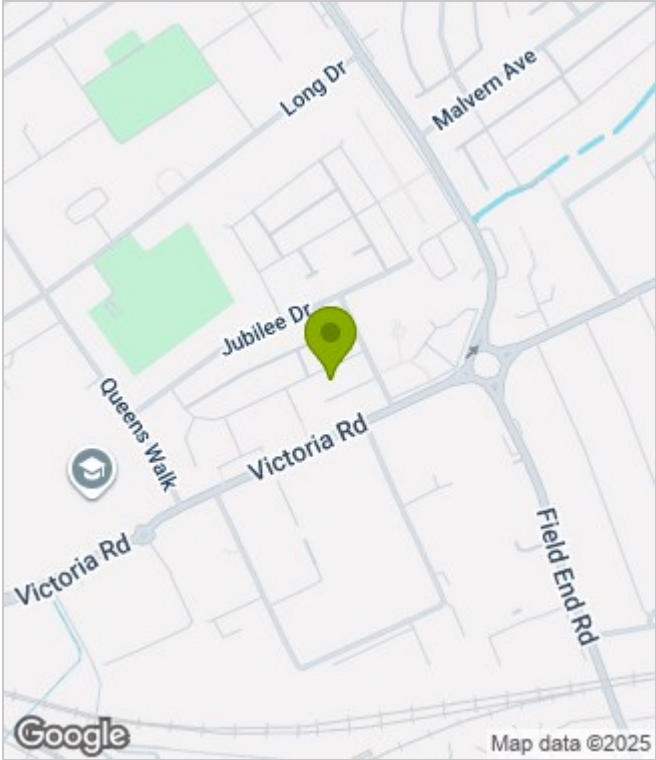

Energy Performance Graph

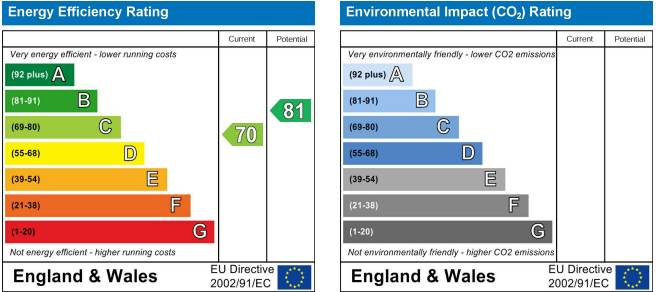

These particulars, whilst believed to be accurate are set out as a general outline only for guidance and do not constitute any part of an offer or contract. Intending purchasers should not rely on them as statements of representation of fact, but must satisfy themselves by inspection or otherwise as to their accuracy. No person in this firms employment has the authority to make or give any representation or warranty in respect of the property.