

ALLDAY  
& MILLER

Ivybridge Close, Uxbridge, UB8 3TT  
£495,000







Ivybridge Close, Uxbridge, UB8 3TT

**£495,000**

- Two Double Bedrooms
- Conservatory
- Modern Kitchen & Bathroom
- Hard Wood Floors
- Exclusive Modern Development
- Allocated Parking
- Easy Reach Of Uxbridge Town Centre
- Fitted Wardrobes

## Description

This modern home comprises of; entrance hallway, sleek fitted kitchen, spacious reception room which leads into the conservatory/dining room overlooking and providing access to the rear garden.

The first floor enjoys two double bedrooms with fitted wardrobes and a recently renovated family bathroom.

To the front of the property there is an allocated parking space. To the rear a private garden with a lawn and patio area, perfect for outside dining.

## Situation

Ivybridge Close situated in Hillingdon Village offering access to a number of local amenities including local shops, bus/road links, Brunel University, Hillingdon Hospital, Hillingdon golf and cricket club, Stockley Park. Highly regarded schools include Bishopshalt Senior School and Uxbridge High School.

Uxbridge town centre just a short drive away with its variety of shops, bars, restaurants and Metropolitan/Piccadilly line with links to . The A40/M40 and M4 are a short drive away offering access to Heathrow, London and the Home Counties.





## Floor Plans

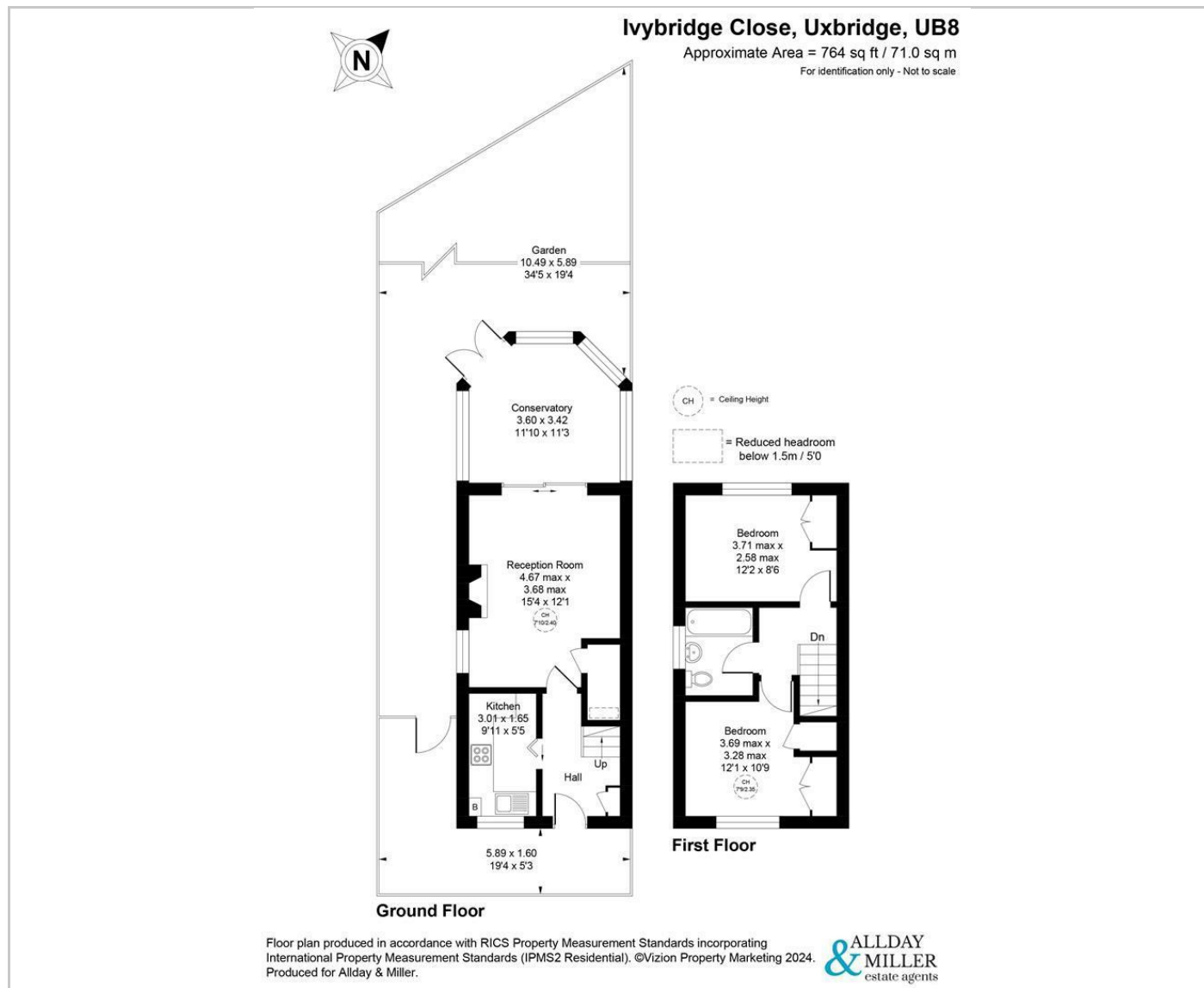

## Area Map

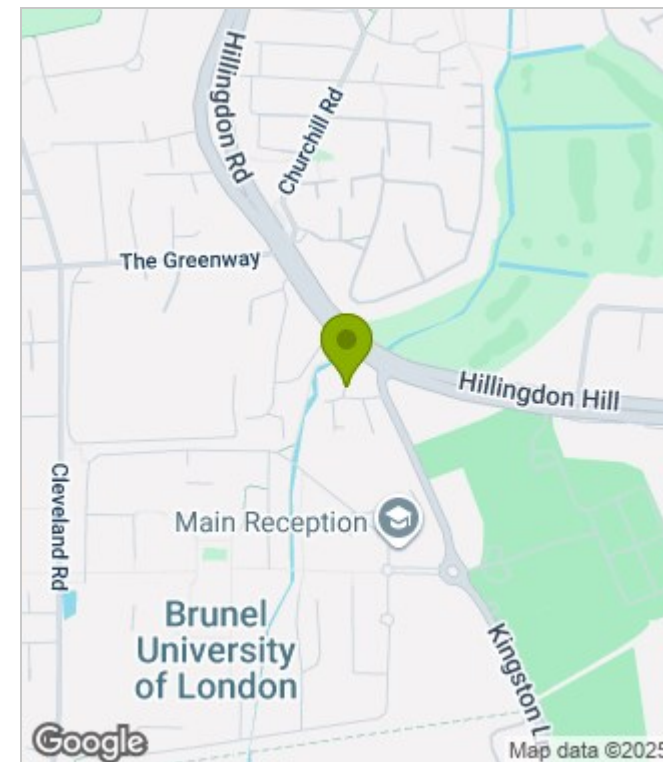

## Energy Performance Graph

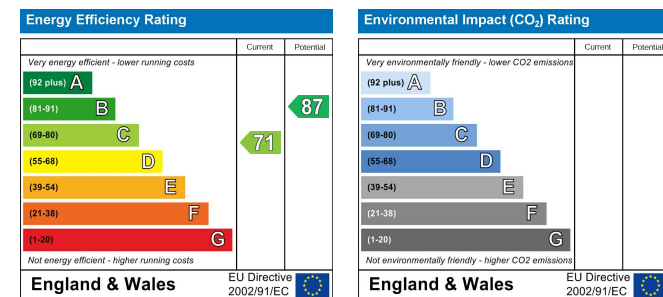

These particulars, whilst believed to be accurate are set out as a general outline only for guidance and do not constitute any part of an offer or contract. Intending purchasers should not rely on them as statements of representation of fact, but must satisfy themselves by inspection or otherwise as to their accuracy. No person in this firm's employment has the authority to make or give any representation or warranty in respect of the property.