

3A, 2 Rodway Road, London, SW15 5DS

Asking Price: £1450 pcm

Available now

Unfurnished

EPC - Band D



020 8876 2222

hello@village-properties.co.uk

Location

Surrounded by lots of green spaces, this lovely property is within walking distance to Putney Common and Richmond Park.

It has excellent bus route which go to Putney, Kingston, Barnes and beyond.

Roehampton has lots of local shops as well as a Little Waitrose.

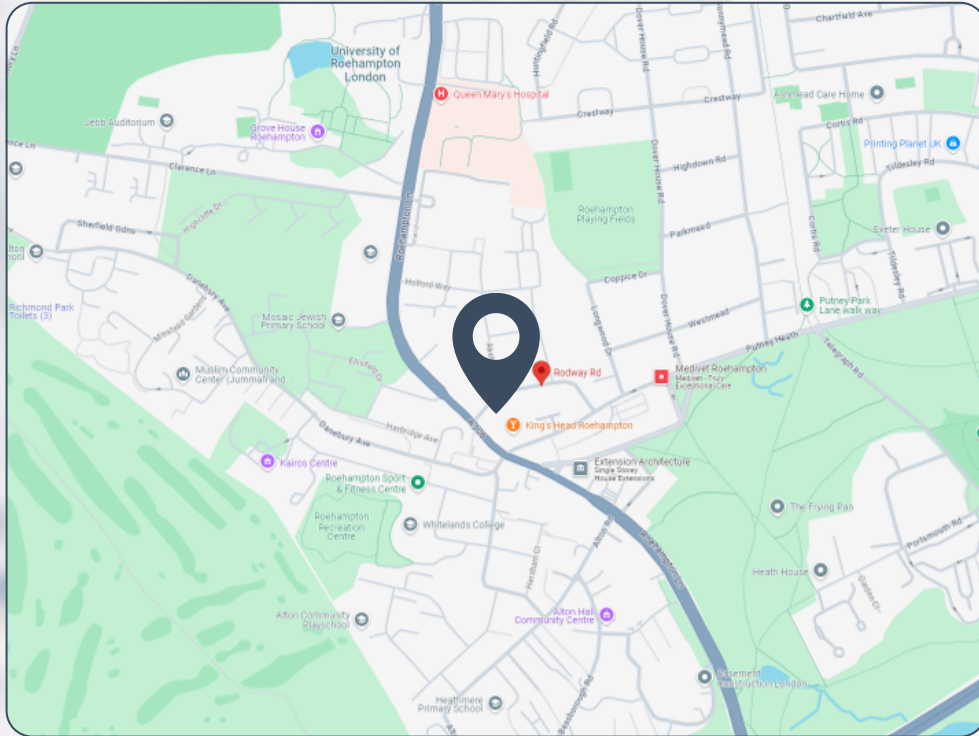

Flat 3A, 2 Rodway Road, London, SW15

Summary

- Period conversion flat on the 2nd floor of a large Edwardian house
- Very large double bedroom with hard flooring
- Kitchen/lounge/diner with washing machine, fridge, electric oven and hob
- Shower room
- Available now
- EPC band - D

Please note that an additional £300 a month will be charged on to of the rent which will include all utilities, council tax and broadband.

The Property

This lovely flat on the top floor of this Edwardian house and provides fantastic space of a very large bedroom, eat-in kitchen and modern shower room.

Recently refurbished, the flat is full of character and light with views over the tree tops.

Nice to know:

Local Authority:
Wandsworth Borough Council

Council Tax Band:
D - ££961.14 - 2024/2025 - Please note that the council tax will be included in the additional £300 a month to cover gas, water, electricity, broadband and council tax.

EPC : Band D

453 square feet

Rodway Road, London, SW15

Approximate Gross Internal Area = 42.1 sq m / 453 sq ft

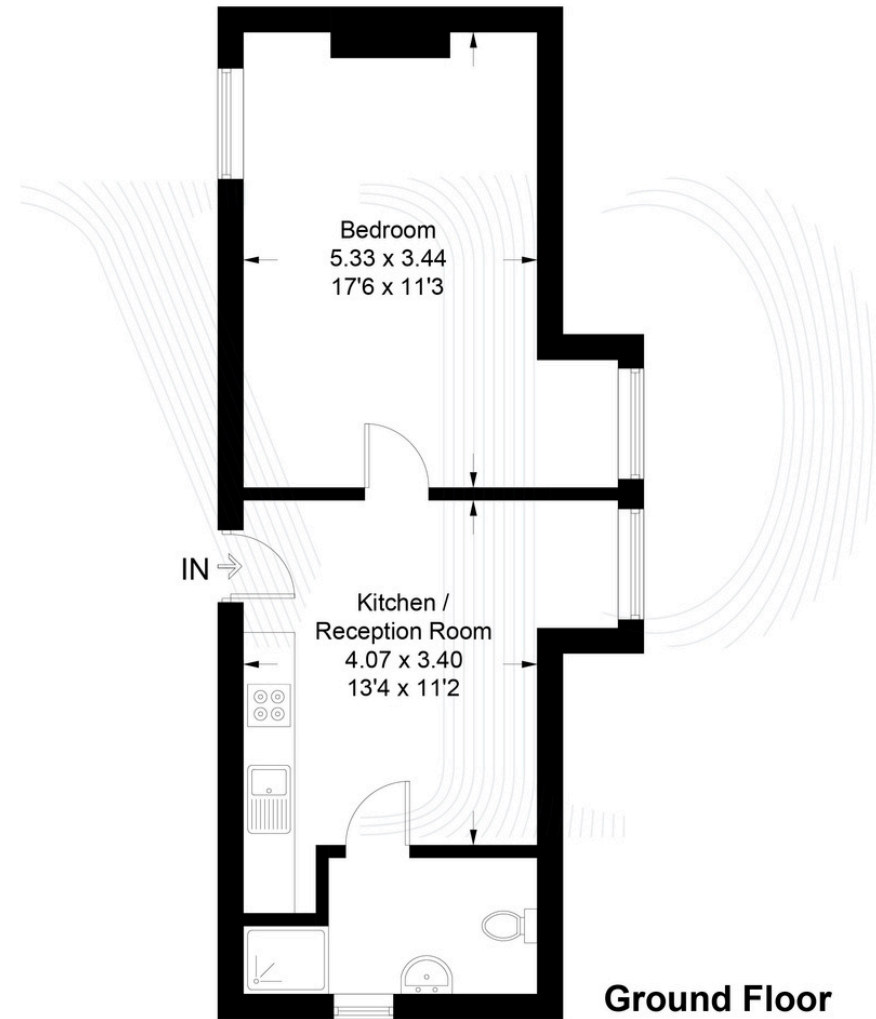



Make Yourself at Home

We are fortunate to work in the property market of South West London and Surrey, offering beautiful homes in charming, village-like areas such as Barnes, Richmond, Mortlake, and Kew.

With historical buildings, riverside walks, and excellent transport links (tube, rail, bus, and riverboat), these areas blend semi-rural charm with city convenience.

They feature independent shops, restaurants, leisure facilities, theatres, galleries, and museums. Families are drawn here by outstanding schools and the perfect balance of city and country life.

020 8876 2222

hello@village-properties.co.uk

