

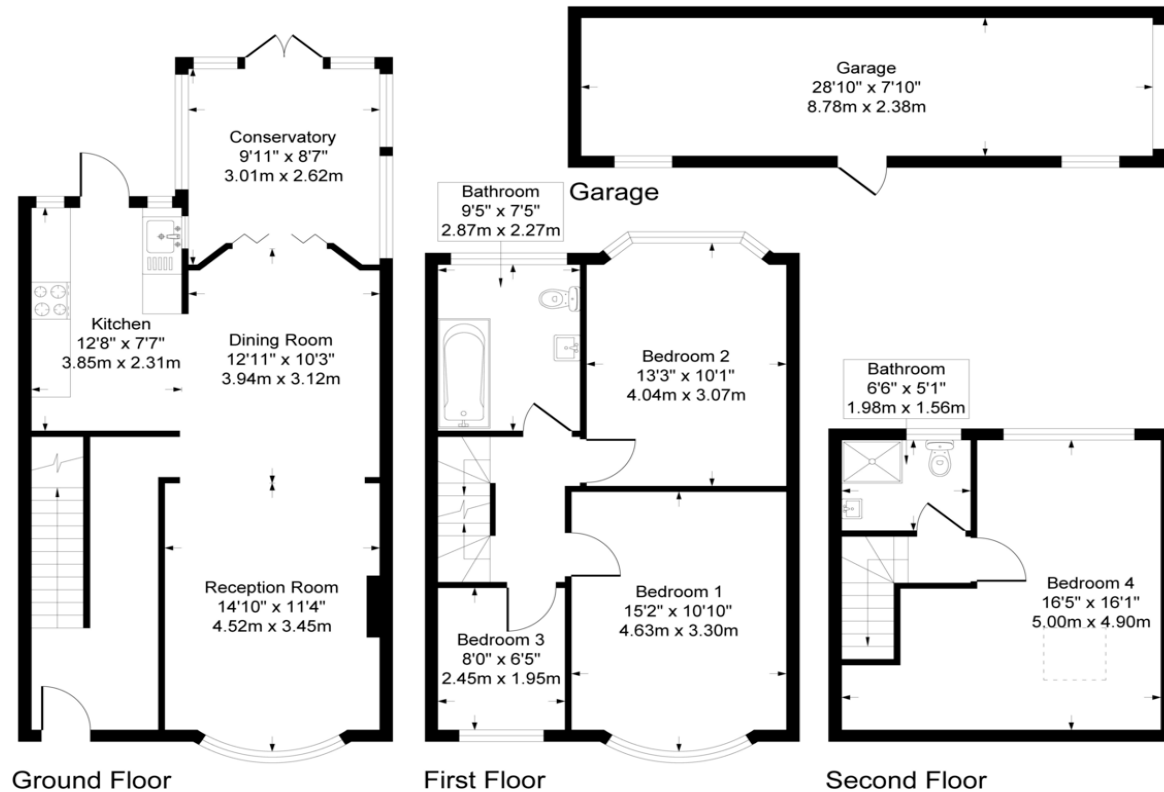





**Approximate Gross Internal Area  
1567 sq ft - 146 sq m**



Although every attempt has been made to ensure accuracy, all measurements are approximate.  
This floorplan is for illustrative purposes only and not to scale.  
Measured in accordance with RICS Standards.

A spacious 4 Bedroom mid terrace family home, situated ideally between Whitton and Hounslow high streets. The property internally consists of, through lounge sitting room, open plan kitchen dinner leading through to an extended conservatory. To the first and second floors are four well sized bedrooms, family bathroom, with an en-suite to bedroom four (loft conversion). Externally, the property benefits from, front off-street parking, rear garage accessed via shared service road and a well-maintained rear garden.