



Lewin Road, SW16

£600,000

A spacious period property with a modern finish that stays in keeping with its original detailing. This property also has a large private garden. The flat is within walking distance of both Streatham

- Period Ground Floor Flat
- Large Private Garden
- Modern finish
- Two Bedrooms
- Private Off Street Parking
- Share of Freehold



Lewin Road is a wide tree lined street in the heart of Streatham within moments of Streatham Common and the Rookery Gardens with excellent transport links in to London from numerous stations in the Streatham area. And features many bus routes towards the city of London and as well as towards Brixton and Clapham





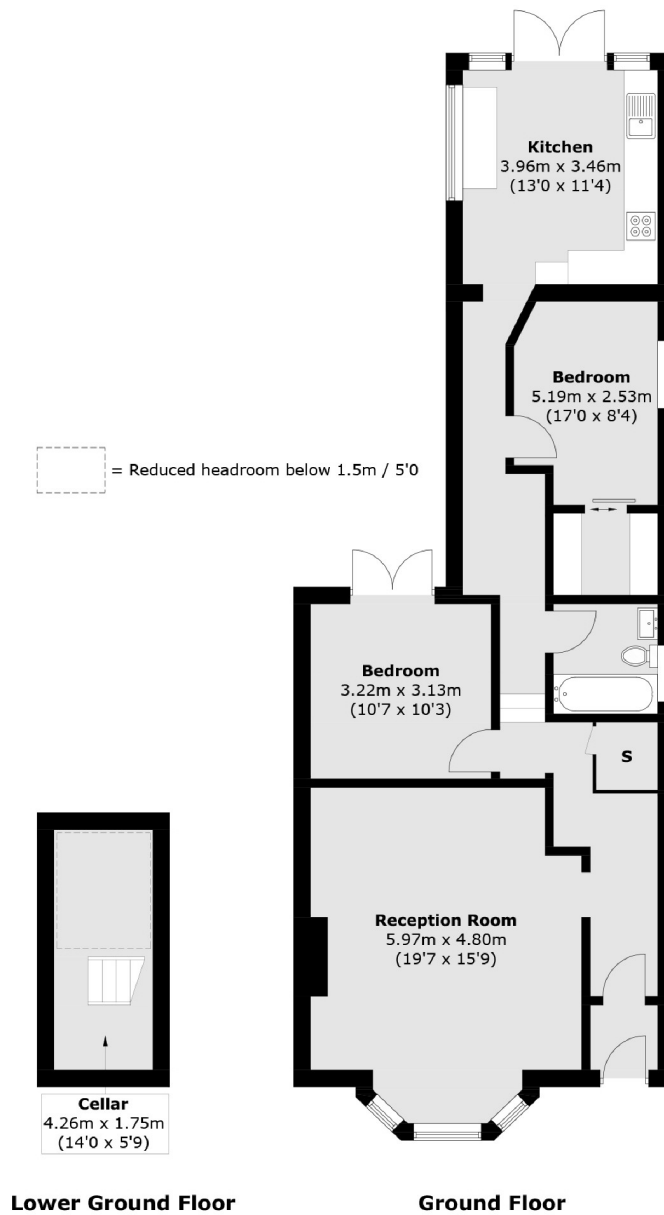

Total area (approx.): 93.5 sq. m (1,006.3 sq. ft)

Jacksons Clapham
73 Abbeville Road
London
SW4 9JN
020 8875 7995
clapham.sales@jacksonsestateagents.com

Energy Rating: E We aim to make our particulars both accurate and reliable. However they are not guaranteed; nor do they form part of an offer or contract. If you require clarification on any points then please contact us, especially if you're traveling some distance to view. Please note that appliances and heating systems have not been tested and therefore no warranties can be given as to their good working order.