

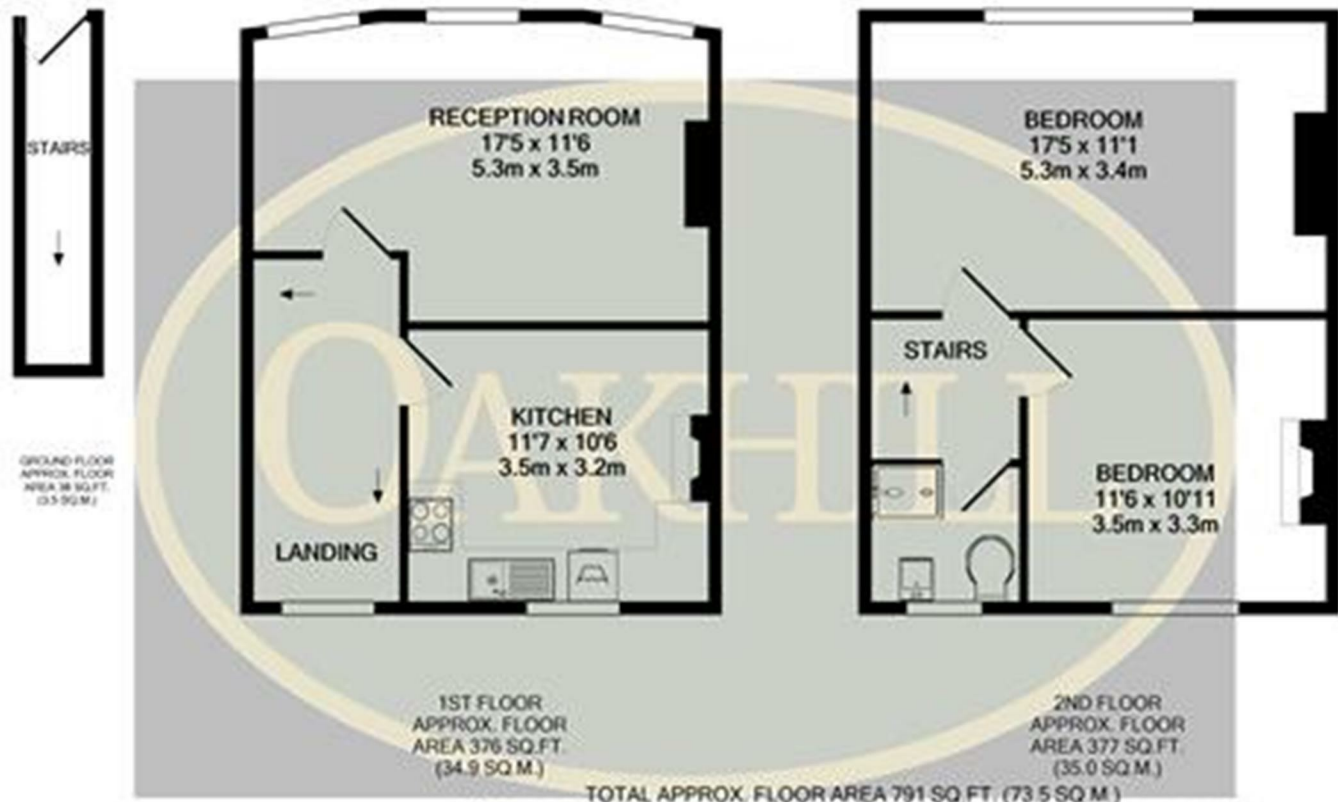

## London Road, Isleworth, London TW7 4BX

Two double bedroom first floor split-level flat within a short walk to Isleworth Rail Station. The property has been newly redecorated, and newly carpeted throughout. The first floor offers the kitchen area with space to dine, and the living area. The second floor offers both bedrooms and shower room. Available immediately.

**£1,195 PER MONTH**



Whilst every attempt has been made to ensure the accuracy of the floor plan contained here, measurements of doors, windows, rooms and any other items are approximate and no responsibility is taken for any error, omission, or mis-statement. This plan is for illustrative purposes only and should be used as such by any prospective purchaser. The services, systems and appliances shown have not been tested and no guarantee as to their operability or efficiency can be given  
Made with Metropix ©2021

Energy Efficiency Rating		Current	Potential
Very energy efficient - lower running costs			
(92 plus) A			
(81-91) B			
(69-80) C			
(55-68) D			
(39-54) E			
(21-38) F			
(1-20) G			
Not energy efficient - higher running costs			
<b>England &amp; Wales</b>	EU Directive 2002/91/EC	60	69

Environmental Impact (CO <sub>2</sub> ) Rating		Current	Potential
Very environmentally friendly - lower CO <sub>2</sub> emissions			
(92 plus) A			
(81-91) B			
(69-80) C			
(55-68) D			
(39-54) E			
(21-38) F			
(1-20) G			
Not environmentally friendly - higher CO <sub>2</sub> emissions			
<b>England &amp; Wales</b>	EU Directive 2002/91/EC		



6 South Street, Isleworth, TW7 7BG  
 Tel: 0208 568 4433  
 info@oakhillagents.co.uk  
 www.oakhillagents.co.uk

