

ALLDAY
& MILLER

ALLDAY
& MILLER
FOR SALE
01895 641 000 alldayandmiller.co.uk

Austin Waye, Uxbridge, UB8 2RQ
£435,000



2



1



2



C



Austin Waye, Uxbridge, UB8 2RQ

£435,000

- Two Double Bedrooms
- Kitchen Breakfast Room
- Utility Room
- Large Read Garden
- St Marys School 0.3 Miles away
- Uxbridge Town Centre Location
- No Onward Chain
- Gas Central Heating
- Quiet Residential Location
- Close to Uxbridge Station

Description

This popular address is set close to Uxbridge town centre and accommodation comprises entrance hall, 12ft lounge with solid flooring, 15ft fitted kitchen/breakfast Room, a 16ft x10 master bedroom, second double bedroom with built in wardrobes and a white family bathroom suite.

There is a low maintenance garden to the front of the property whilst the rear garden is mainly laid to lawn approx 65ft, storage shed and is opposite Rockingham Recreation Ground is also found at the bottom of the rear garden.

Situation

Austin Way is just a short walk from the town centre with Underground Station with Metropolitan & Piccadilly line service, shopping facilities, restaurants and bars. Well regarded schools, recreational facilities including Uxbridge cricket club and Hillingdon sports and leisure centre with its indoor and outdoor swimming pool are within close proximity. London Heathrow Airport, the motorway network and Stockley Business Park are all within easy motoring distance. St Marys School is a short walk And Uxbridge High secondary school is also close by



Floor Plans

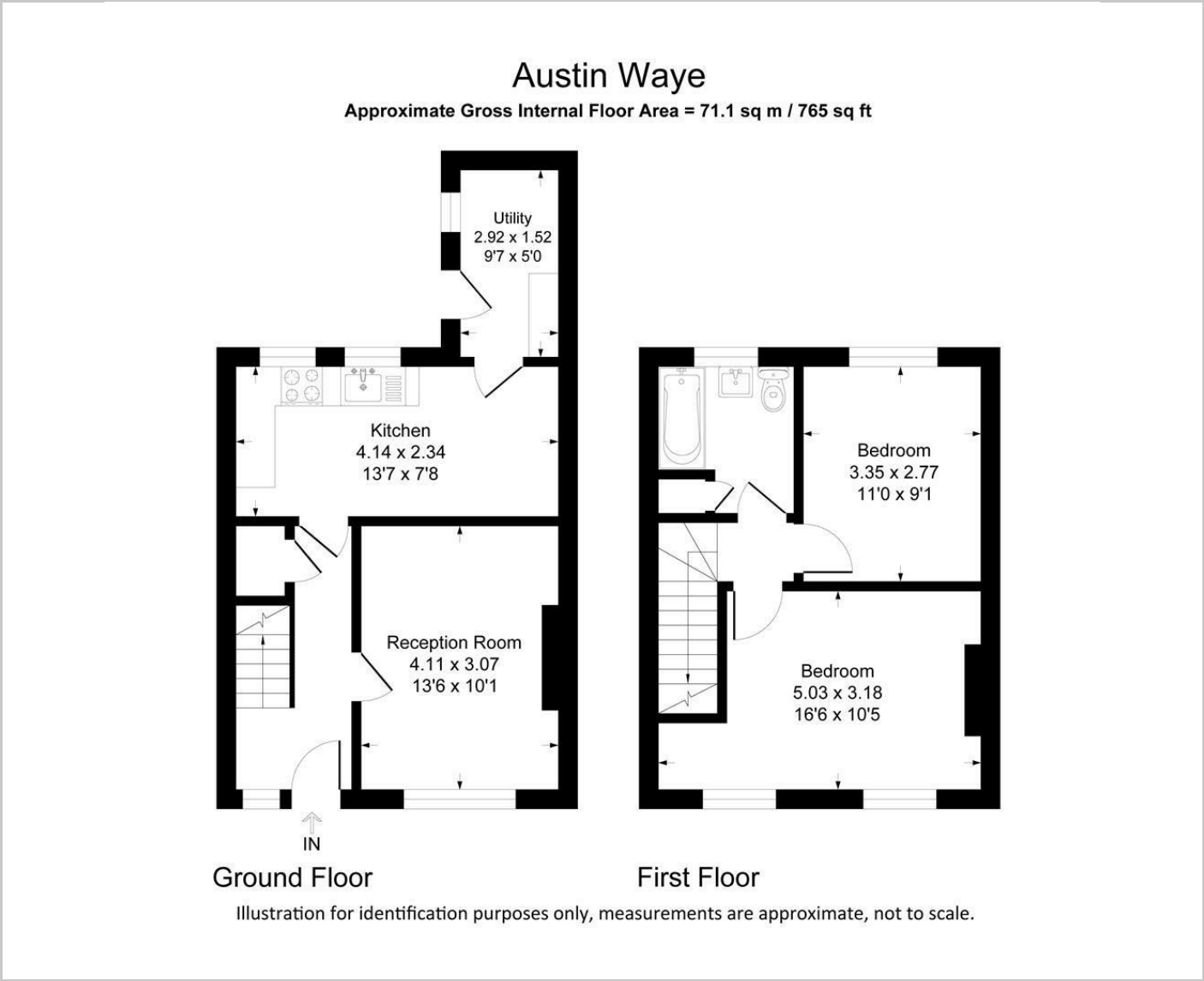

Area Map

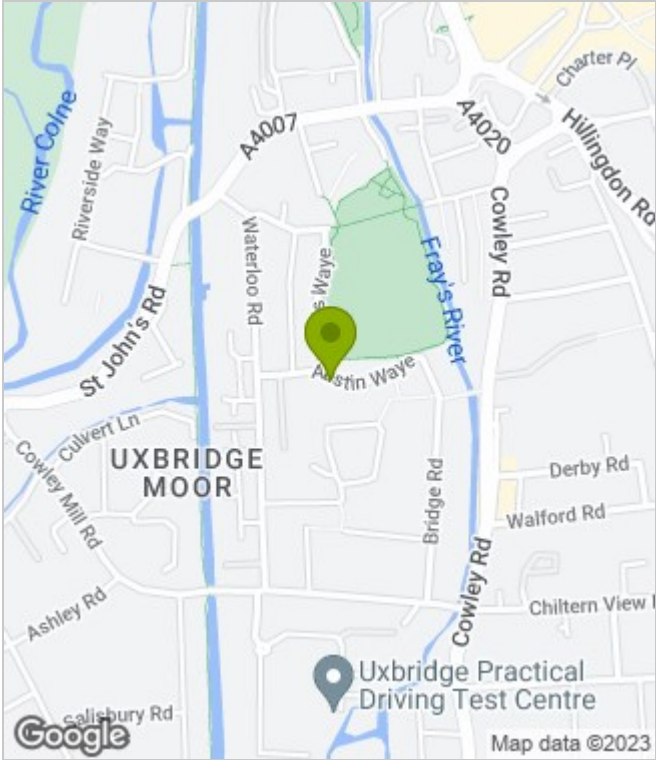

Energy Performance Graph

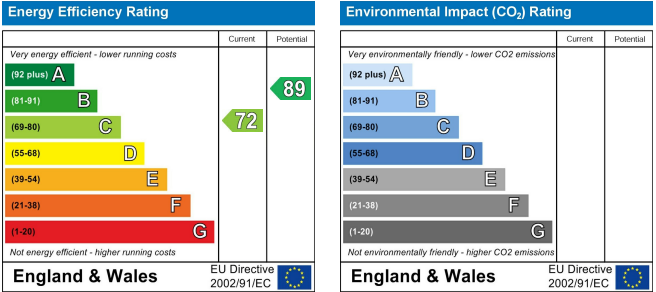

These particulars, whilst believed to be accurate are set out as a general outline only for guidance and do not constitute any part of an offer or contract. Intending purchasers should not rely on them as statements of representation of fact, but must satisfy themselves by inspection or otherwise as to their accuracy. No person in this firms employment has the authority to make or give any representation or warranty in respect of the property.