



## Veronica Road, SW17

**£450,000**

Set within a grand period building within close proximity of Tooting Bec Common, this top floor one bed conversion property comprises reception room with separate kitchen, a double bedroom and bathroom. The property features a lovely contemporary kitchen, a spacious lounge and ample storage.

- Victorian Conversion
- One Double Bedroom
- Near Tooting Bec Common
- Heaver Conservation Area
- Close To Balham Station
- Contemporary Kitchen

## Second Floor

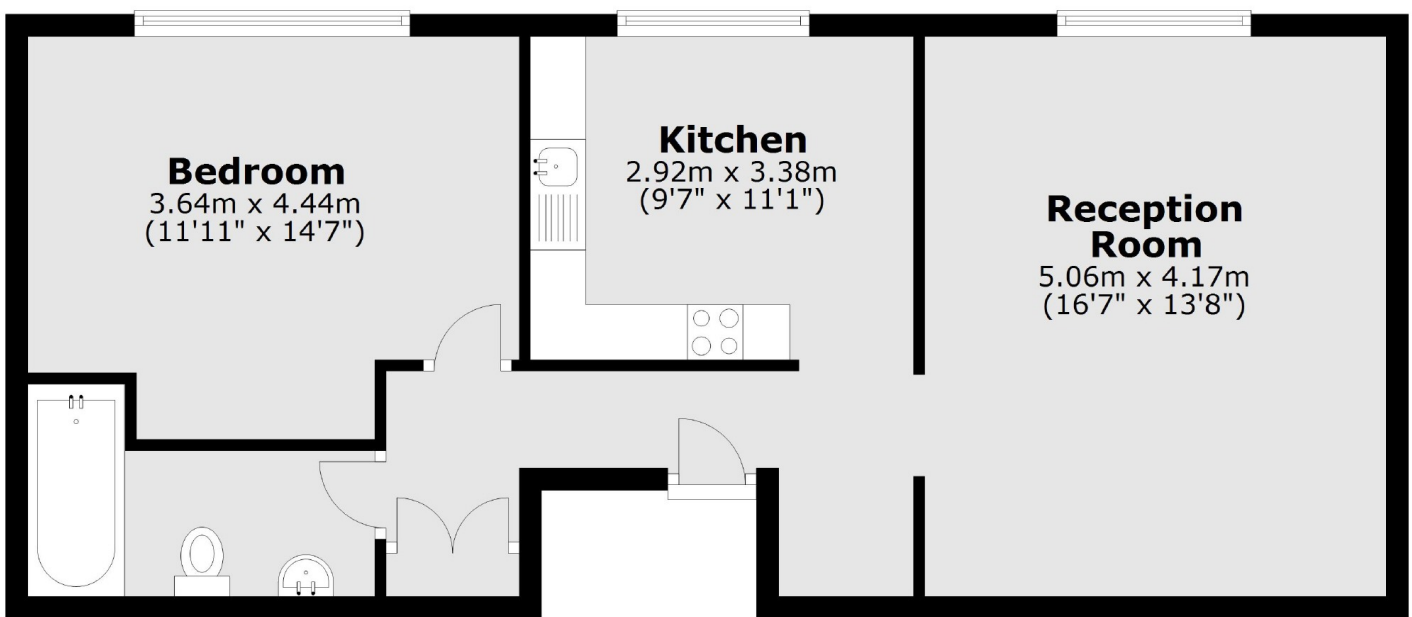

Total area: approx. 59.4 sq. metres (639.2 sq. feet)

Jacksons Balham  
8-11 Balham Station Road  
London  
SW12 9SG  
020 8675 6555  
[balham.sales@jacksonsestateagents.com](mailto:balham.sales@jacksonsestateagents.com)

Energy Rating: E We aim to make our particulars both accurate and reliable. However they are not guaranteed; nor do they form part of an offer or contract. If you require clarification on any points then please contact us, especially if you're traveling some distance to view. Please note that appliances and heating systems have not been tested and therefore no warranties can be given as to their good working order.