



211, Worton Road, Isleworth, London TW7 6DS

Bright and spacious two double bedroom apartment with private roof terrace, situated on the second floor with great views over Redlees Park. Offering excellent hallway space with room to work from home, two great sized bedrooms with wardrobes and the master offering an en-suite shower room. The living room offers an abundance of light with open plan kitchen and private balcony.

Worton Road is congenitally located in the catchment area for many of the best local schools, and provides easy access to both Isleworth Station and Twickenham Station

£1,450 PER MONTH

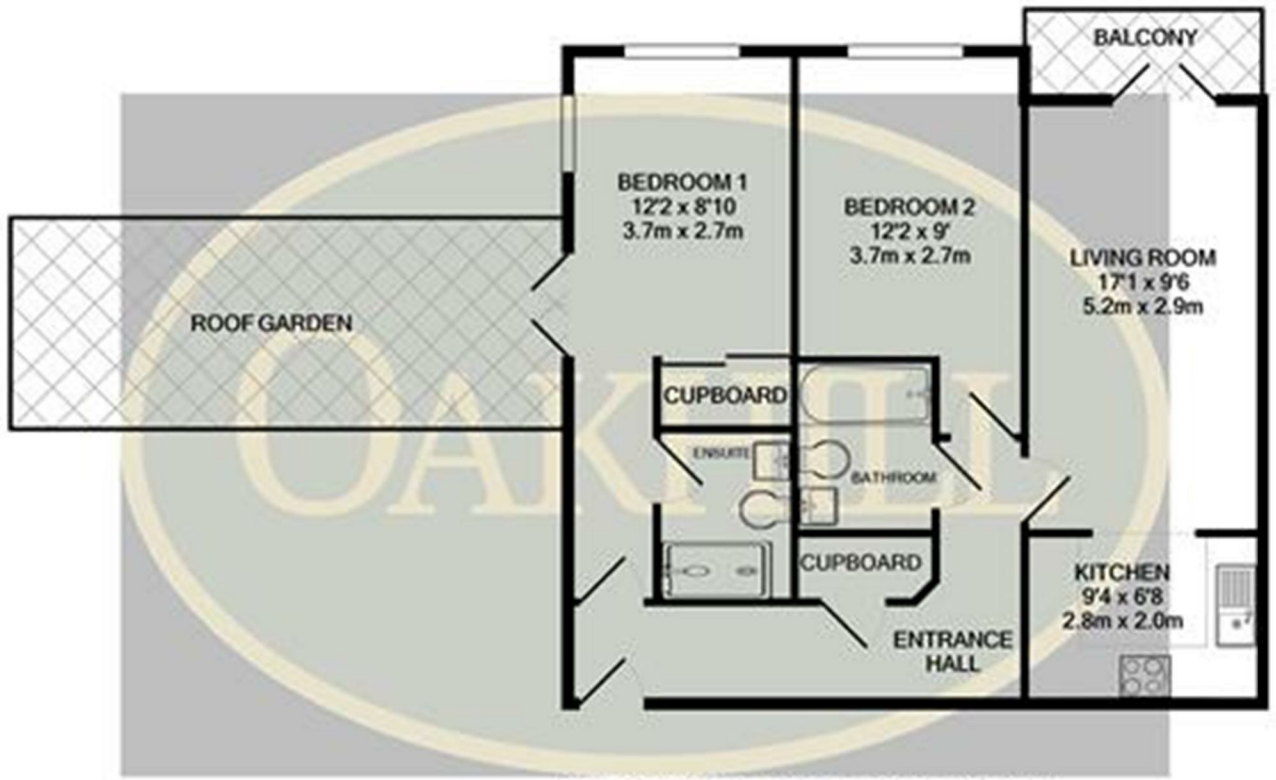

TOTAL APPROX. FLOOR AREA 675 SQ. FT. (62.7 SQ. M.)

Whilst every attempt has been made to ensure the accuracy of the floor plan contained here, measurements of doors, windows, rooms and any other items are approximate and no responsibility is taken for any error, omission, or mis-statement. This plan is for illustrative purposes only and should be used as such by any prospective purchaser. The services, systems and appliances shown have not been tested and no guarantee as to their operability or efficiency can be given
Made with Metropix ©2021

Energy Efficiency Rating		Current	Potential
Very energy efficient - lower running costs			
(92 plus) A			
(81-91) B			
(69-80) C		79	81
(55-68) D			
(39-54) E			
(21-38) F			
(1-20) G			
Not energy efficient - higher running costs			
England & Wales	EU Directive 2002/91/EC		

Environmental Impact (CO ₂) Rating		Current	Potential
Very environmentally friendly - lower CO ₂ emissions			
(92 plus) A			
(81-91) B			
(69-80) C			
(55-68) D			
(39-54) E			
(21-38) F			
(1-20) G			
Not environmentally friendly - higher CO ₂ emissions			
England & Wales	EU Directive 2002/91/EC		

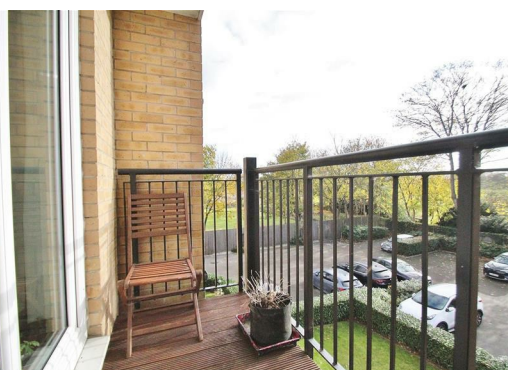

6 South Street, Isleworth, TW7 7BG
Tel: 0208 568 4433
info@oakhillagents.co.uk
www.oakhillagents.co.uk

OAKHILL