



## Langroyd Road, SW17

£950,000

Located on a quiet residential road in the heart of Tooting Bec, an end of terrace three double bedroom family home with potential to extend STPP.

- Tooting Bec
- Victorian
- Desirable Location
- End Of Terrace
- Three Double Bedrooms
- Potential To Extend STPP

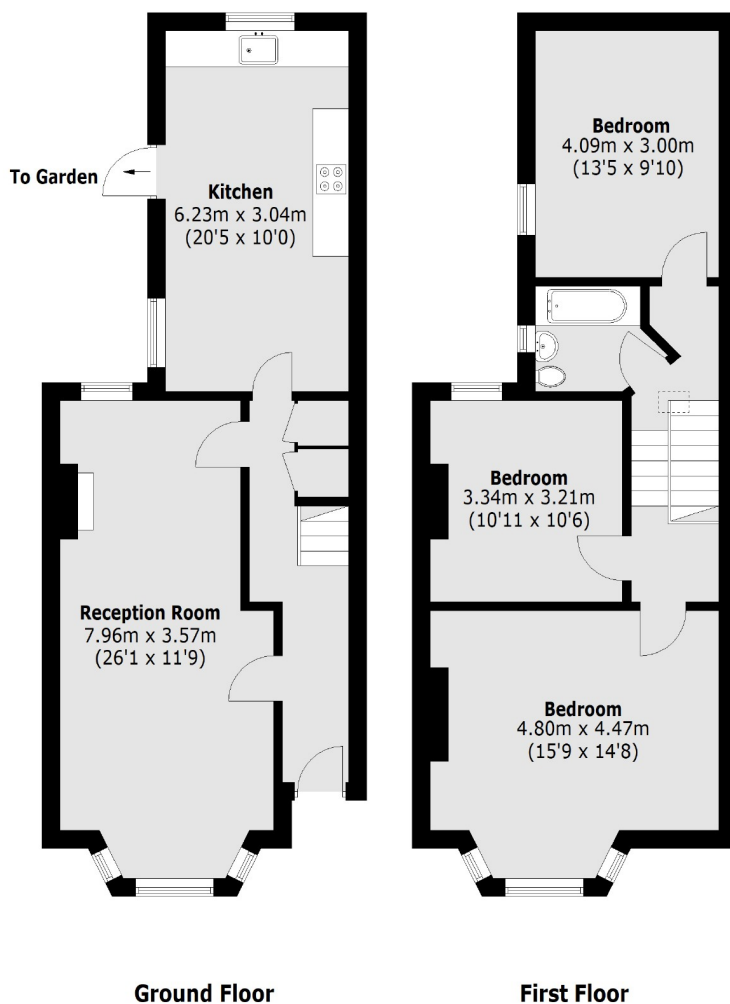

Total area (approx.): 108.8 sq. m (1,171.0 sq. ft)

Jacksons Tooting  
 26 Tooting Bec Road  
 London  
 SW17 8BD  
 020 8767 0522  
[tooting.sales@jacksonsestateagents.com](mailto:tooting.sales@jacksonsestateagents.com)

Energy Rating: D We aim to make our particulars both accurate and reliable. However they are not guaranteed; nor do they form part of an offer or contract. If you require clarification on any points then please contact us, especially if you're traveling some distance to view. Please note that appliances and heating systems have not been tested and therefore no warranties can be given as to their good working order.