



Inglemere Road, CR4

£400,000

Located on a quite residential road in tooting this property is a two double bedroom period conversion with private garden.

- Period Conversion
- Newly Refurbished
- High Spec
- Double Bedroom
- Private Garden
- Close To Transport

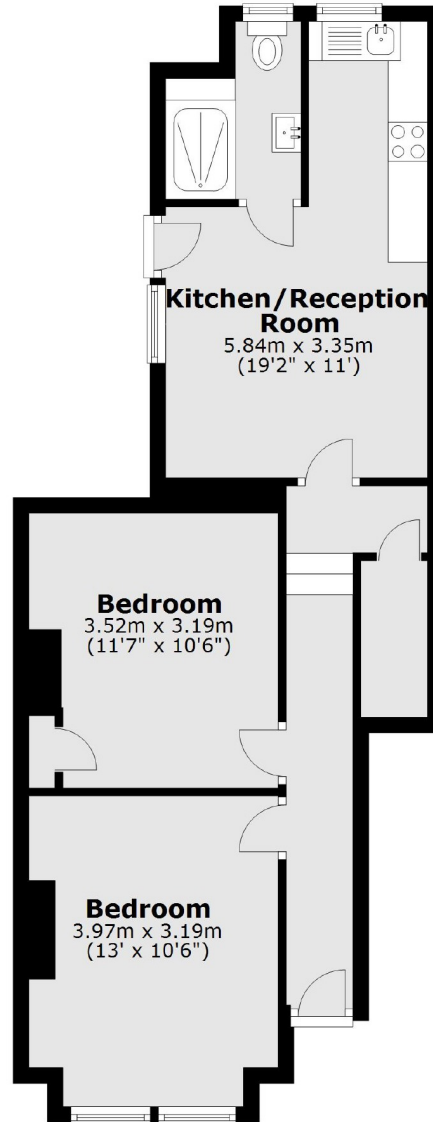
Ground Floor

Total area: approx. 52.7 sq. metres (567.6 sq. feet)

Jacksons Tooting
26 Tooting Bec Road
London
SW17 8BD
020 8767 0522
tooting.sales@jacksonsestateagents.com

Energy Rating: We aim to make our particulars both accurate and reliable. However they are not guaranteed; nor do they form part of an offer or contract. If you require clarification on any points then please contact us, especially if you're traveling some distance to view. Please note that appliances and heating systems have not been tested and therefore no warranties can be given as to their good working order.